



making workspace work®

Nexus Accessory System

Instructions for Assembly



Table of Contents

General Information		
Standard Widths and Heights	3
Tools Required	3
Nexus Frames		
Drill-Template Assembly	4
Nexus Surface Mount Frame Starter	6
Nexus Surface Mount Frame Adder	7
Nexus Rear Mount Frame for Align™	8
Nexus Rear Mount Extended Post for Align™	9
Nexus Shelves and Accessories		
Variable Angle Shelves	10
Adjustable Shelves	11
Shelf Dividers	12
Nexus Tool Rail and Power Options		
Tool Rail	13
Swing Arm Tool Rail	14
Vertical Power Strips	15
Horizontal Power Rails	16
Air Hose Attachment	17
Nexus Lighting		
Overhead Light Fixtures	18
Nexus Plastic Box Rails and Backstops		
Plastic Box Rails	20
Backstops	21
Nexus Overhead Cabinets		
Overhead Cabinets	22
Nexus Articulating Arms		
Articulating Arm Installation	24
Monitor Shelf with Keyboard Holder	25
Optional Mouse Tray	25
Accessory / Tool Tray	26
Document Tray	26
Flat Panel Monitor Bracket	27
Nexus Back Panels and Markerboard/Tackboards		
Louvered Back Panels	28
Pegboard Panels	28
Solid Privacy Panels	28
Reversible Markerboards/Tackboards	28
Nexus Packing Bench Accessories		
Adjustable Shelves Without Lip	29
Variable Angle Shelves Without Lip	30
Vertical Wire Dividers	31
Roll Holders (Extended Mount)	32
Label/Roll Holders (Interior Mount)	33
Nexus Stationary Stands and Mobile Trolley		
Nexus Stationary Stand Frames	34
Nexus Stationary Stand Adder Frames	36
Nexus Mobile Trolley	37
Nexus Flow Racks		
Nexus Flow Rack Frames	38
Nexus Flow Rack Frame with Feet / Worksurface Assembly	39
Nexus Flow Rack Tray	40
Nexus Accessories		
Document Pocket	41
Attached Footrest for Align™	42
Fixed Footrest	43

GENERAL INFORMATION

The following sections provide step-by-step instructions for attaching Starter and Adder sections to your work bench. A *Starter* consists of two uprights and a horizontal rail. The Starter can be used by itself on top of the work bench. The *Adder* is a unit that is attached to the Starter and to itself an infinite number of times. If you want to increase the length of the system, you simply attach an *Adder* to the Starter and continue to attach Adders onto existing Adders to lengthen. Adders consist of one upright and one horizontal rail.

Before Assembling the NEXUS™ Accessory System

Before you begin assembling the Nexus™ Accessories you should read through the assembly instructions to familiarize yourself with order in which the parts are assembled.

It is important to assemble the components in the same sequence as described in this manual.

STANDARD FRAME WIDTHS AND HEIGHTS

The following shows the standard center to center widths and heights for Starter and Adder sets for your reference.

Standard Widths	Standard Heights
24"	30"
30"	48"
36"	
42"	
48"	
60"	

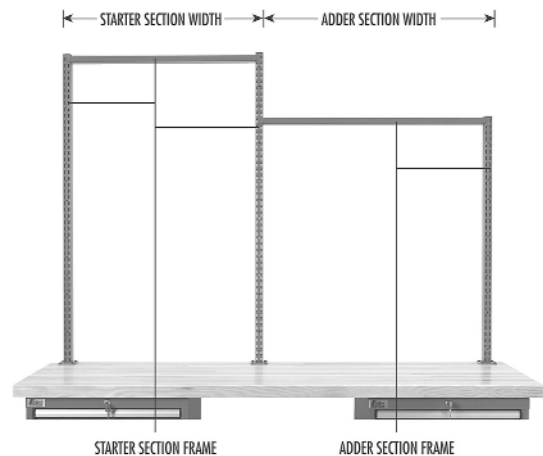

TOOLS REQUIRED FOR ASSEMBLY

Installing the Nexus™ Accessory System requires the following tools:

Sockets or Open End Wrenches

- $\frac{3}{8}$ " drive with 3" to 6" extension
- $\frac{3}{8}$ " Socket or open end wrench
- $\frac{1}{2}$ " Socket or open end wrench
- $\frac{7}{16}$ " Socket or open end wrench
- $\frac{9}{16}$ " Socket or open end wrench (for assembling and attaching optional accessories)

Allen Wrenches

- $\frac{3}{16}$ " Allen Wrench

Screwdrivers

- #2 Phillips Head Screwdriver

Drill Bits (for attaching Starters and/or Adders to Workbench)

- $\frac{13}{32}$ " Drill bit

General Tools

- 2 Steel Mounting Plate Templates (Supplied with frames)
- (2) Clamps
- Electric Hand Drill
- Rubber Mallet
- Measuring Tape
- Safety Glasses
- Pencil



This is the safety alert symbol, to alert you to possible injury hazards

NEXUS FRAMES

DRILL-TEMPLATE ASSEMBLY & DRILLING INSTRUCTIONS

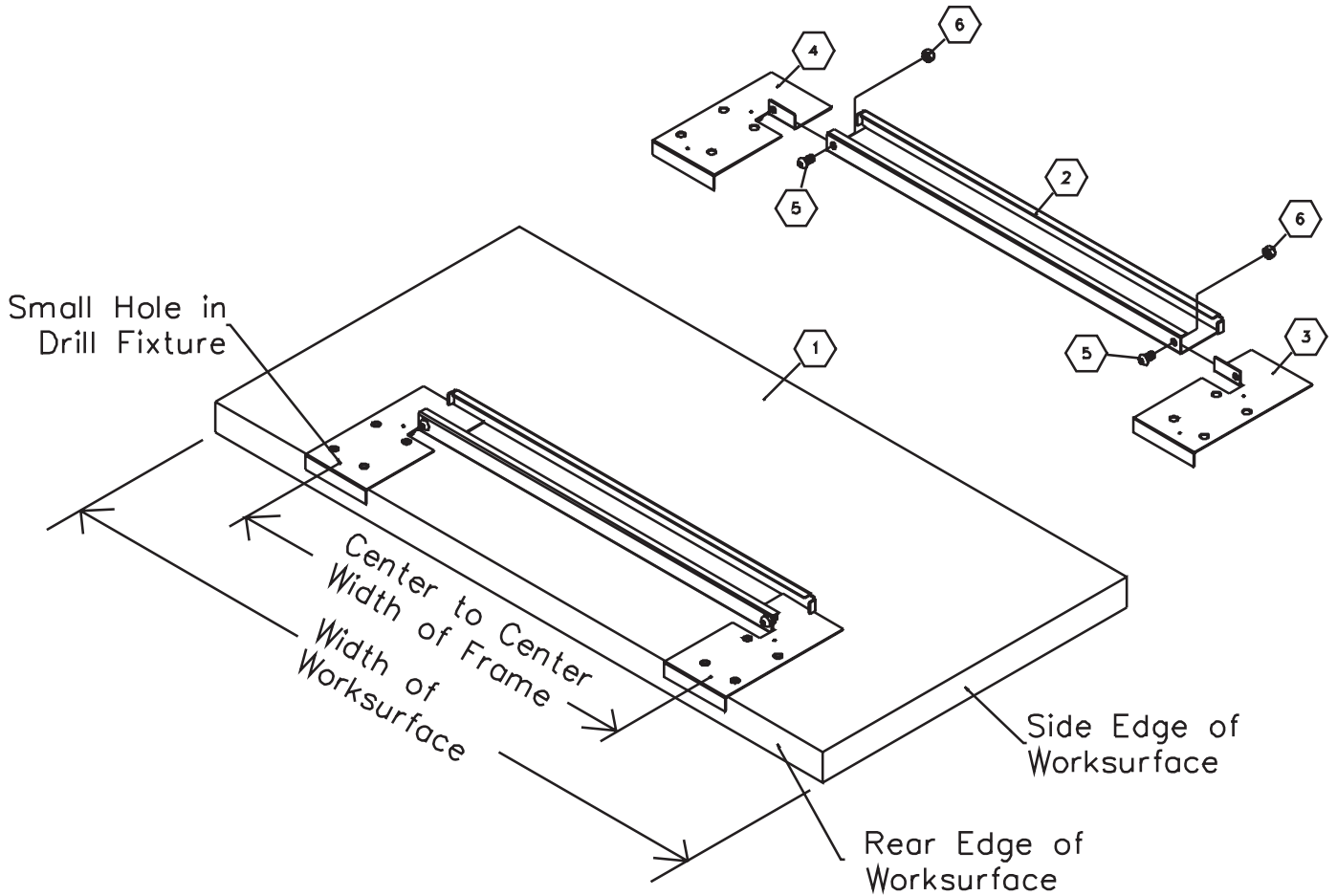

Tools Required:

- Drill
- $\frac{13}{32}$ " Drill Bit
- (2) Clamps
- Safety Glasses
- Tape Measure
- Pencil

Item	Description	Qty.
1	Worksurface	A/R
2	Horizontal Rail	1
3	Drill-Template (Right)	1
4	Drill-Template (Left)	1
5	$\frac{5}{16}$ -18 x $\frac{5}{8}$ " Button Head Cap Screw	2
6	$\frac{5}{16}$ -18 Hex Nut	2

DRILL-TEMPLATE ASSEMBLY & DRILLING INSTRUCTIONS

Note: Drill worksurface before attaching to legs or pedestal cabinets.

Drill-Template Assembly Step:

1. Insert left and right drill-templates (item 3 & 4) into each end of horizontal rail (item 2).
2. Bolt templates to horizontal rail using (2) $\frac{5}{16}$ -18 x $\frac{5}{8}$ " button head cap screws (item 5) and (2) $\frac{5}{16}$ -18 hex nuts (item 6).

Centering Drill-Template & Drilling Top:

Center of posts must be mounted 3" or more from each end of worksurface.

1. Determine desired location of frames, noting that the posts must be mounted at least 3" from end of worksurface.
2. Place drill-template on worksurface against edge to be drilled. (Make sure bent flange of template is flush against rear edge of worksurface).
3. Clamp drill-template to top.



Make sure drill-template is clamped and secure to top before drilling.

4. Drill holes completely through worksurface using $\frac{13}{32}$ " Drill Bit and hole pattern in templates.

Drilling Adders:

1. Place drill-template on worksurface against edge to be drilled. (Make sure bent flange of template is flush against rear edge of worksurface).
2. Align holes on one end of template with drilled starter holes.
3. Clamp drill-template to worksurface.
4. Drill holes completely through top using hole pattern in template.

SURFACE MOUNT FRAME STARTER INSTALLATION

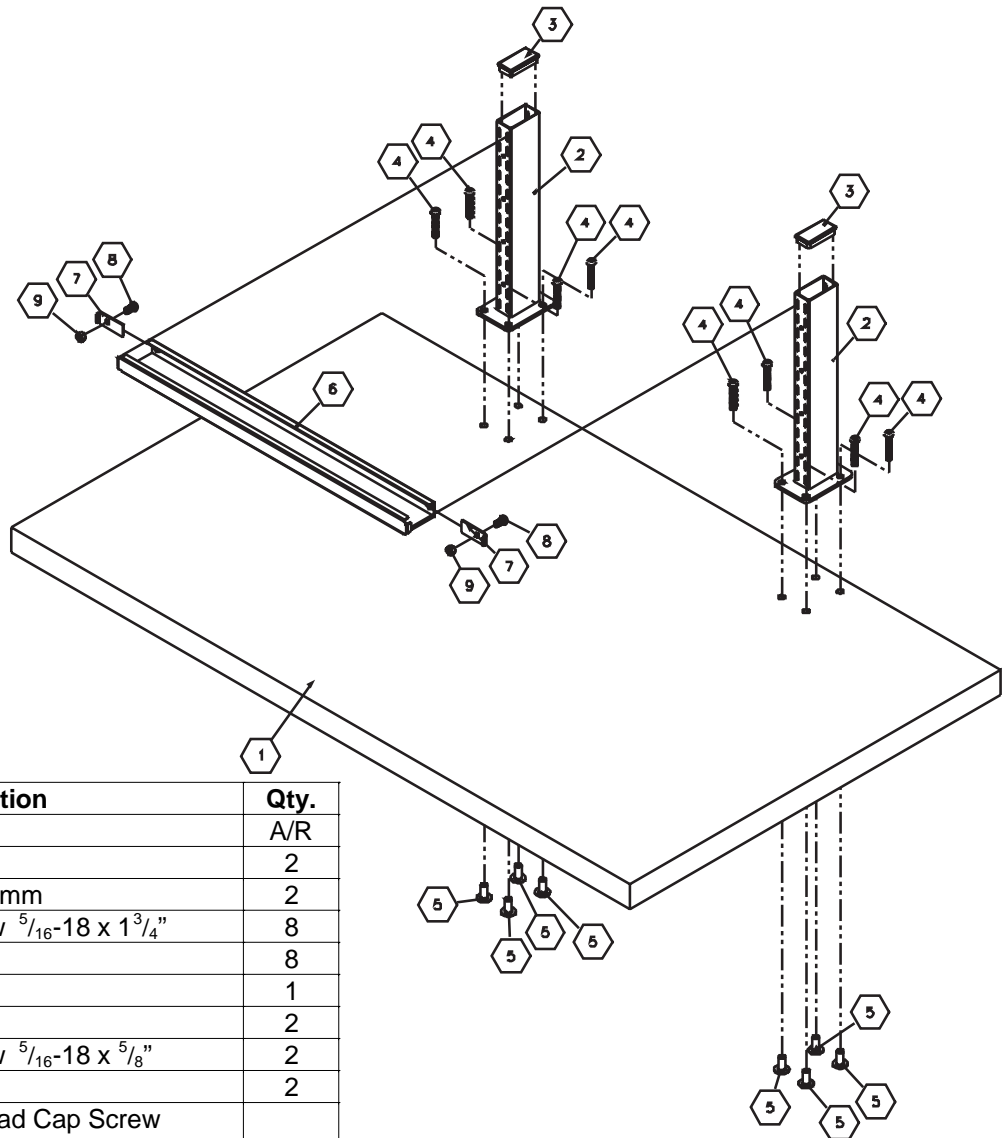

Tools Required:

- $\frac{3}{16}$ " Hex Key
- $\frac{1}{2}$ " Wrench
- Hammer

Item	Description	Qty.
1	Worksurface Top	A/R
2	Post	2
3	Black Plug 30 mm x 60 mm	2
*4	Button Head Cap Screw $\frac{5}{16}$ -18 x $1\frac{3}{4}$ "	8
5	T-Nut $\frac{5}{16}$ -18 x $\frac{7}{8}$ "	8
6	Horizontal Rail	1
7	Retainer Clip	2
8	Button Head Cap Screw $\frac{5}{16}$ -18 x $\frac{5}{8}$ "	2
9	Hex Nut $\frac{5}{16}$ -18	2
*	$\frac{5}{16}$ -18 x $1\frac{3}{4}$ " Button Head Cap Screw would be a substitute for work surfaces 1" thick or less	

Note: For new installation follow steps 1 and 2 before attaching worksurface to legs or pedestal cabinets.

Step:

1. Drill post mounting holes through worksurface top (item 1) following the Drill-Template Assembly & Drilling Instructions, pages 4-5.
2. Hammer (8) $\frac{5}{16}$ -18 x $\frac{7}{8}$ " t-nuts (item 5) into holes in bottom of worksurface.
3. Insert (2) black plugs (item 3) into the top of each post (item 2).
4. Align holes on base plates of posts with holes on top of worksurface.
5. Bolt posts to top using (8) $\frac{5}{16}$ -18 x $1\frac{3}{4}$ " (or $\frac{3}{4}$ " depending on top thickness) button head cap screws (item 4).
6. Insert tabs of horizontal rail (item 6) into the top inner slots of the posts.
7. Insert (2) retainer clips (item 7) into end of horizontal rail and into inner slots on post.
8. Bolt retainer clips to horizontal rail using (2) $\frac{5}{16}$ -18 x $\frac{5}{8}$ " button head cap screws (item 8) and (2) $\frac{5}{16}$ -18 hex nuts (item 9).



Make sure frame system is properly installed before adding accessories and/or weight.

SURFACE MOUNT FRAME ADDER INSTALLATION

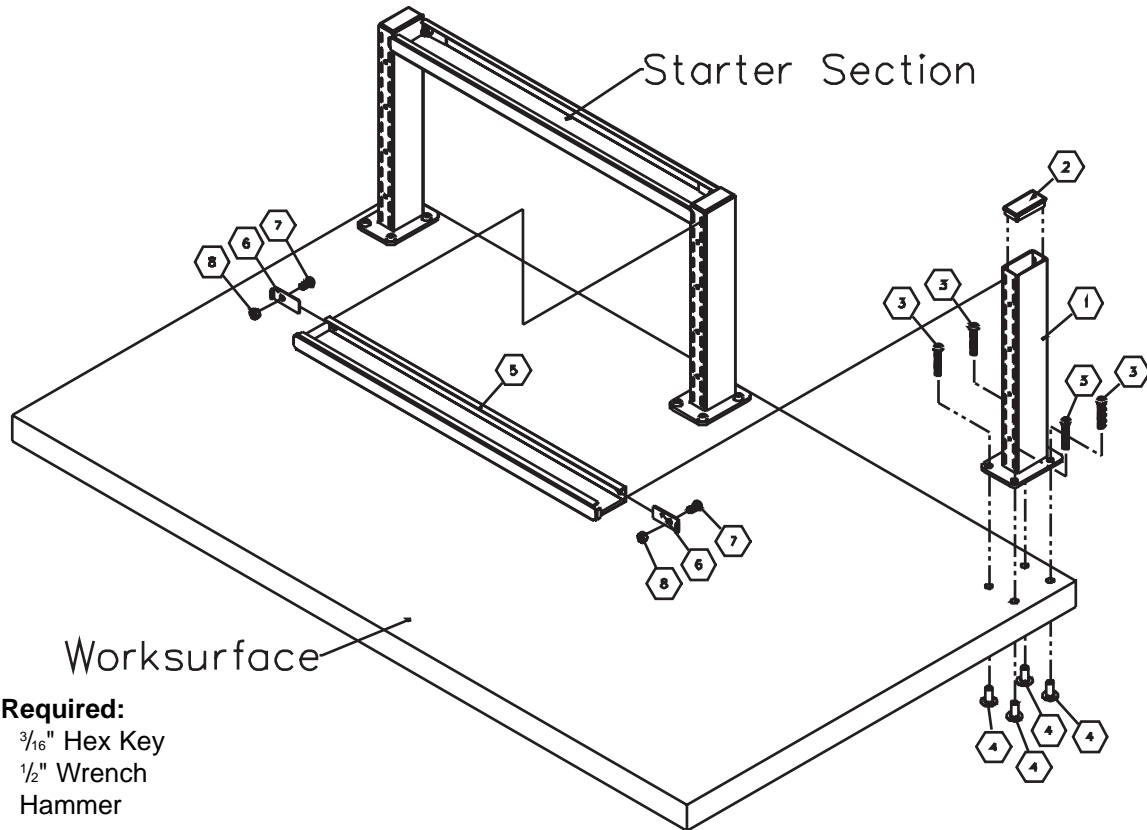

Tools Required:

- $\frac{3}{16}$ " Hex Key
- $\frac{1}{2}$ " Wrench
- Hammer

Item	Description	Qty.
1	Post	1
2	Black Plug 30 mm x 60 mm	1
*3	Button Head Cap Screw $\frac{5}{16}$ -18 x $1\frac{3}{4}$ "	4
4	T-Nut $\frac{5}{16}$ -18 x $\frac{7}{8}$ "	4
5	Horizontal Rail	1
6	Retainer Clip	2
7	Button Head Cap Screw $\frac{5}{16}$ -18 x $\frac{5}{8}$ "	2
8	Hex Nut $\frac{5}{16}$ -18	2
*	$\frac{5}{16}$ -18 x $\frac{3}{4}$ " Button Head Cap Screw Would be a substitute for tops 1" thick or less	

Note: For new installation follow steps 1 and 2 before attaching worksurface to legs or pedestal cabinets.

Step:

1. Drill holes for adder post (item 1) following Drill Template Assembly & Drilling Instructions, pages 4-5. (This can be done for an infinite number of adders).
2. Hammer (4) $\frac{5}{16}$ -18 x $\frac{7}{8}$ " t-nuts (item 4) into bottom of holes in worksurface.
3. Insert a black plug (item 2) into the top of post.
4. Align holes on base plate of post with holes on top of worksurface.
5. Bolt post to top using (4) $\frac{5}{16}$ -18 x $1\frac{3}{4}$ " button head cap screws (item 3).
6. Insert tabs of horizontal rail (item 5) into the top inner slots of each post.
7. Insert (2) retainer clips (item 6) into end of horizontal rail and into inner slots on post.
8. Bolt retainer clips to horizontal rail using (2) $\frac{5}{16}$ -18 x $\frac{5}{8}$ " button head cap screws (item 7) and (2) $\frac{5}{16}$ -18 hex nuts (item 8).

REAR MOUNT FRAME INSTALLATION

For use with Align bases only

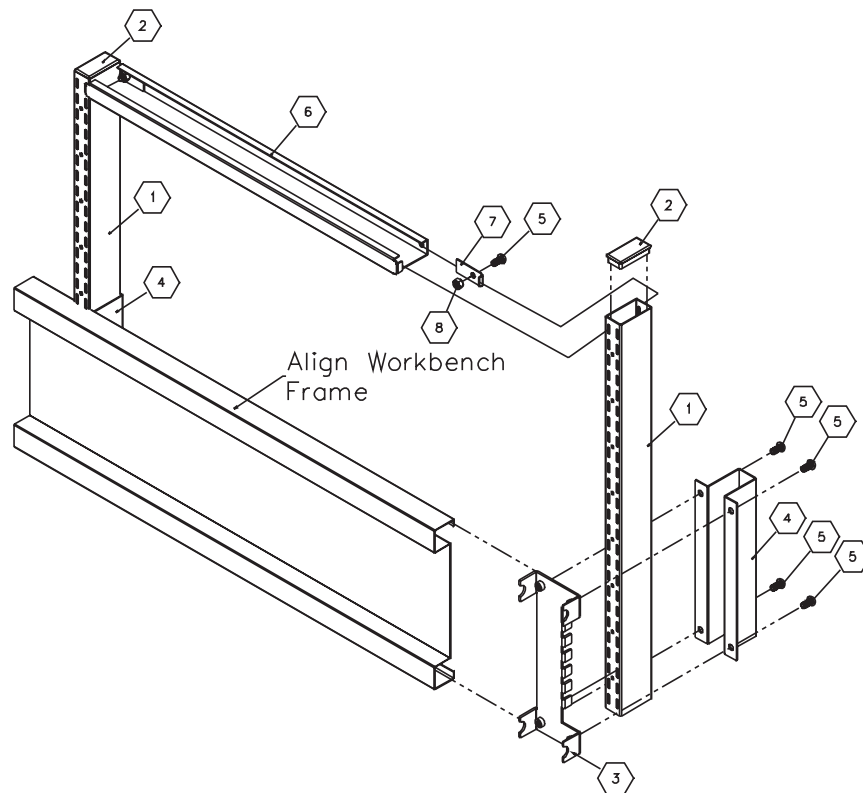

Tools Required:

- $\frac{3}{16}$ " Hex Key
- $\frac{1}{2}$ " Wrench

Item	Description	Qty.
1	Post	2
2	Black Plug 30 mm x 60 mm	2
3	Rear Mount Post Connector	2
4	Rear Mount Post Clamp	2
5	Button Head Cap Screw $\frac{5}{16}$ -18 x $\frac{5}{8}$ "	10
6	Horizontal Rail	1
7	Retainer Clip	2
8	Hex Nut $\frac{5}{16}$ -18	2

Step:

1. Insert (2) black plugs (item 2) into the top of each post (item 1).
2. Slide (2) rear mount post connectors (item 3) one into each end of Align workbench frame with small tabs facing outwards as shown.
3. Insert small tabs on rear mount post connectors into bottom outer slots of posts or at height desired.
4. Slide (2) rear mount post clamps (item 4) over posts and align holes with post connectors.
5. Bolt post clamps to post connectors using (8) $\frac{5}{16}$ -18 x $\frac{5}{8}$ " button head cap screws (item 5).
6. Insert tabs of horizontal rail (item 6) into the top inner slots of the posts.
7. Insert (2) retainer clips (item 7) into end of horizontal rail and into inner slots on post.
8. Bolt retainer clips to horizontal rail using (2) $\frac{5}{16}$ -18 x $\frac{5}{8}$ " button head cap screws and (2) $\frac{5}{16}$ -18 hex nuts (item 8).



Make sure frame system is properly assembled to Align work bench before adding accessories or weight.

Rear Mount Installation – Extended Post For Extending Nexus Frames on Align Benches

Tools Required:

- 3/16" Hex Key
- 1/2" Wrench

Item	Description	Qty.
1	Post	2
2	Black Plug 30 mm x 60 mm	2
3	Post Connector – Extended Post	2
4	Spacer –Extended Post	2
5	Clamp- Extended Post	2
6	Button Head Cap Screw 5/16-18 x 5/8"	12
7	Cross-member	1
8	Retainer Clip	2
9	Hex Nut 5/16-18	4

Step:

1. Insert the black plug (item 2) into the top of the Post
2. Remove the Top Screw from the Panel
3. Slide Post Connector (item 3) into the Panel
4. Fasten the Connector in place by replacing the Top Screw. Use a BHC Screw and Nut (items 6 & 9) to fasten the bottom.
5. Place the Spacer (item 4) in place on the tabs of the Connector
6. Install the Post on the Connector at the desired height.
The Connector tabs go into the outer slots on the Post.
7. Slide the Clamp (item 5) over posts.
8. Bolt the Clamp to the Connector using (4) BHC Screws (item 6) and (2) Nuts (item 9).
9. Repeat the above steps to mount the opposite Post.
10. Insert the tabs of Cross-member (item 7) into the top inner slots of the Posts.
11. Insert the Retainer Clips (item 8) into ends of Cross-member and into inner slots on Post.
12. Bolt Retainer Clips (item 8) to the Cross-member using BHC Screws and Nuts (items 6 & 9).

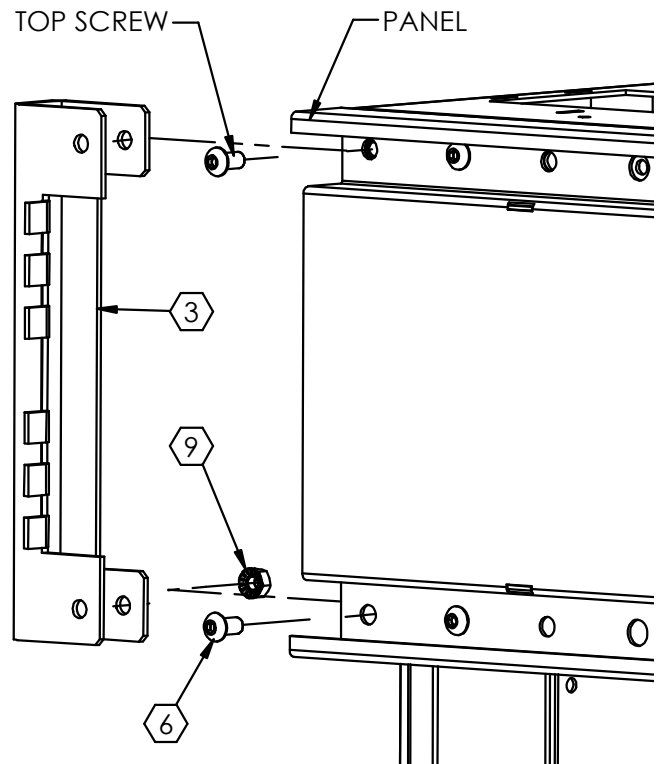

CAUTION: Make sure frame system is properly installed to Align work bench before adding accessories or weight.

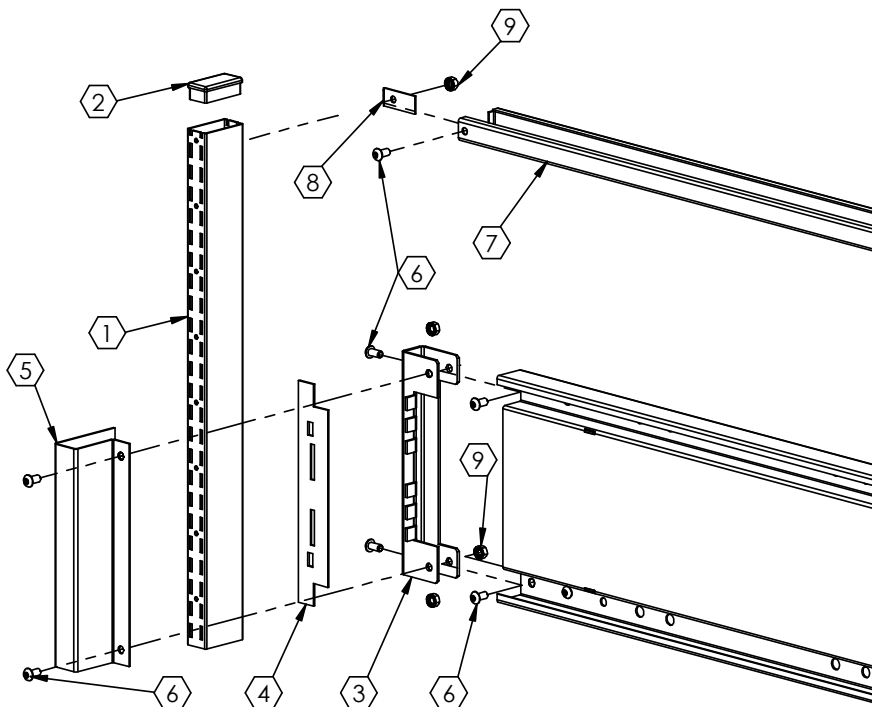

NEXUS SHELVES AND ACCESSORIES

VARIABLE ANGLE SHELF ASSEMBLY & INSTALLATION

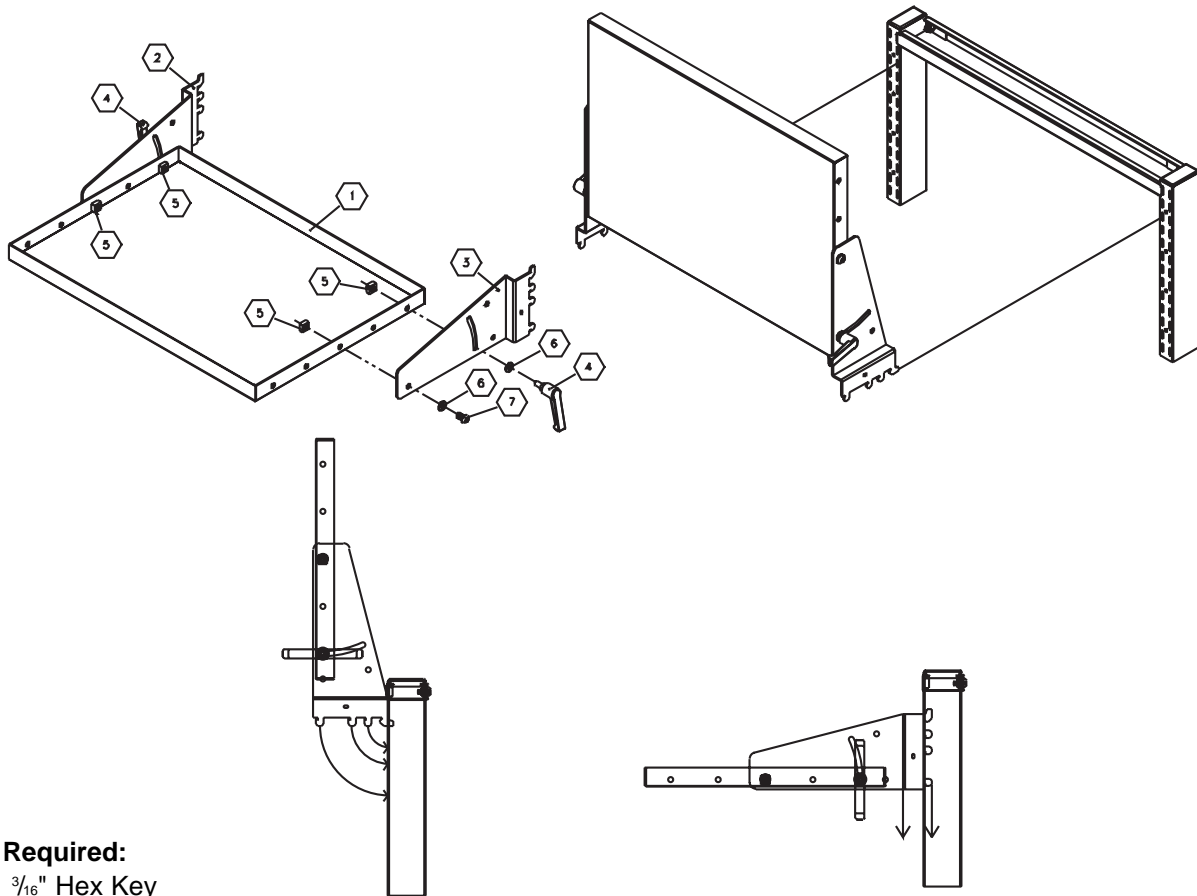

Tools Required:

- $\frac{3}{16}$ " Hex Key
- $\frac{9}{16}$ " Wrench

Item	Description	Qty.
1	Variable Angle Shelf	1
2	Mounting Bracket (Left)	1
3	Mounting Bracket (Right)	1
4	Adjustable Lever $\frac{5}{16}$ -18 x $\frac{5}{8}$	2
5	Square Nut $\frac{5}{16}$ -18	4
6	Flat Washer $\frac{1}{4}$	4
7	Button Head Cap Screw $\frac{5}{16}$ -18 x $\frac{5}{8}$	2

Assembly Step:

1. Orient left and right mounting brackets (items 2 & 3) and shelf (item 1) as shown.
2. Bolt brackets to shelf, where desired, using (2) $\frac{5}{16}$ -18 x $\frac{5}{8}$ adjustable levers (item 4), (4) $\frac{5}{16}$ -18 UNC square nuts (item 5), (4) $\frac{1}{4}$ flat washers (item 6) and (2) $\frac{5}{16}$ -18 x $\frac{5}{8}$ button head cap screws (item 7).

Installation Step:

1. Insert top tabs of mounting brackets into inner slots on posts at height desired.
2. Rotate down inserting bottom tabs fully in to slots on posts.
3. Press down to secure in place.



Make sure shelf is properly installed before adding weight.

ADJUSTABLE SHELF ASSEMBLY

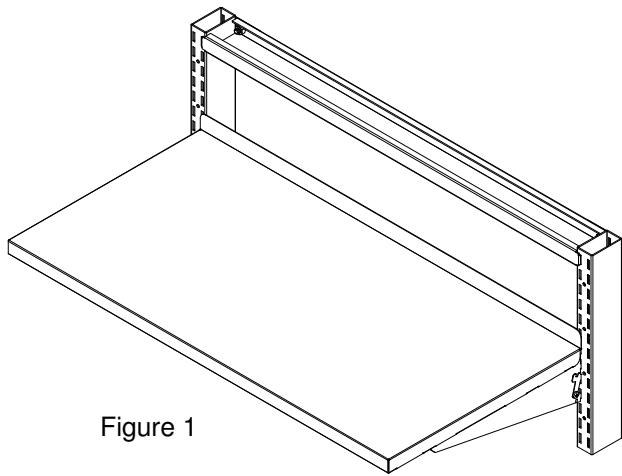

Figure 1

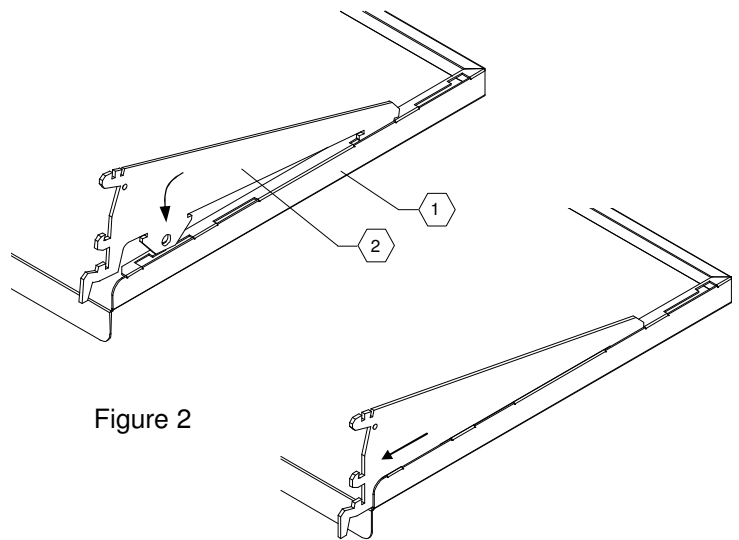

Figure 2

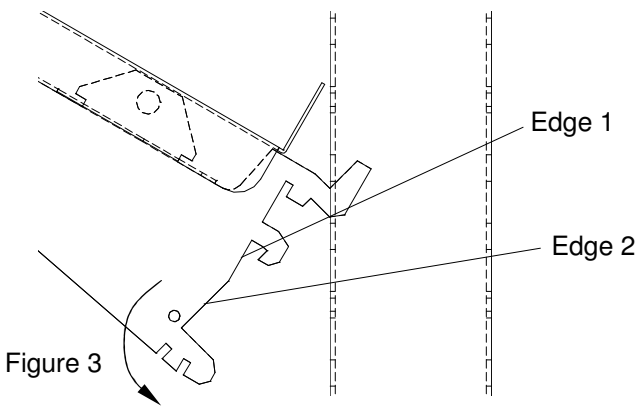

Figure 3

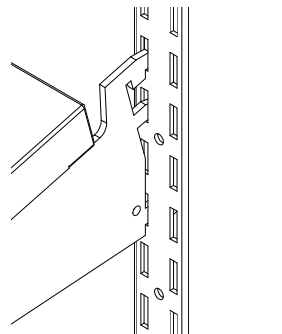

Figure 4

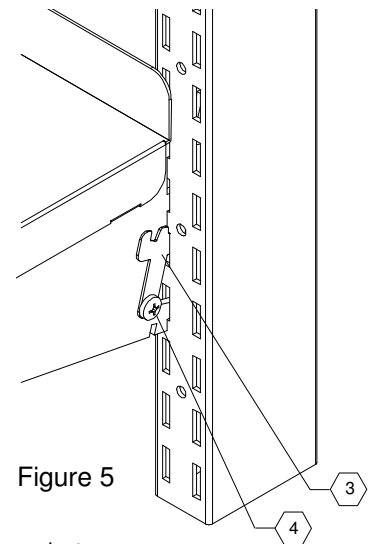

Figure 5

Tools Required:

- Phillips head screwdriver

Item	Description	Qty.
1	Adjustable Shelf	1
2	Adjustable Shelf Mounting Bracket	2
3	Security clip	2
4	Pan head taptite screw 10-32 x 1/4"	2

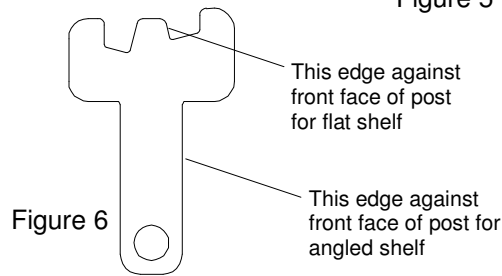

Figure 6

Step:

1. Insert mounting brackets (item 2) into slots on bottom of adjustable shelf (item 1) as shown in Figure 2. The lip can be positioned to the front or rear as required.
2. Insert top tabs of mounting brackets into inner slots on posts at height desired and rotate downwards until either edge 1 (for flat shelf) or edge 2 (for angled shelf) touches the front of the post, Figure 3. Figure 4 shows an angled shelf and Figures 1 and 5 show a flat shelf.
3. Press down to engage all three bracket tabs into the slots on the post and to secure in place.



MAKE SURE SHELF IS PROPERLY INSTALLED TO POST BEFORE INSTALLING SECURITY CLIPS AND BEFORE ADDING WEIGHT.

4. Insert forked end of security clip (item 3) into post, as shown in Figure 5, and rotate to align hole with hole in mounting bracket. Clips can be installed on either side of bracket. Figure 6 shows proper orientation of clip.
5. Secure clips to mounting bracket using (2) 10-32x1/4" pan head taptite screws (item 4), Figure 5

SHELF DIVIDER INSTALLATION

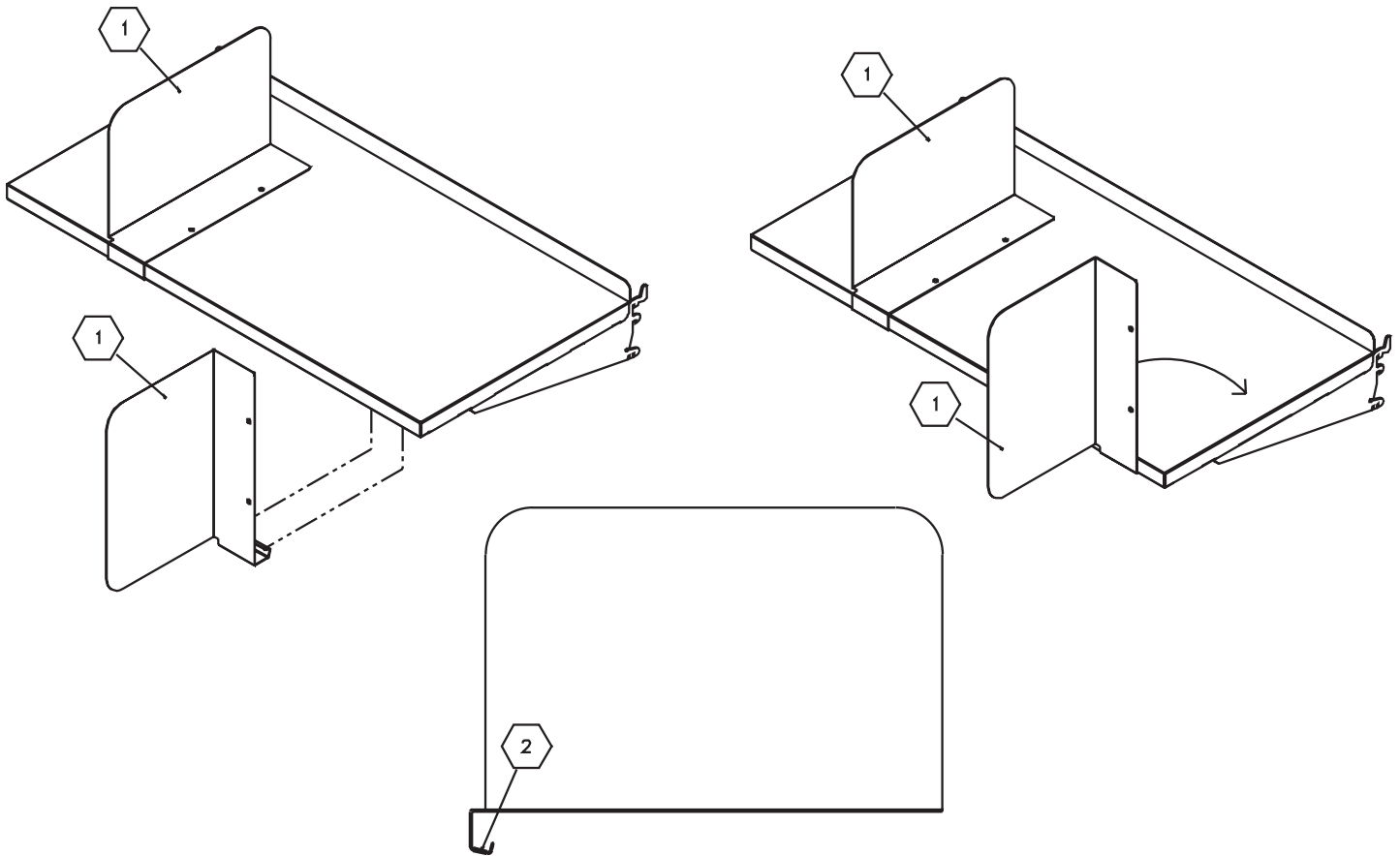

Tools Required:

- No tools required

Item	Description	Qty.
1	Shelf Divider	A/R
2*	Magnetic Strip w/Adhesive Back 2"	A/R

* Used for old style FlexWorks retrofit only.

Divider Installation:

1. Tilt divider perpendicular to front of shelf.
2. Engage the flange of the divider under the lip of the shelf.
3. Rotate divider onto top of shelf.
4. Slide divider to position on shelf.
5. Reverse installation process to remove dividers.

For Old Style FlexWorks Retrofit Only:

1. Peel off adhesive strip covering from magnetic strip (item 2).
2. Adhere adhesive side of magnet to angled lip on front flange of divider (item 1).
3. Repeat for all dividers.

NEXUS TOOL RAIL AND POWER OPTIONS

TOOL RAIL ASSEMBLY

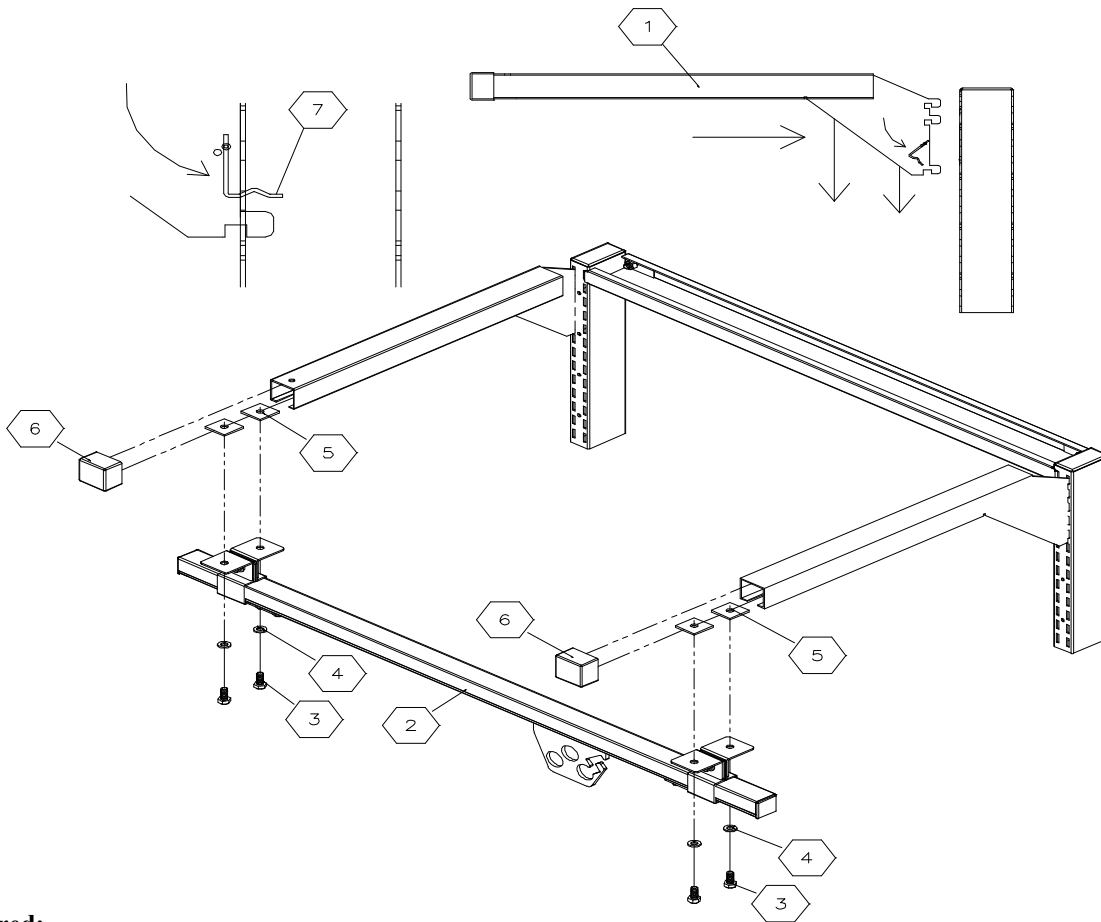

Tools Required:

- 1/2" Wrench

Item	Description	Qty.
1	Light/Tool Rail Support Brackets (left & right)	1 pair
2*	Tool Rail	1
3*	Hex Head Bolts 5/16-18 x 1/2	4
4*	Split Lock Washer 5/16	4
5*	Bracket Mounting Plates (Threaded 5/16-18)	4
6	Black Plastic End Cap 1 1/2" Square	2
7	Wire Security Clip	2

* = These items are pre-assembled and part of the tool rail.

Step:

1. Insert top tabs of left and right light/tool rail support brackets (item 1) into the top inner slots of each post.
2. Rotate down inserting all tabs into inner slots on posts.
3. Press down to secure in place.
4. Insert wire clip (7) into top inside mounting hole on bracket, rotate until clip snaps/engages slot on post
5. Loosen all (4) 5/16-18 x 1/2 hex head bolts (item 3*) on tool rail (item 2*).
6. Slide bracket mounting plates (item 5*) into tool rail support brackets. (Two people are recommended to perform this step).
7. Locate over work area and tighten all (4) bolts.
8. Cover ends of light/tool rail support brackets using (2) 1 1/2" black plastic end caps (item 6).

SWING ARM TOOL RAIL ASSEMBLY

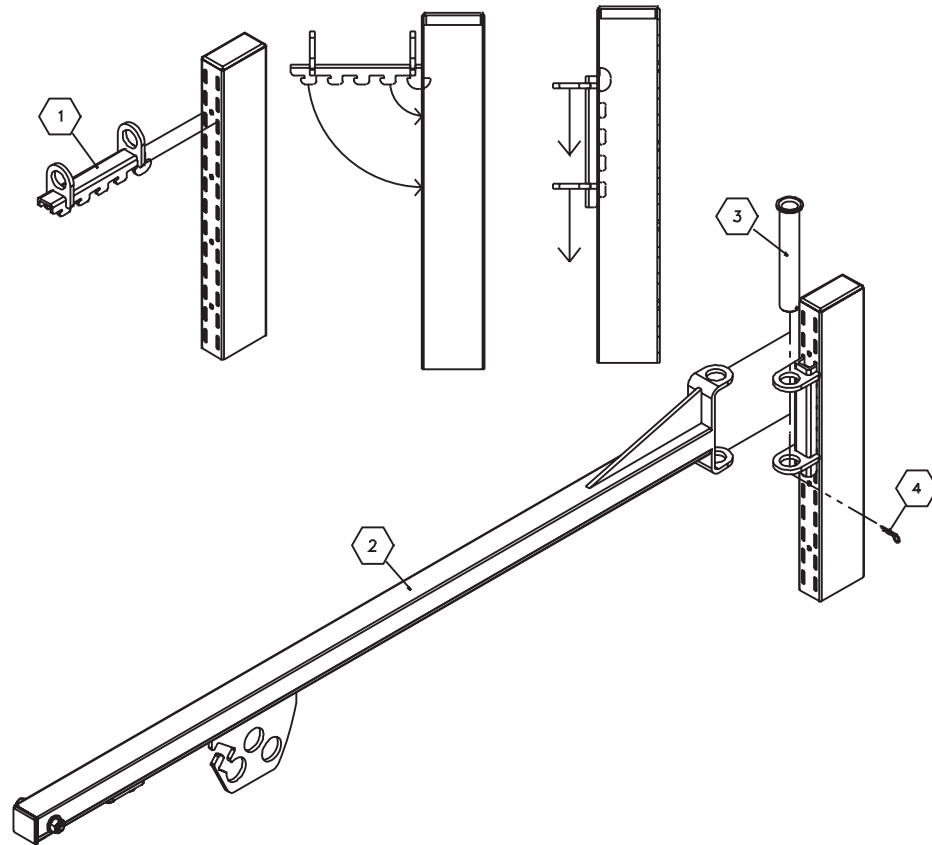

Tools Required:

- Hammer (regular or rubber)
- Block of wood (to protect bracket from hammer)

Item	Description	Qty.
1	Mounting Bracket	1
2	Swing Arm Tool Rail Assembly	1
3	Mounting Pin	1
4	Cotter Hairpin $\phi 1.4 \times 25$	1

Step:

1. Insert top tabs of mounting bracket (item 1) into slots on post at height desired.
2. Rotate mounting bracket down inserting all tabs into slots on post.
3. Hammer mounting bracket down to secure in place. (Use soft mallet or block of wood to protect bracket).
4. Align holes in swing arm tool rail assembly (item 2) on top of holes of mounting bracket.
5. Insert mounting pin (item 3) through holes in swing arm tool rail and mounting bracket.
6. Insert cotter hairpin (item 4) into hole in mounting pin.



Make sure swing arm tool rail is properly installed before adding weight.

VERTICAL POWER STRIP INSTALLATION

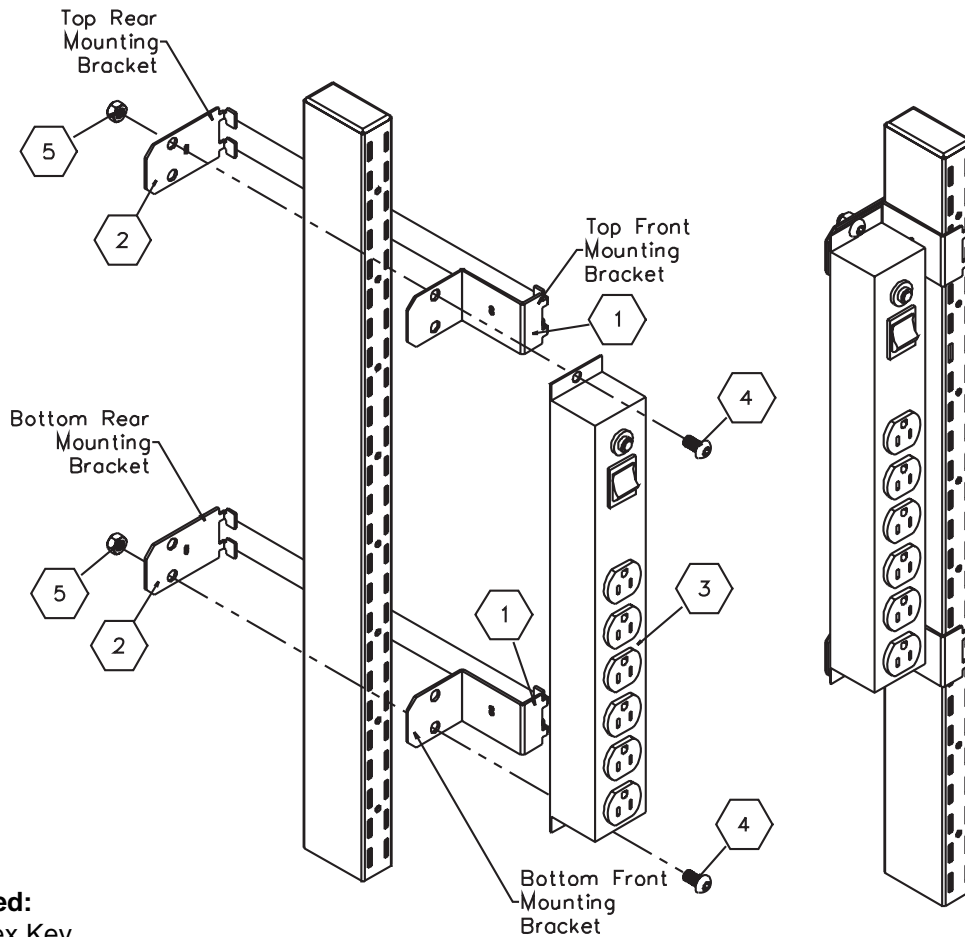

Tools Required:

- $\frac{3}{16}$ " Hex Key
- $\frac{1}{2}$ " Wrench

Item	Description	Qty
1	Front Mounting Bracket (Top & Bottom)	2
2	Rear Mounting Bracket (Top & Bottom)	2
3	Power Receptacle	1
4	Button Head Cap Screw $\frac{5}{16}$ -18 x $\frac{5}{8}$	2
5	Hex Nut $\frac{5}{16}$ -18	2

Step:

1. Insert tabs of (1) top front and (1) top rear mounting bracket (items 1 & 2) into slots of post at height desired. Press down to secure in place.
2. Loosely Bolt power receptacle (item 3) through top hole in brackets using (1) $\frac{5}{16}$ -18 x $\frac{5}{8}$ button head cap screw (item 4) and (1) $\frac{5}{16}$ -18 hex nut (item 5).
3. Insert tabs of (1) bottom front and (1) bottom rear mounting bracket into slots of post at height that aligns bottom hole in brackets with hole in receptacle when mounting brackets are pushed up. (Swing receptacle out of the way if needed).
4. Bolt power receptacle through bottom hole in brackets using (1) $\frac{5}{16}$ -18 x $\frac{5}{8}$ button head cap screw (item 4) and (1) $\frac{5}{16}$ -18 hex nut (item 5).
5. Fully tighten screws. Making sure tabs are fully engaged in slots, top brackets are fully seated on the bottom of the slot, and the bottom brackets are fully seated on the top of the slot.

HORIZONTAL POWER RAIL INSTALLATION

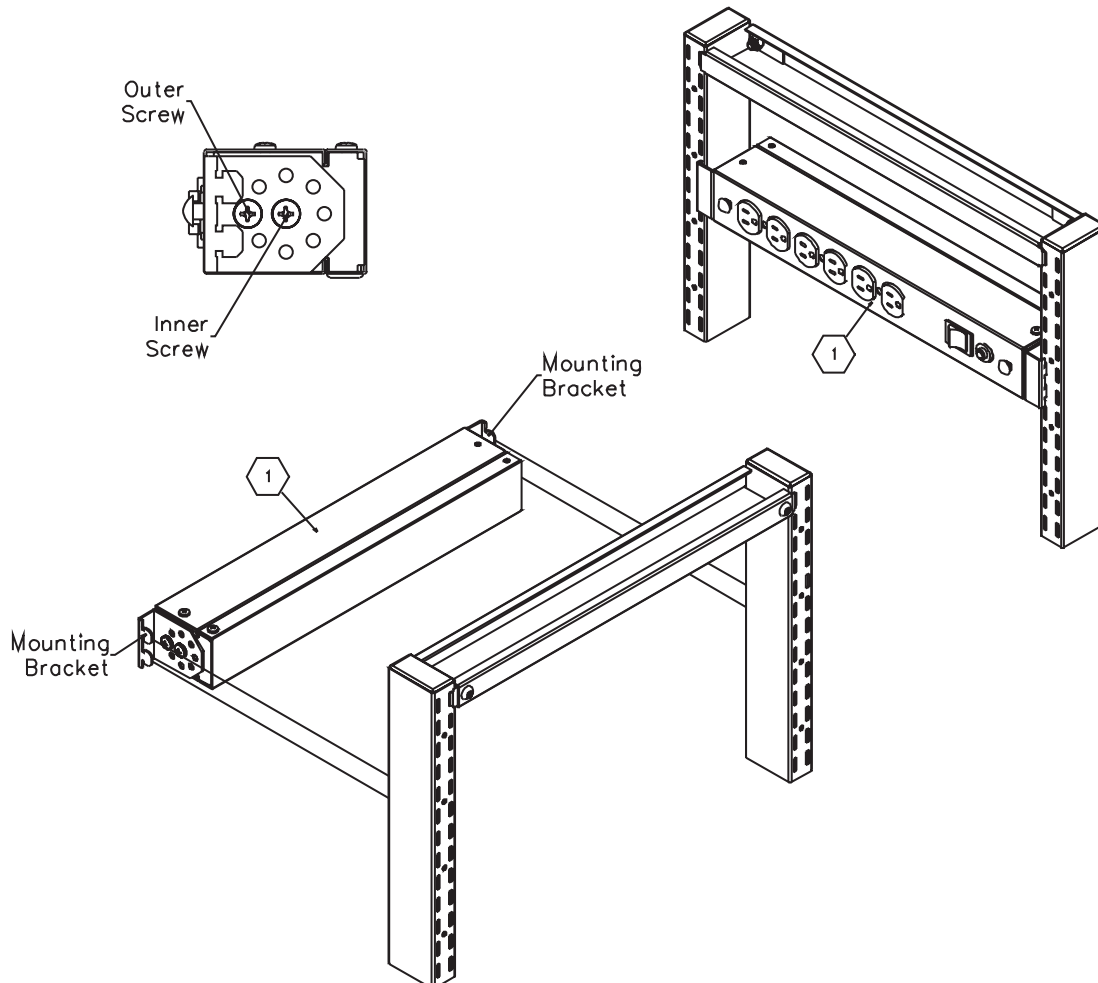

Tools Required:

- Phillips head screwdriver

Item	Description	Qty.
1	Horizontal Power Rail Assembly	1

To Angle Power Rail:

1. Remove outer screws from mounting brackets on each end of horizontal power rail assembly (item 1).
2. Loosen inner screws from mounting brackets on each end of horizontal power rail assembly.
3. Rotate mounting brackets to desired angle.
4. Replace screws and fully tighten.

Power Rail Installation:

1. Insert mounting bracket tabs into inner slots of posts at height desired.
2. Press down to secure in place.

AIR HOSE ATTACHMENT

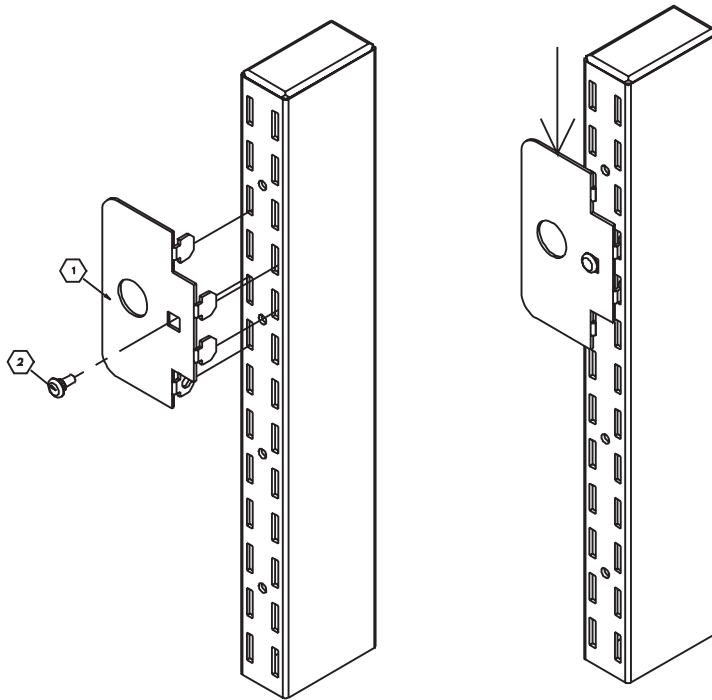

Tools Required:

No tools necessary

Item	Description	Qty.
1	Air Chuck Bracket	1
2	Plastic Pin	1

Step:

1. Insert tabs on air chuck bracket (item 1) into slots of post at height desired. Press down to secure in place.
2. Insert plastic pin (item 2) through square hole in bracket and into slot on post.

Make sure bracket is secure before installing air chuck.

NEXUS LIGHTING ACCESSORIES

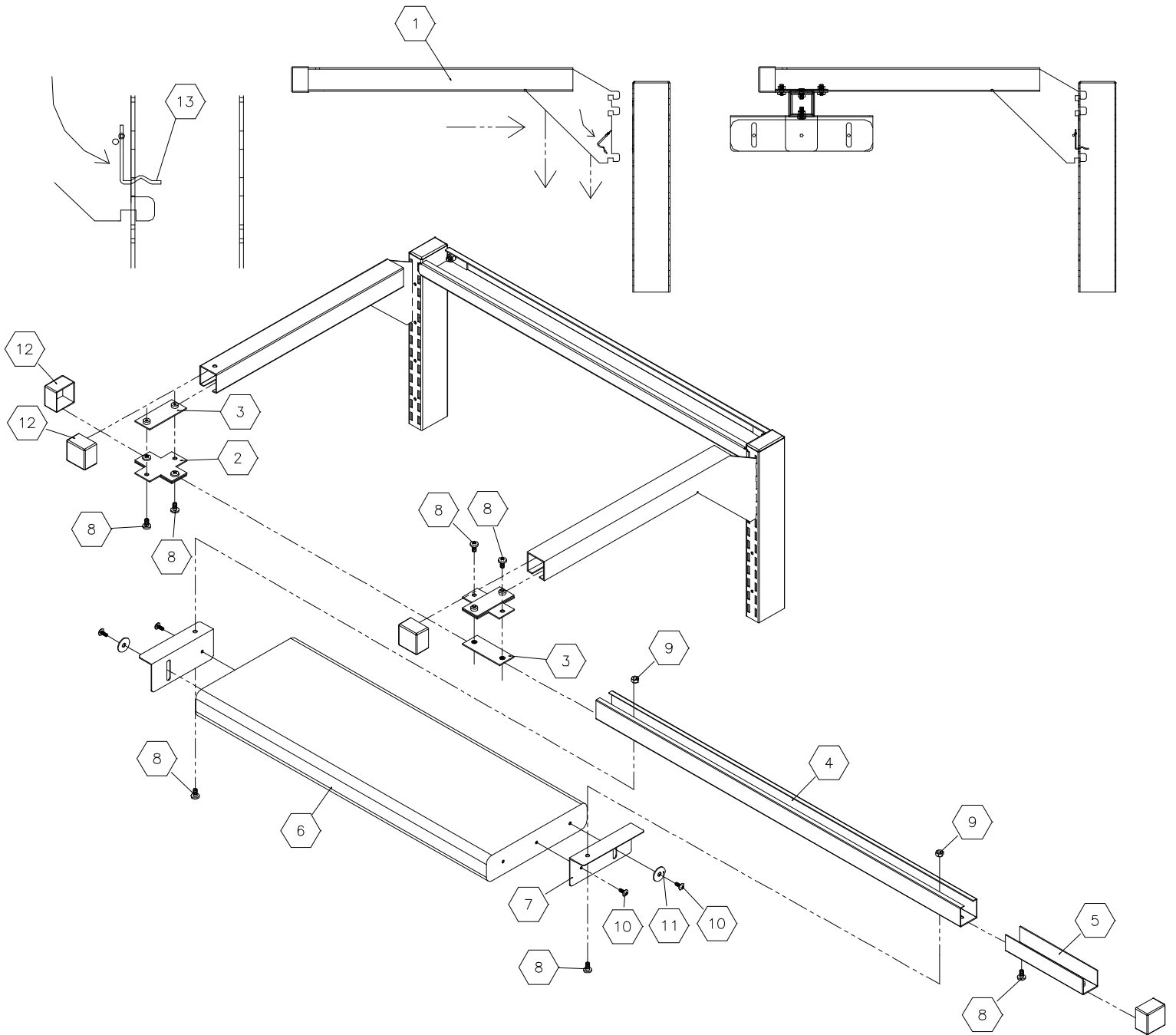

OVERHEAD LIGHT ASSEMBLY

Tools Required:

- Phillips Screwdriver
- 7/16" Wrench

Item	Description	Qty.
1	Light/Tool Rail Support Brackets (left & right)	1 pair
2	Rail Connecting Plate	2
3	Clamping Plate	4
4	Light Support Rail	1
5*	Light Support Connector Rail	1*
6	Overhead Light	1
7	Light Mounting Bracket	2
8	Phillips Truss Head Screw 1/4-20 x 1/2	10-14
9	Hex Nut 1/4-20	2
10	Phillips Truss Head Screw #10-24 x 1/2	4
11	Flat Washer 1/4	2
12	Black Plastic End Cap 1 1/2" Square	4
13	Wire Security Clip	2

* = **Note:** Required for light support rails over 72" wide.

Step:

1. Insert tabs of left and right light/tool rail support brackets (item 1) into the top inner slots of each post.
2. Press down to secure in place.
3. Insert wire clip (13) into top inside mounting hole on bracket, rotate until clip snaps/engages slot on post
4. Loosely bolt (2) clamping plates (item 3) to each rail connecting plate (item 2) one on top and the other on the bottom perpendicular to each other using (8) 1/4-20 x 1/2 Phillips truss head screws (item 8).
5. Insert one loosely bolted clamping plate into each light/tool rail support bracket.
6. Locate clamping plates at an equal depth inside brackets.
7. Fully tighten bottom screws. Leave top screws loose.
8. Bolt (2) light mounting brackets (item 7) to overhead light (item 6) using (2) 1/4 flat washers (item 11) along with (4) #10-24 x 1/2 Phillips truss head screws (item 10).
9. Bolt overhead light to light support rail (item 4) using (2) 1/4-20 x 1/2 Phillips truss head screws and (2) 1/4-20 hex nuts (item 9).

Notes:

- Rails over 72" wide are two piece rails and must be joined using the rail connector (item 5*) and (4) #10-24 x 1/2 Phillips truss head screws.
 - Two people are recommended to perform steps 10 through 12.
10. Slide each end of light support rail over bottom clamping plates.
 11. Center light, left to right, over work area.
 12. Fully tighten bottom screws in clamps.
 13. Cover ends of light/tool rail support brackets and light support rail using (4) 1 1/2" black plastic end caps (item 12).

NEXUS PLASTIC BOX RAILS AND BACKSTOPS

PLASTIC BOX RAIL INSTALLATION

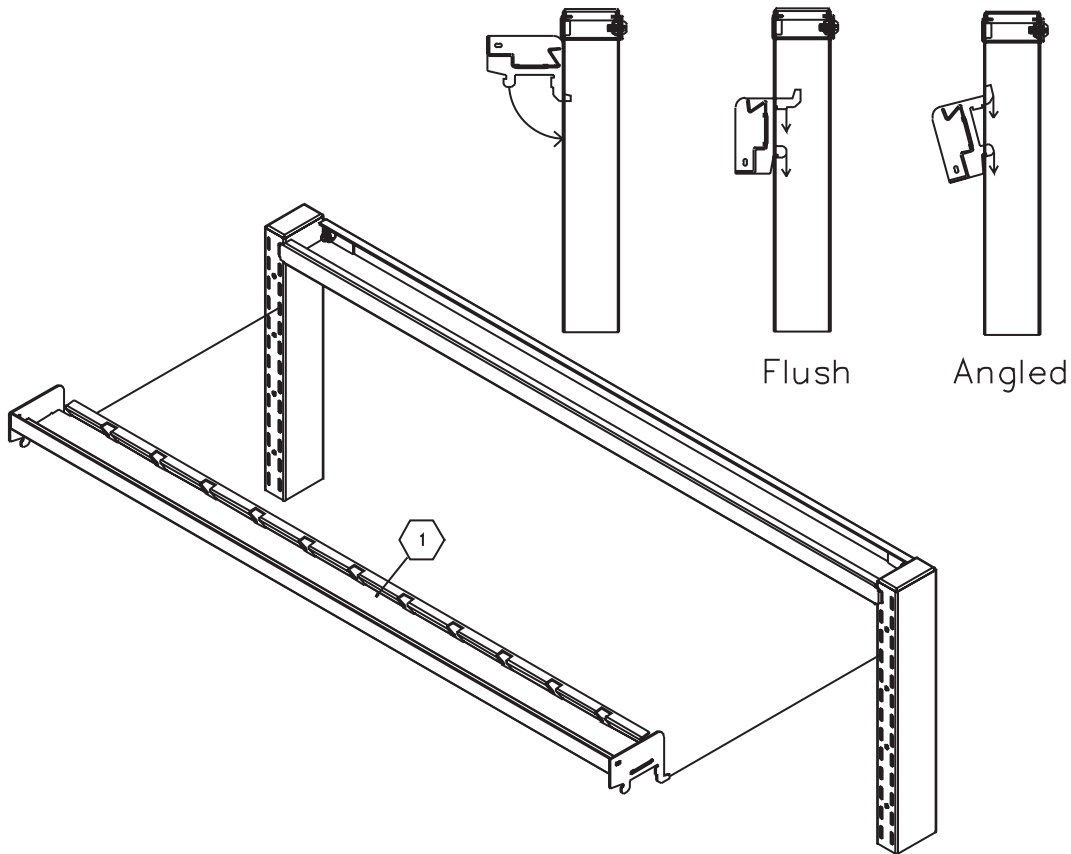

Tools Required:

- No tools necessary

Item	Description	Qty.
1	Plastic Box Rail Weldment	1

Flush Installation:

1. Insert top tabs of plastic box rail (item 1) into inner slots on posts at height desired.
2. Rotate down inserting bottom tabs fully into slots on posts.
3. Press down to secure in place.

Angled Installation:

1. Insert top tabs of plastic box rail (item 1) into inner slots on posts at height desired.
2. Rotate down inserting bottom tabs fully into slots on posts.
3. Pull top of plastic box rail out, rotating bottom of rail closer to post, until top tabs inside post catch.
4. Press down to secure in place.



Make sure plastic box rail is properly installed before adding plastic boxes and weight.

BACKSTOP INSTALLATION

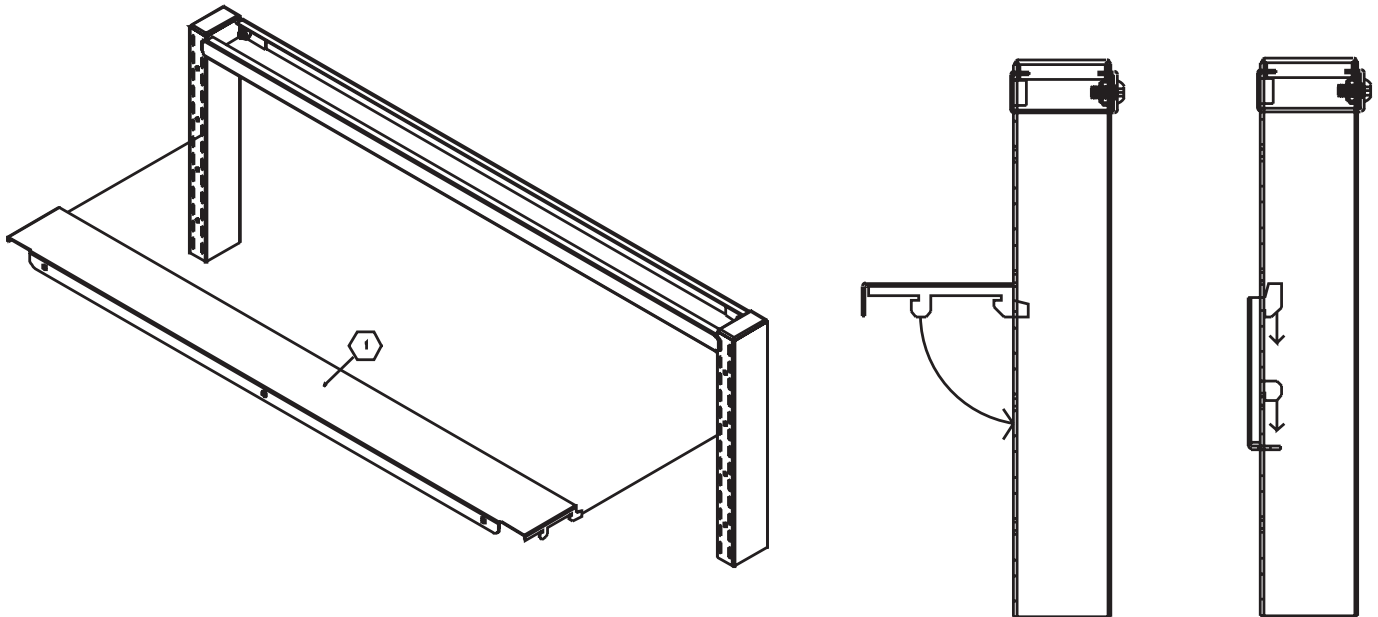

Tools Required:

- $\frac{3}{8}$ " Wrench or Flathead Screwdriver

Item	Description	Qty.
1	Backstop	1
2	Slotted Hex Washer Screw #14 x $\frac{3}{4}$ (not shown)	3

Step:

1. Insert top tabs of backstop (item 1) into inner slots on posts at height desired on front or rear of post.
2. Rotate backstop down inserting bottom tabs into slots on post.
3. Press down to secure in place.

Optional: If bottom flange of backstop is flush with worksurface, may secure to top using (3) #14 x $\frac{3}{4}$ slotted hex washer screws (item2) if desired.

NEXUS OVERHEAD CABINETS

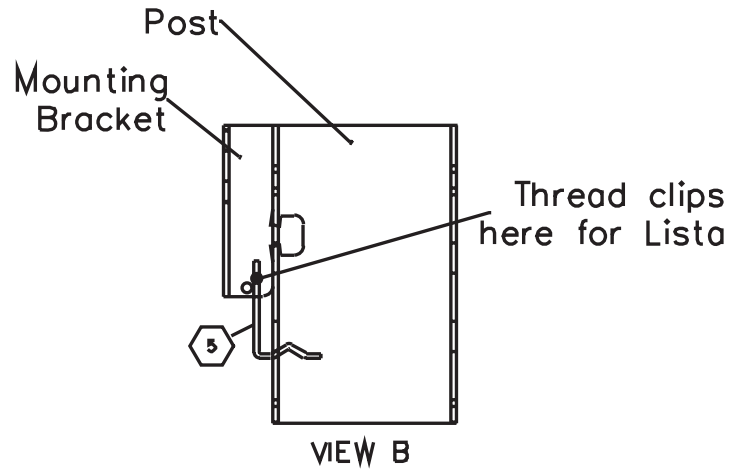
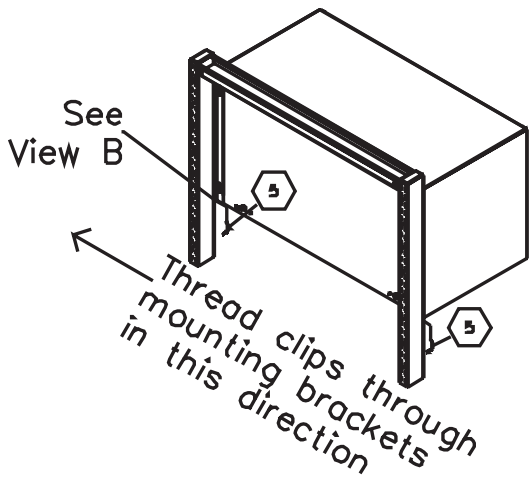
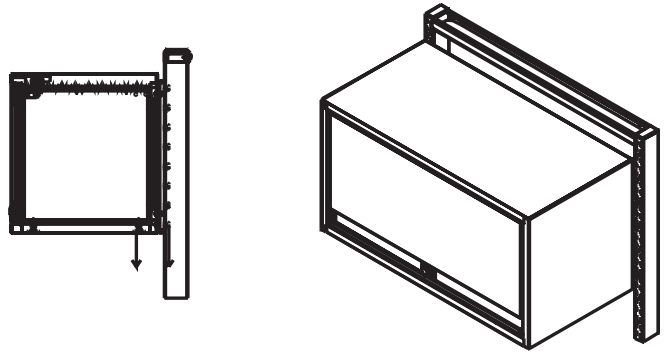
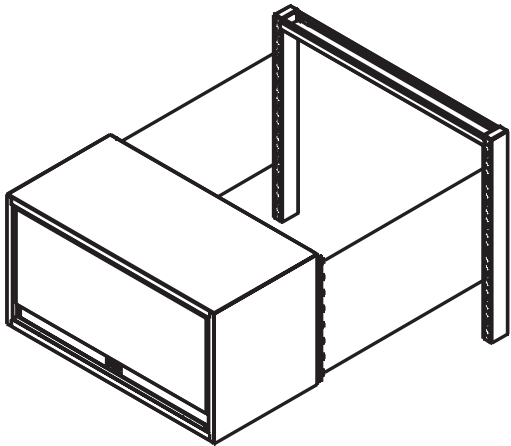
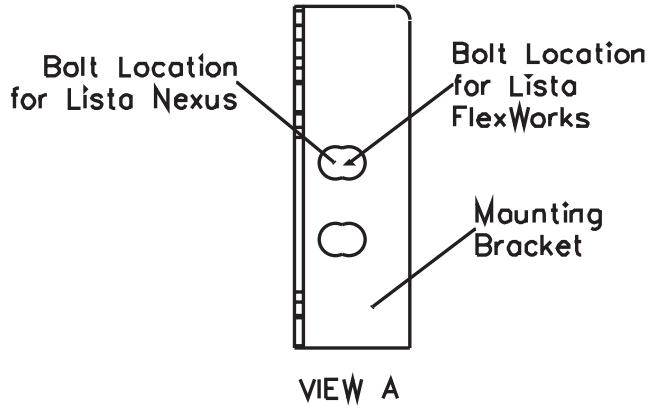
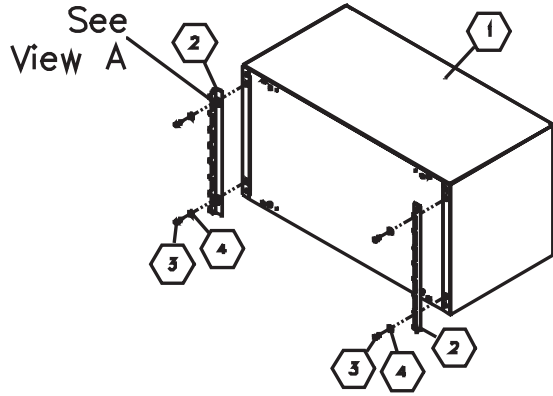

OVERHEAD CABINET INSTALLATION

Tools Required:

- $\frac{3}{16}$ " Hex Key

Item	Description	Qty.
1	Overhead Cabinet Assembly	1
2	Mounting Brackets	2
3	Socket Head Cap Screw $\frac{1}{4}$ -20 x $\frac{1}{2}$ "	4
4	Flat Washer $\frac{1}{4}$	4
5	Wire Security Clip	2

Step:

1. Locate mounting brackets (item 2) on rear of overhead cabinet (item 1) with tabs closest to each side of the cabinet.
2. Bolt mounting brackets to rear of overhead cabinet using (4) $\frac{1}{4}$ -20 x $\frac{1}{2}$ " socket head cap screws (item 3) and (4) $\frac{1}{4}$ flat washers (item 4) through top holes in brackets.
3. Insert tabs of mounting brackets into inner slots on posts at height desired.
4. Press down to secure in place.



Make sure overhead cabinet is properly installed before adding wire security clips and weight.

5. Thread (2) wire clips (item 5) through appropriate hole in bottom of mounting brackets in direction shown.
6. Snap wire clips into slot on post beneath mounting bracket.

NEXUS ARTICULATING ARMS

ARTICULATING ARM INSTALLATION

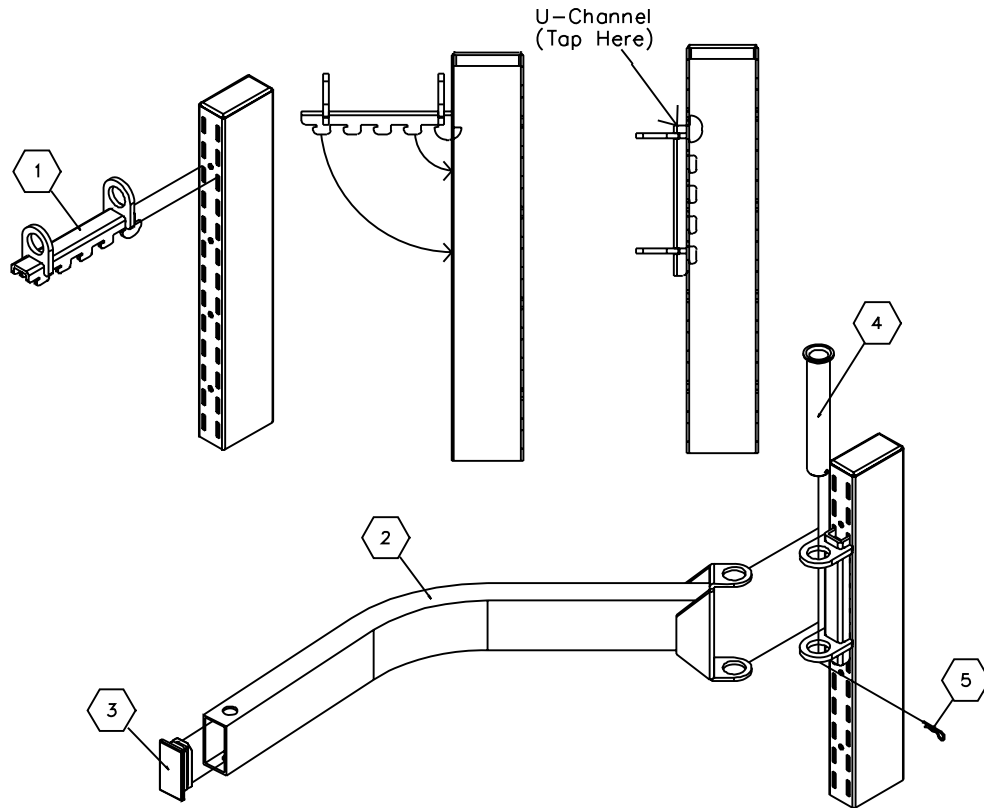

Tools Required:

- Hammer (regular or rubber)
- Block of wood (to protect bracket from hammer)

Item	Description	Qty.
1	Mounting Bracket	1
2	Articulating Arm	1
3	Black Plastic Cap 1" x 2"	1
4	Mounting Pin	1
5	Cotter Hairpin $\phi 1.4 \times 25$	1

Step:

1. Insert top of tabs of mounting bracket (item 1) into slots on post at height desired.
2. Rotate mounting bracket down inserting all tabs into slots on post.
3. Tap mounting bracket down to secure in place. Using soft mallet or block of wood to protect bracket. Locate block or tap with mallet on u-channel as indicated by arrow above.
4. Insert plastic cap (item 3) into end of articulating arm (item 2).
5. Align holes in articulating arm on top of holes of mounting bracket.
6. Insert mounting pin (item 4) through holes in articulating arm and mounting bracket.
7. Insert cotter hairpin (item 5) into hole in mounting pin.

MONITOR & MOUSE TRAY INSTALLATION

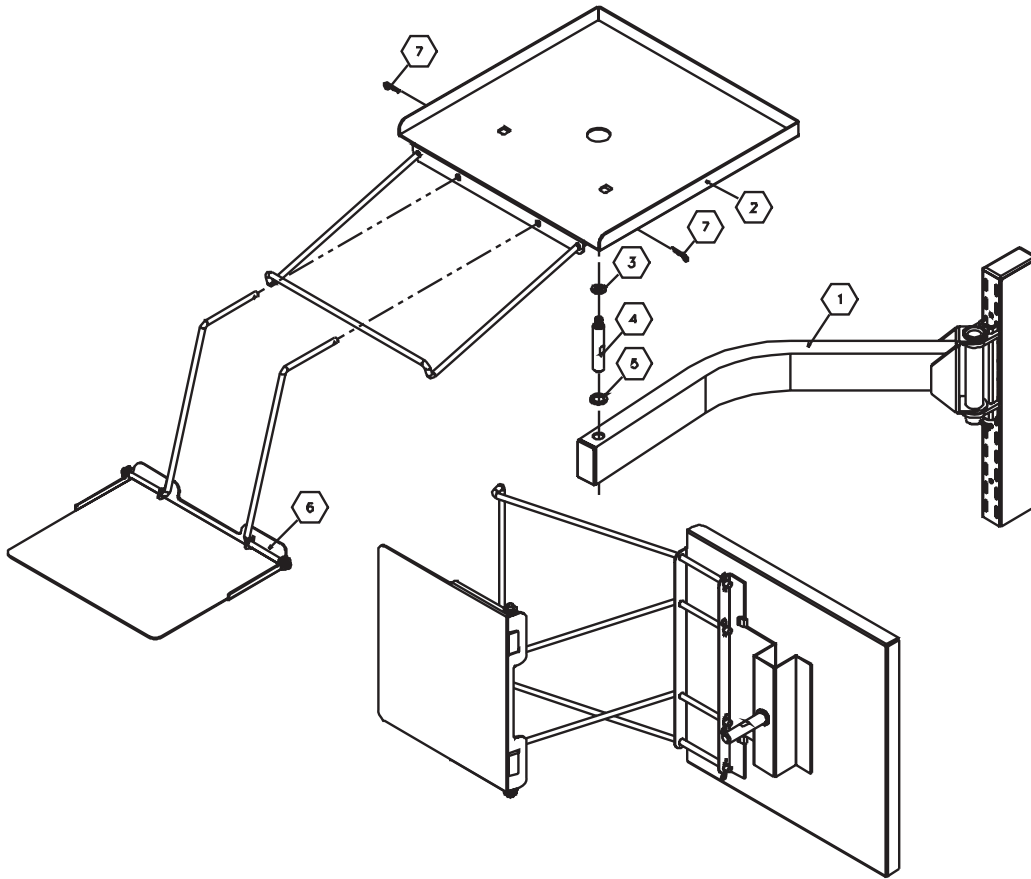

Tools Required:

- $\frac{7}{16}$ " Wrench

Item	Description	Qty.
1	Articulating Arm Assembly	1
2	Monitor Tray	1
3	Flat Washer $\frac{5}{16}$	1
4	Pivot Pin	1
5	Plastic Nylon Washer $\phi 5.05 \times \phi .75$	1
6	Mouse Tray Assembly	1
7	Long Cotter Hairpin $\phi 1.4 \times 25.0$	2

Monitor Tray Installation:

1. Install swing arm assembly (item 1) on post at height desired. Refer to Articulating Arm Installation Instructions, page 24.
2. Insert threaded end of pivot pin (item 4) into $\frac{5}{16}$ flat steel washer (item 3).
3. Screw pivot pin into threaded insert in bottom of monitor tray (item 2) and tighten.
4. Slide plastic washer (item 5) over pivot pin.
5. Insert pivot pin through hole on end of articulating arm assembly.

Mouse Tray Installation:

1. Insert ends of mouse tray (item 6) through both inner sets of holes on monitor tray.
2. Insert (2) cotter hairpins (item 7) into holes at ends of mouse tray rods.

ACCESSORY / TOOL TRAY AND DOCUMENT TRAY INSTALLATION

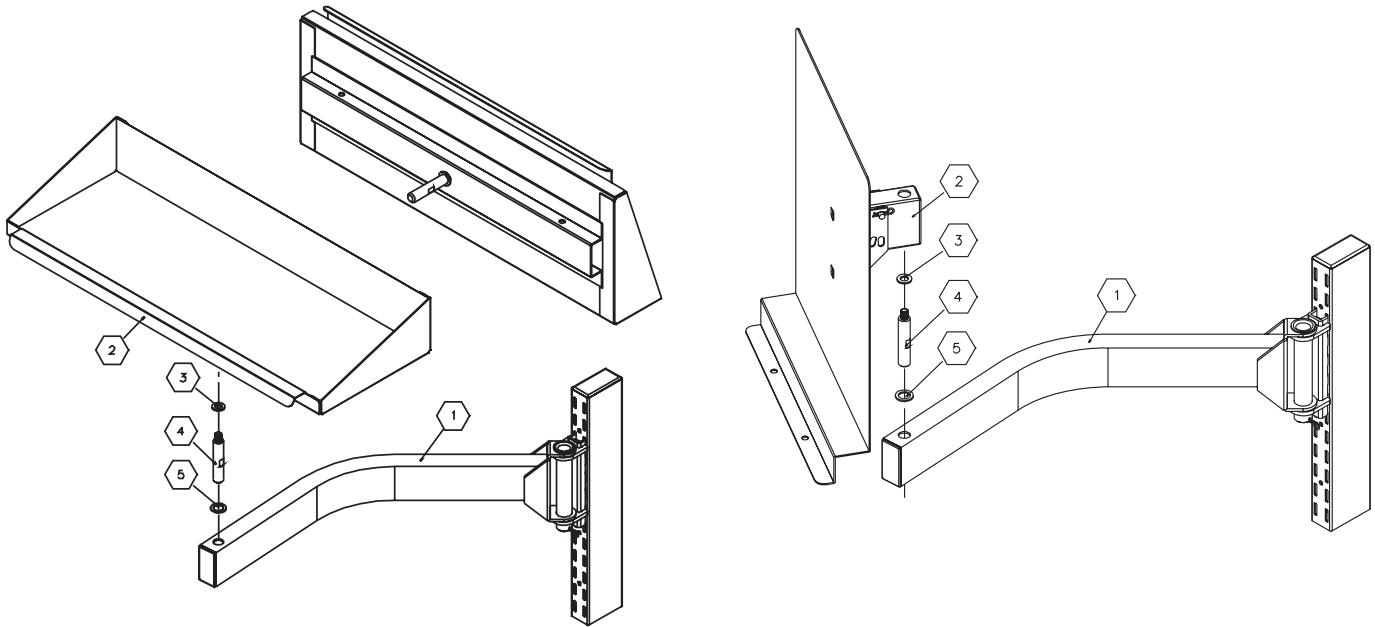

Tools Required:

- $\frac{7}{16}$ " Wrench

Item	Description	Qty.
1	Articulating Arm Assembly	1
2	Accessory/Tool Tray or Document Tray	1
3	Flat Washer $\frac{5}{16}$	1
4	Pivot Pin	1
5	Plastic Nylon Washer $\phi 5.05 \times \phi .75$	1

Step:

1. Install articulating arm assembly (item 1) on post at height desired. Refer to Articulating Arm Installation Instructions, page 24.
2. Insert threaded end of pivot pin (item 4) into $\frac{5}{16}$ flat steel washer (item 3).
3. Screw pivot pin into threaded insert and tighten.
4. Slide plastic washer (item 5) over pivot pin.
5. Insert pivot pin through hole on end of articulating arm assembly.

FLAT PANEL MONITOR BRACKET INSTALLATION

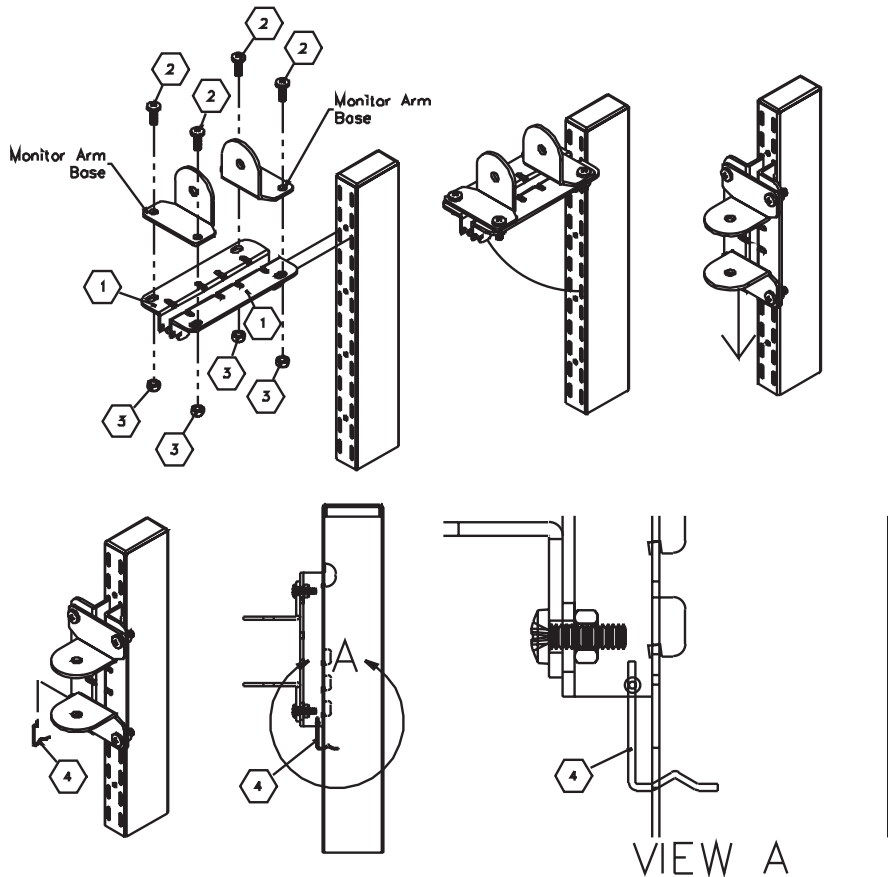

Tools Required:

- Hammer (rubber or regular)
- Block of wood (to protect bracket from hammer)
- Phillips head screwdriver
- Wrench

Item	Description	Qty.
1	Monitor Arm Mounting Bracket (Left & Right)	1 pair
2	Phillips Head Screw	4
3	Hex Nut	4
4	Wire Security Clip	1

Step:

1. Screw monitor arm base (monitor arm not shown) to left and right monitor arm mounting brackets (item 1) using (4) Phillips head screws (item 2) and (4) hex nuts (item 3).

Note: Do not fully tighten bolts.

2. Install top tabs of monitor arm mounting brackets into slots on post at height desired.
3. Rotate down inserting all tabs into slots on post.
4. Hammer down to secure in place. (Use soft mallet or block of wood to protect bracket).
5. Fully tighten all bolts.



Make sure mounting brackets are fully seated and secure on post before installing wire security clips.

6. Thread wire security clip (item 4) through hole in bottom of one of the mounting brackets.
7. Snap wire clip into post slot beneath mounting bracket.

NEXUS BACK PANELS AND MARKERBOARD / TACKBOARDS

PEGBOARD, LOUVERED, SOLID AND WHITE / TACKBOARD PANELS

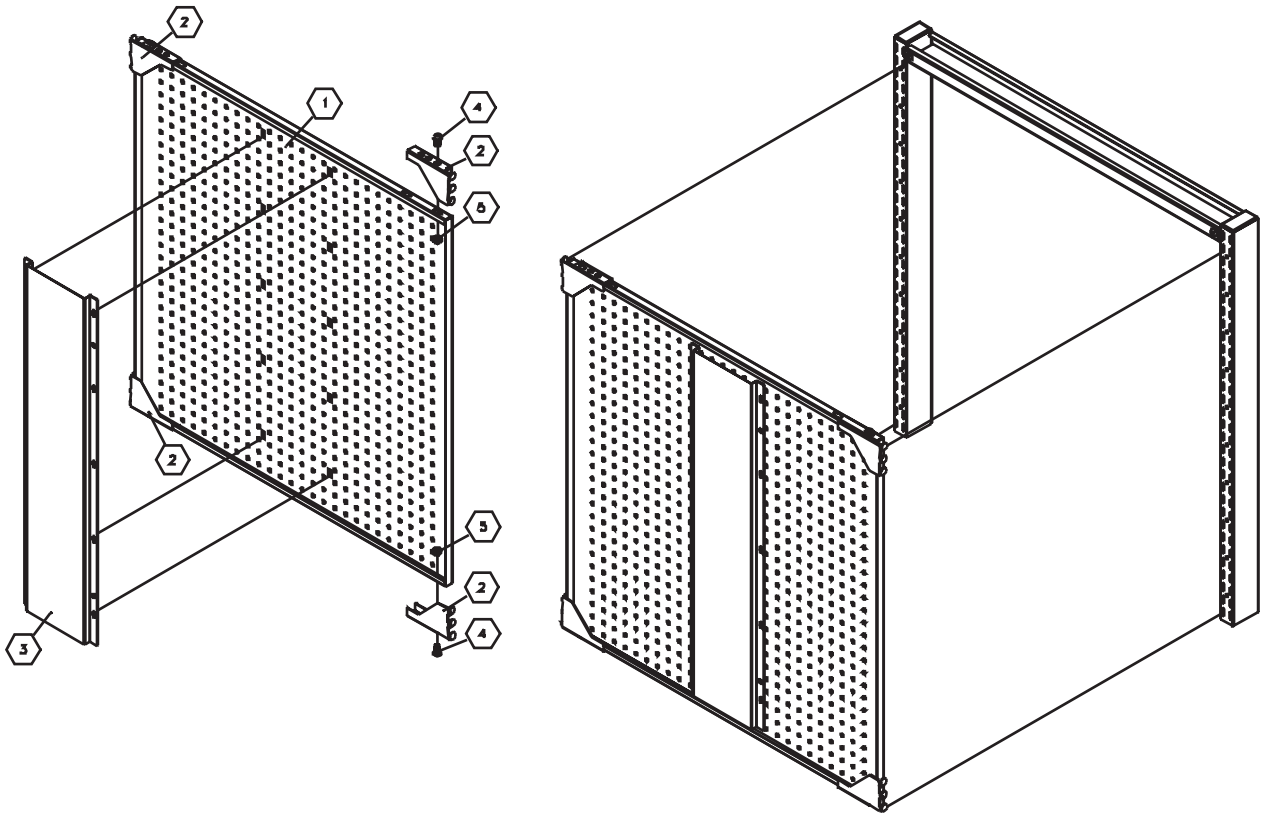

Tools Required:

- $\frac{3}{16}$ " Hex Key
- $\frac{1}{2}$ " Wrench

Item	Description	Qty.
1	Panel (Pegboard, Louvered, Solid or White/Tackboard)	1
2	Panel Support Bracket (left & right, top & bottom)	2 pair
3*	Pegboard & Louvered Panel Stiffener	1*
4	Button Head Cap Screw $\frac{5}{16}$ -18 x $\frac{5}{8}$	4
5	Hex Nut $\frac{5}{16}$ -18	4

* Note: Stiffener used only with pegboard and louvered panels 18" or taller.

Step:

1. Bolt (4) panel support brackets (item 2) to four corners of the panel (item 1) using (4) $\frac{5}{16}$ -18 x $\frac{5}{8}$ button head cap screws (item 4) and (4) $\frac{5}{16}$ -18 hex nuts (item 5). Do not fully tighten bolts.
2. Insert lances of panel stiffener (item 3), used only with pegboard and louvered panels 18" or taller, into rear slots of panel.
3. Press down to secure in place.
4. Insert tabs of panel support brackets into inner slots on posts at height desired.
5. Tap brackets down to secure in place.
6. Fully tighten Cap Screws (item 4).

NEXUS PACKING BENCH ACCESSORIES

ADJUSTABLE SHELVES WITHOUT LIP

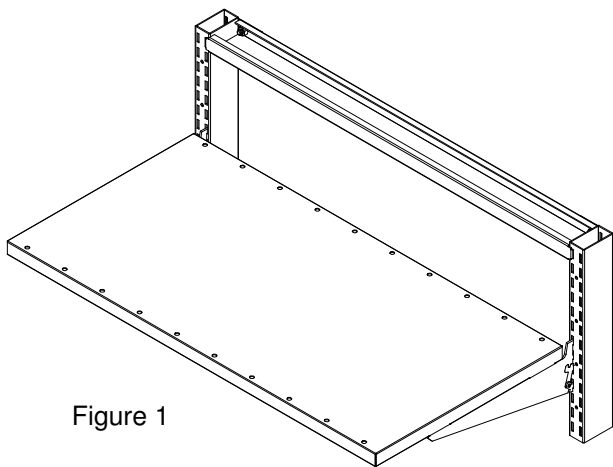

Figure 1

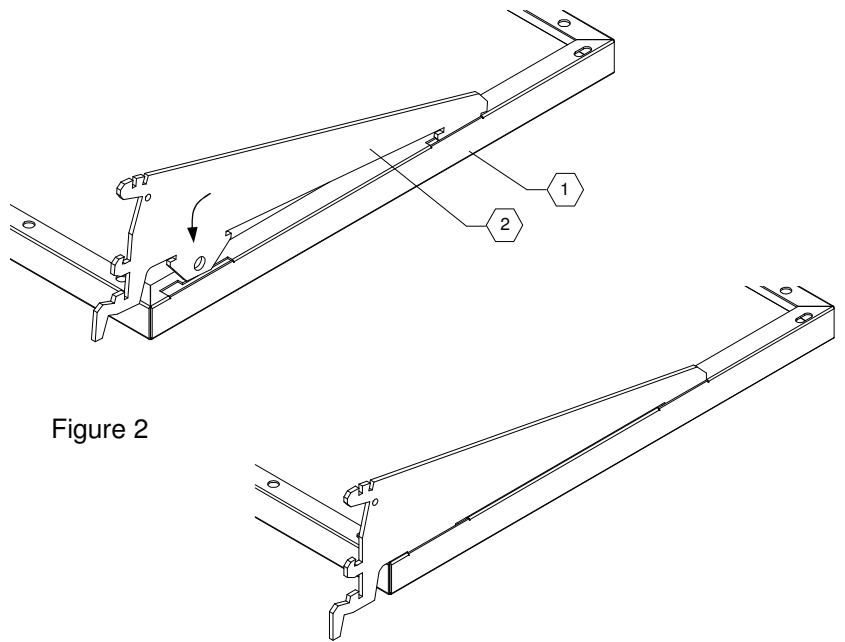

Figure 2

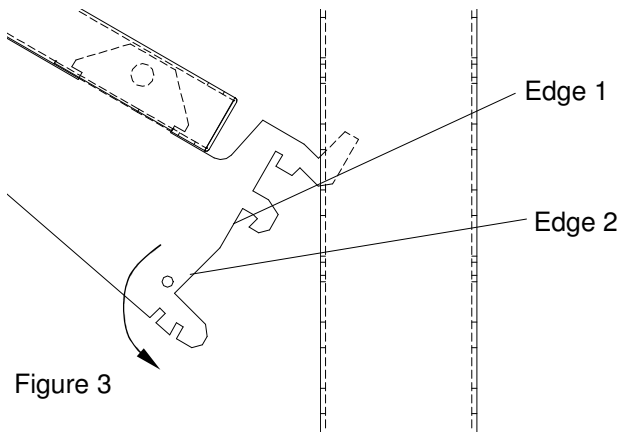

Figure 3

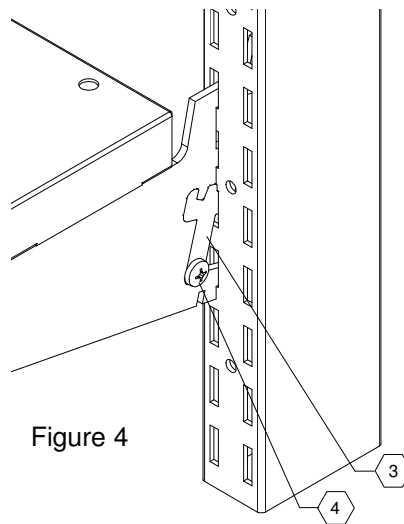

Figure 4

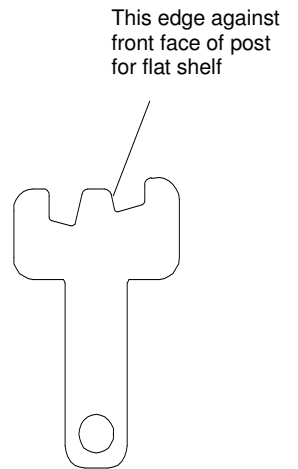

Figure 5

Tools Required:

- Phillips head screwdriver

Item	Description	Qty.
1	Packaging Bench Adjustable Shelf	1
2	Adjustable Shelf Mounting Bracket	2
3	Security clip	2
4	Pan head taptite screw 10-32 x 1/4"	2

Step:

1. Insert mounting brackets (item 2) into slots on bottom of adjustable shelf (item 1) as shown in Figure 2.
2. Insert top tabs of mounting brackets into inner slots on posts at height desired and rotate downwards until edge 1 touches the front of the post, as shown in Figure 3.
3. Press down to engage all three bracket tabs into the slots on the post and to secure in place.

⚠ MAKE SURE SHELF IS PROPERLY INSTALLED TO POST BEFORE INSTALLING SECURITY CLIPS AND BEFORE ADDING WEIGHT.

4. Insert forked end of security clip (item 3) into post, as shown in Figure 4, and rotate to align the hole with hole in mounting bracket. Clips can be installed on either side of bracket. Figure 5 shows proper orientation of clip.
5. Secure clips to mounting bracket using (2) 10-32x1/4" pan head taptite screws (item 4), Figure 4.

VARIABLE ANGLE SHELF ASSEMBLY & INSTALLATION

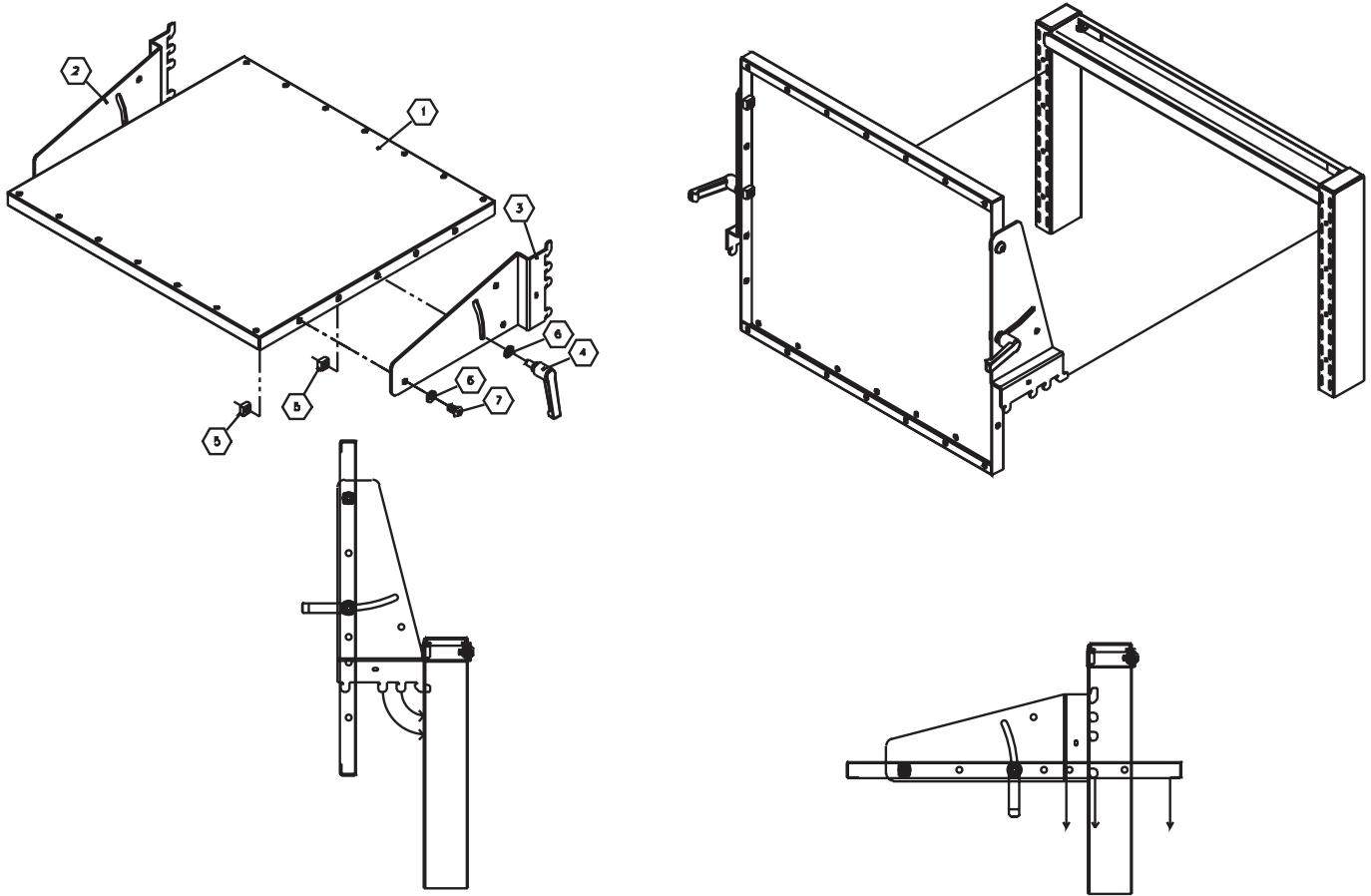

Tools Required:

- $\frac{3}{16}$ " Hex Key
- $\frac{9}{16}$ " Wrench

Item	Description	Qty.
1	Variable Angle Shelf	1
2	Mounting Bracket (Left)	1
3	Mounting Bracket (Right)	1
4	Adjustable Lever $\frac{5}{16}$ -18 x $\frac{5}{8}$	2
5	Square Nut $\frac{5}{16}$ -18	4
6	Flat Washer $\frac{1}{4}$	4
7	Button Head Cap Screw $\frac{5}{16}$ -18 x $\frac{5}{8}$	2

Shelf Assembly:

1. Orient left and right mounting brackets (items 2 & 3) and shelf (item 1) as shown.
2. Bolt brackets to shelf, where desired, using (2) $\frac{5}{16}$ -18 x $\frac{5}{8}$ adjustable levers (item 4), (4) $\frac{5}{16}$ -18 UNC square nuts (item 5), (4) $\frac{1}{4}$ flat washers (item 6) and (2) $\frac{5}{16}$ -18 x $\frac{5}{8}$ button head cap screws (item 7).

Shelf Installation:

1. Insert top tabs of mounting brackets into inner slots on posts at height desired.
2. Rotate down inserting bottom tabs fully into slots on posts.
3. Press down to secure in place.

VERTICAL WIRE DIVIDER INSTALLATION

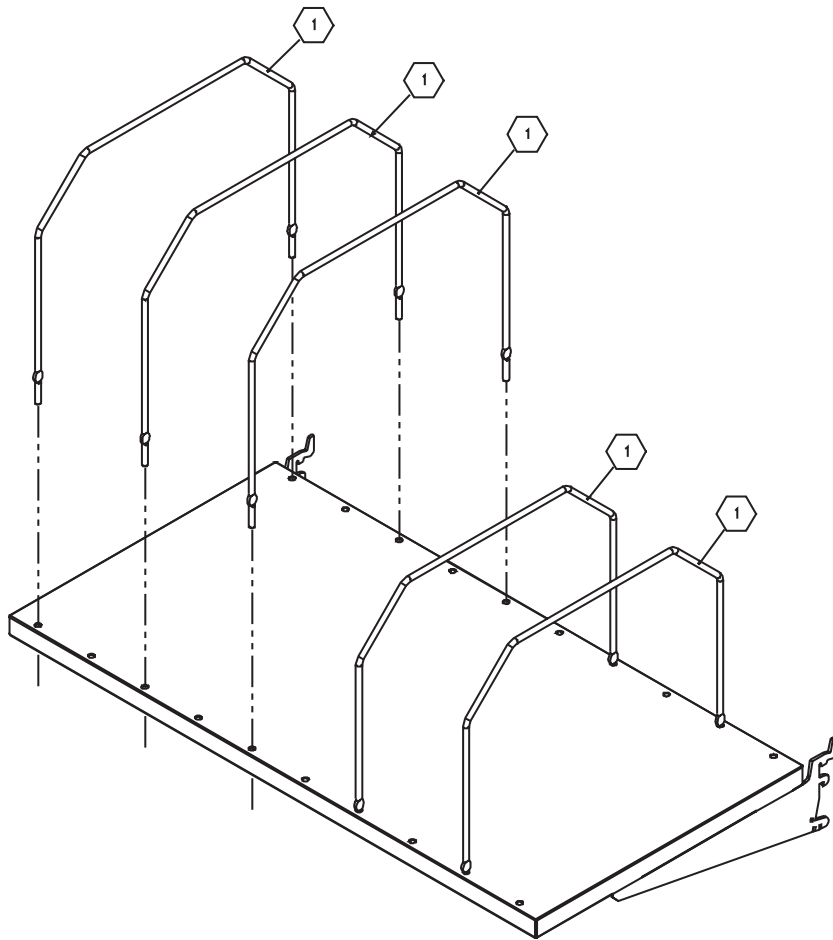

Tools Required:

- No tools necessary

Item	Description	Qty.
1	Wire Divider	A/R

Step:

1. Insert ends of wire divider (item 1) through both sets of holes in shelf where desired.

EXTERIOR ROLL HOLDER INSTALLATION

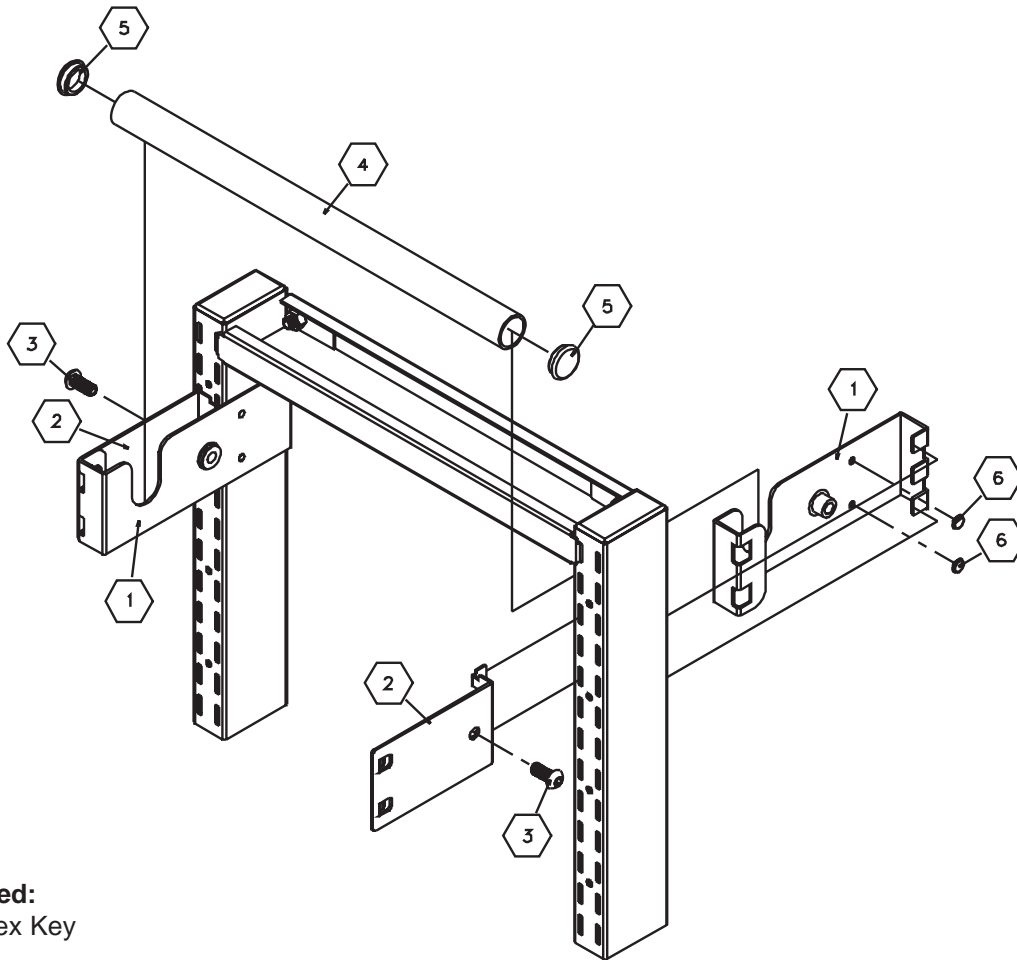

Tools Required:

- $\frac{3}{16}$ " Hex Key

Item	Description	Qty.
1	Inner Brackets (Left & Right)	1 pair
2	Outer Bracket	2
3	Button Head Cap Screw $\frac{5}{16}$ -18 x $\frac{3}{4}$ "	2
4	Spool Rod	1
5	Black End Cap 1" O.D.	2
6	White Plastic Glide Button	4

Step:

1. Insert (4) white plastic glide buttons (item 6) into inside holes in inner brackets.
2. Insert tabs of both left and right inner brackets (item 1) into rear outer slots of post at height desired.
3. Insert tabs of (2) outer brackets (item 2) into front inner slots of post aligned with inner brackets.
4. Lock lances on outer brackets to cutouts on inner brackets.
5. Bolt brackets together, until they no longer rock when moved by hand, using (2) $\frac{5}{16}$ -18 x $\frac{3}{4}$ " button head cap screws (item 3).



Make sure brackets are properly installed before adding spool rod with weight.

6. Insert one end cap (item 5) into each end of the spool rod (item 4).
7. Place spool rod with end caps into curved cutout on inner brackets.

INTERIOR ROLL HOLDER INSTALLATION

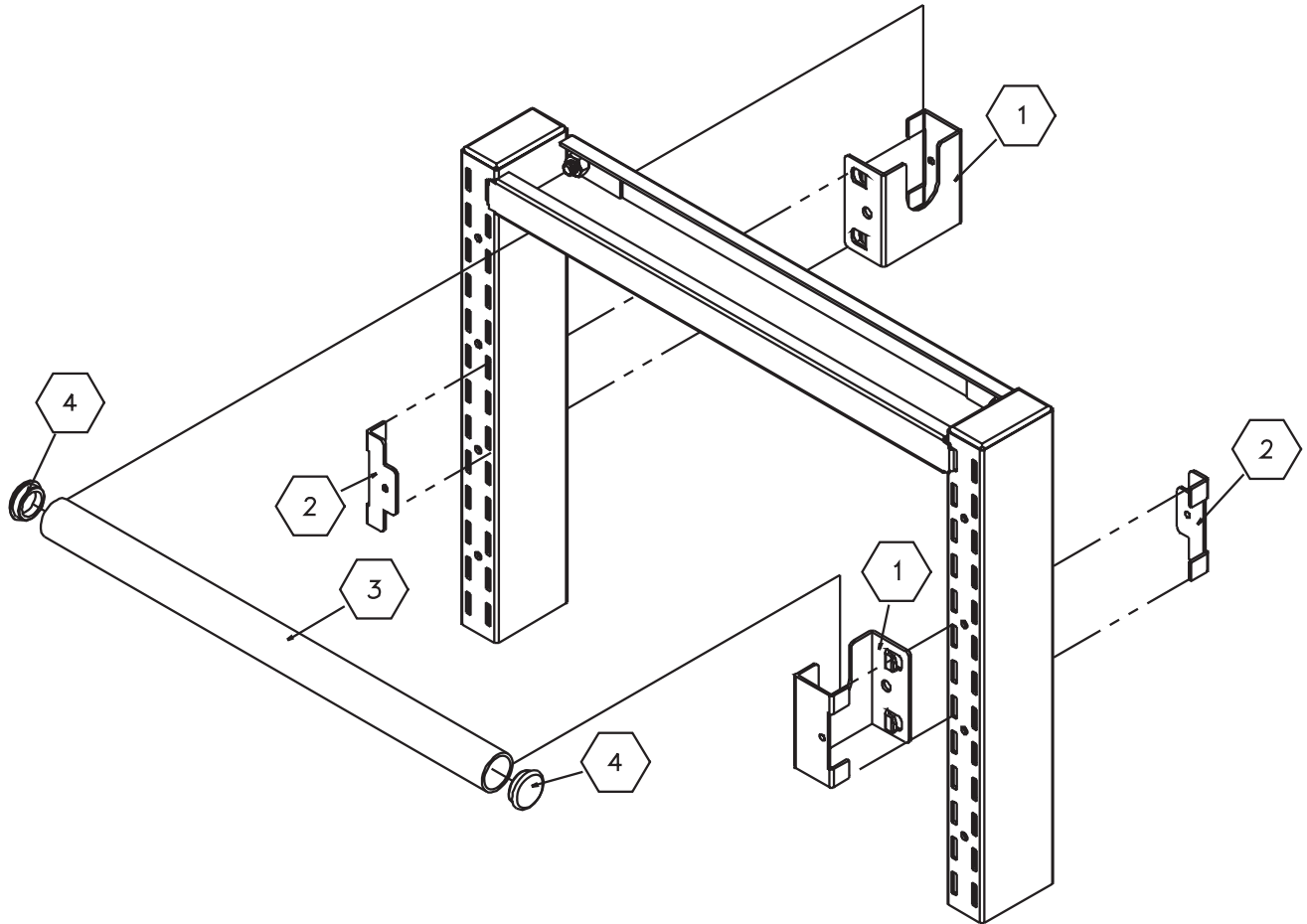

Tools Required:

- No tools necessary

Item	Description	Qty.
1	Front Bracket	2
2	Rear Bracket	2
3	Spool Rod	1
4	Black End Cap 1" O.D.	2

Step:

1. Insert tabs of rear brackets (item 2) into inner slots of post, one in front of the post and the other in rear, at height desired.
2. Insert tabs of front brackets (item 1) into inner slots of post on the opposite side of rear brackets.
3. Rotate front brackets onto post and lock lances onto rear brackets.



Make sure front bracket lances are fully engaged with rear brackets before adding spool rod with weight.

4. Insert one end cap (item 4) into each end of the spool rod (item 3).
5. Place spool rod with end caps into curved cutout on front brackets

NEXUS STATIONARY STANDS AND MOBILE TROLLEY

STATIONARY STAND ASSEMBLY

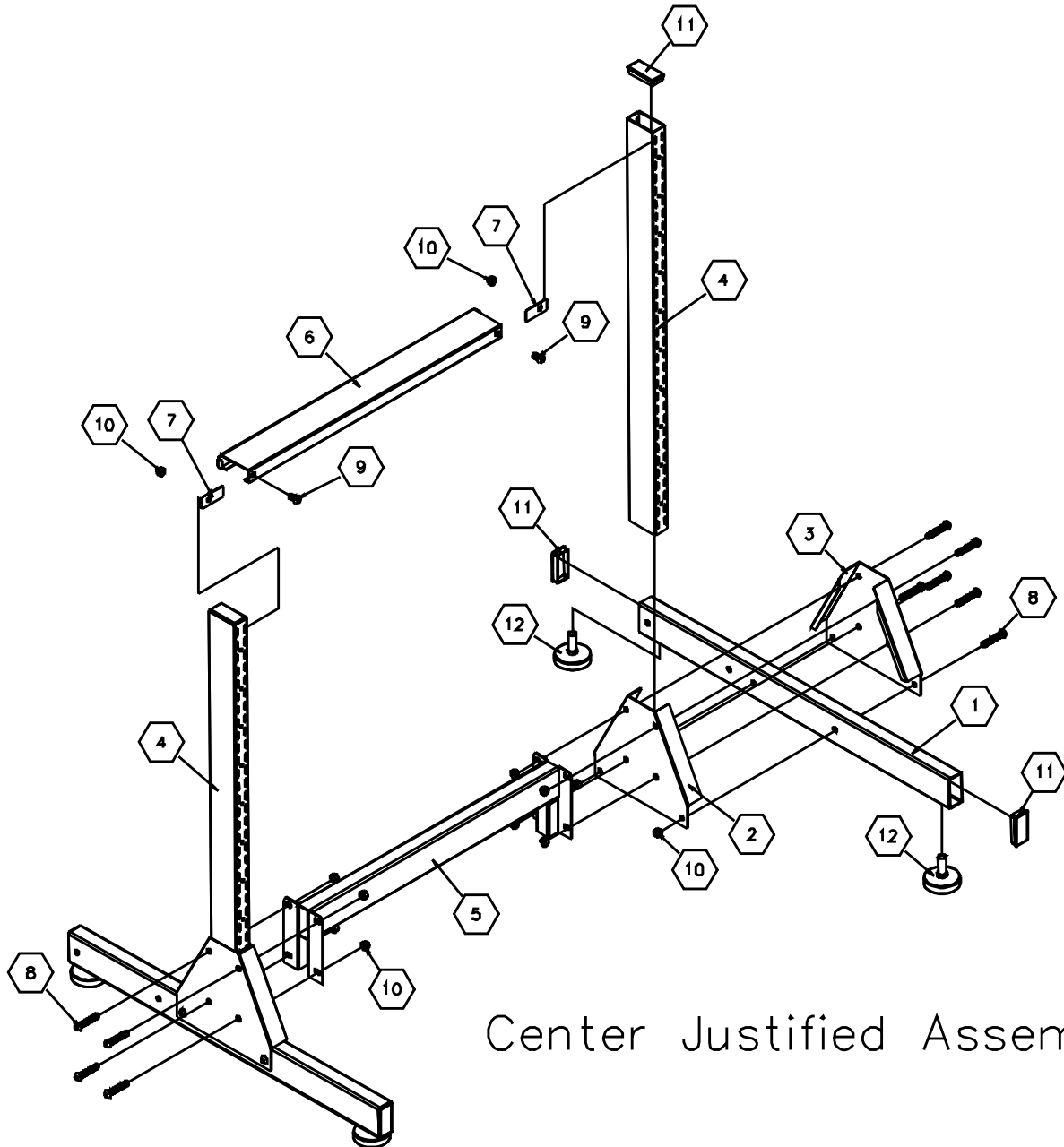

Center Justified Assembly

Rear Justified Assembly

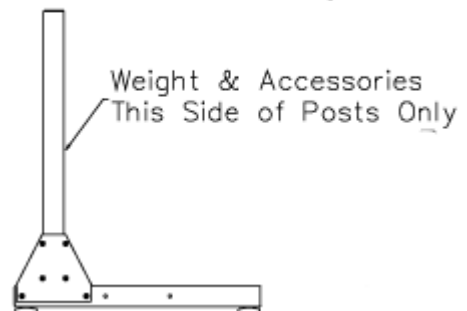

STATIONARY STAND ASSEMBLY

Tools Required:

- $\frac{3}{16}$ " Hex Key
- $\frac{1}{2}$ " Wrench

Item	Description	Qty.
1	Foot Weldment	2
2	Inner Support	2
3	Outer Support	2
4	Post	2
5	Stretcher Weldment	1
6	Horizontal Rail	1
7	Retainer Clip	2
8	Button Head Cap Screw $\frac{5}{16}$ -18 x $1\frac{3}{4}$	12
9	Button Head Cap Screw $\frac{5}{16}$ -18 x $\frac{5}{8}$	2
10	Hex Nut $\frac{5}{16}$ -18	14
11	Black Plastic Plug 30 mm x 60 mm	6
12	Stem Glide $\frac{1}{2}$ -13 x $1\frac{1}{2}$	4

Step:

1. Insert (6) plugs (item 11) into top of posts (item 4) and ends of feet (item 1).
2. Screw (4) glides (item 12) into threaded insert in bottom of feet.
3. Bolt inner and outer supports (items 2 & 3) to feet using (4) $\frac{5}{16}$ -18 x $1\frac{3}{4}$ button head cap screws (item 8) and (4) $\frac{5}{16}$ -18 hex nuts (item 10). Do not fully tighten bolts.

Note: Inner and outer supports can be mounted to the center or end of feet.

4. Bolt stretcher weldment (item 5) to inner supports on feet using (8) $\frac{5}{16}$ -18 x $1\frac{3}{4}$ button head cap screws and (8) $\frac{5}{16}$ -18 hex nuts. Do not fully tighten bolts.
5. Insert posts into inner and outer supports and fully tighten all bolts.
6. Insert tabs of horizontal rail (item 6) into top inner slots of posts.
7. Insert (2) retainer clips (item 7) into end of horizontal rail and into inner slots on post.
8. Bolt retainer clips to horizontal rail using (2) $\frac{5}{16}$ -18 x $\frac{5}{8}$ button head cap screws (item 9) and (2) $\frac{5}{16}$ -18 hex nuts.

The Nexus™ Stand is available with either an offset frame or a centered frame configuration. Although the frames differ in appearance, the method of assembly is identical for each unless indicated otherwise.



NEVER ADD WEIGHT OR ACCESSORIES TO REAR SIDE OF STAND IF POSTS ARE MOUNTED REAR JUSTIFIED TO END OF FEET.

STATIONARY STAND ADDER ASSEMBLY

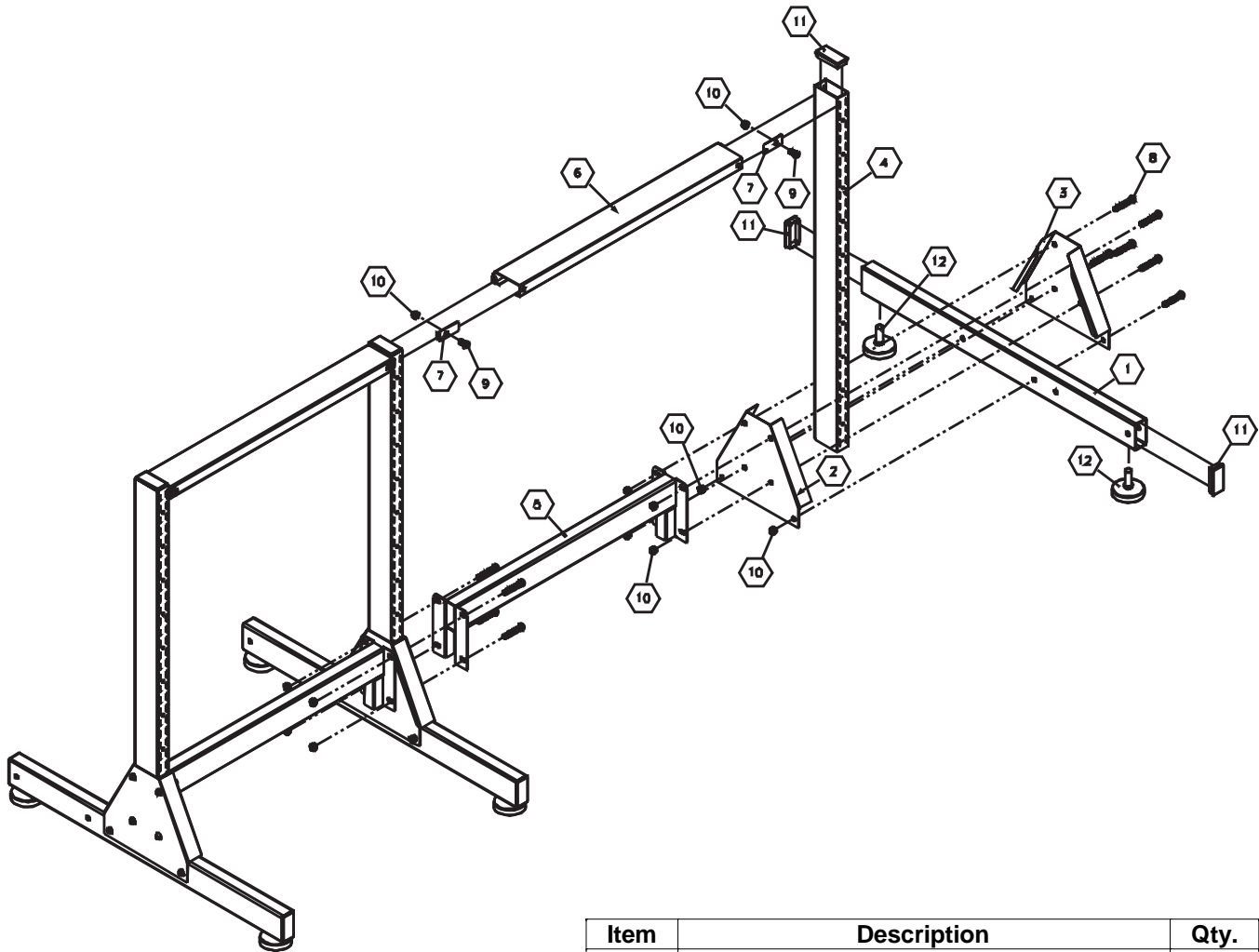

Tools Required:

- $\frac{3}{16}$ " Hex Key
- $\frac{1}{2}$ " Wrench

Item	Description	Qty.
1	Foot Weldment	1
2	Inner Support	1
3	Outer Support	1
4	Post	1
5	Stretcher Weldment	1
6	Horizontal Rail	1
7	Retainer Clip	2
8	Button Head Cap Screw $\frac{5}{16}$ -18 x $1\frac{3}{4}$	6
9	Button Head Cap Screw $\frac{5}{16}$ -18 x $\frac{5}{8}$	2
10	Hex Nut $\frac{5}{16}$ -18	8
11	Black Plastic Plug 30 mm x 60 mm	3
12	Stem Glide $\frac{1}{2}$ -13 x $1\frac{1}{2}$	2

Step:

1. Insert (3) black plastic plugs (item 11) into top of post (item 4) and ends of foot weldment (item 1).
2. Screw (2) stem glides (item 12) into threaded insert in bottom of foot.
3. Bolt inner and outer supports (items 2 & 3) to foot using (2) $\frac{5}{16}$ -18 x $1\frac{3}{4}$ button head cap screws (item 8) and (2) $\frac{5}{16}$ -18 hex nuts (item 10).
4. Bolt stretcher weldment (item 5) to inner supports on feet using (8) $\frac{5}{16}$ -18 x $1\frac{3}{4}$ button head cap screws and (8) $\frac{5}{16}$ -18 hex nuts. Do not fully tighten bolts.
5. Insert post into inner and outer supports and fully tighten all bolts.
6. Insert tabs of horizontal rail (item 6) into top inner slots of posts.
7. Insert (2) retainer clips (item 7) into end of horizontal rail and into inner slots on post.
8. Bolt retainer clips to horizontal rail using (2) $\frac{5}{16}$ -18 x $\frac{5}{8}$ button head cap screws (item 9) and (2) $\frac{5}{16}$ -18 hex nuts.

MOBILE TROLLEY ASSEMBLY

Rear Justified Assembly

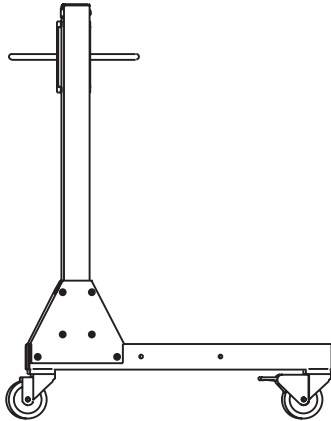

Center Justified Assembly

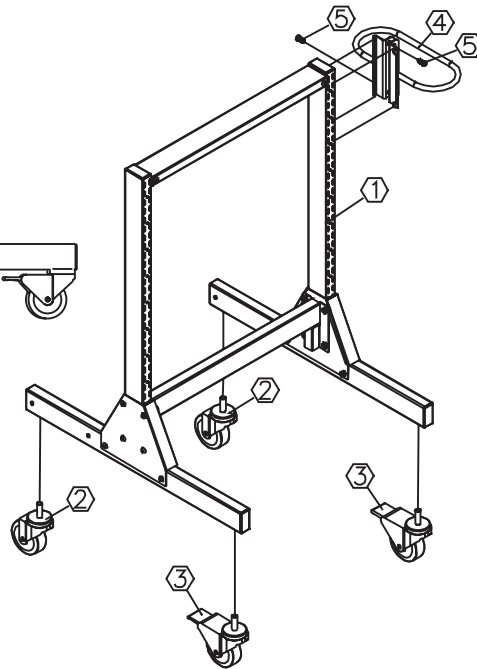

Tools Required:

- $\frac{3}{16}$ " Hex Key

Item	Description	Qty.
1	Stationary Stand without Stem Glides	1
2	Rigid Caster	2
3	Swivel Caster	2
4	Trolley Handle	1
5	Button Head Cap Screw $\frac{5}{16}$ -18 x $\frac{3}{4}$	2

Step:

1. Assemble stationary stand (item 1), without stem glides, following Stationary Stand Assembly instructions, page 34 - 35.
2. Screw (2) rigid and (2) swivel casters (items 2 & 3) fully into threaded inserts in bottom of feet of stationary stand. Note orientation of casters.
3. Clip tabs of trolley handle mounting brackets into outer slots on side of post at height desired.
4. Bolt trolley handle (item 14) together using (2) $\frac{5}{16}$ -18 x $\frac{3}{4}$ button head cap screws (item 5).

NEXUS FLOW RACK

NEXUS FLOW RACK FRAME ASSEMBLY

Tools Required:

- 3/16" Hex Key

Item	Description	Qty.
1	Post	4
2	Black Plastic Plug	4
3	Stem Glide or Caster (not pictured)	4
4	Retainer Clip	4
5	Front & Rear Stability Brace	4
6	Side Stability Brace	4
7	Button Head Cap Screw	16

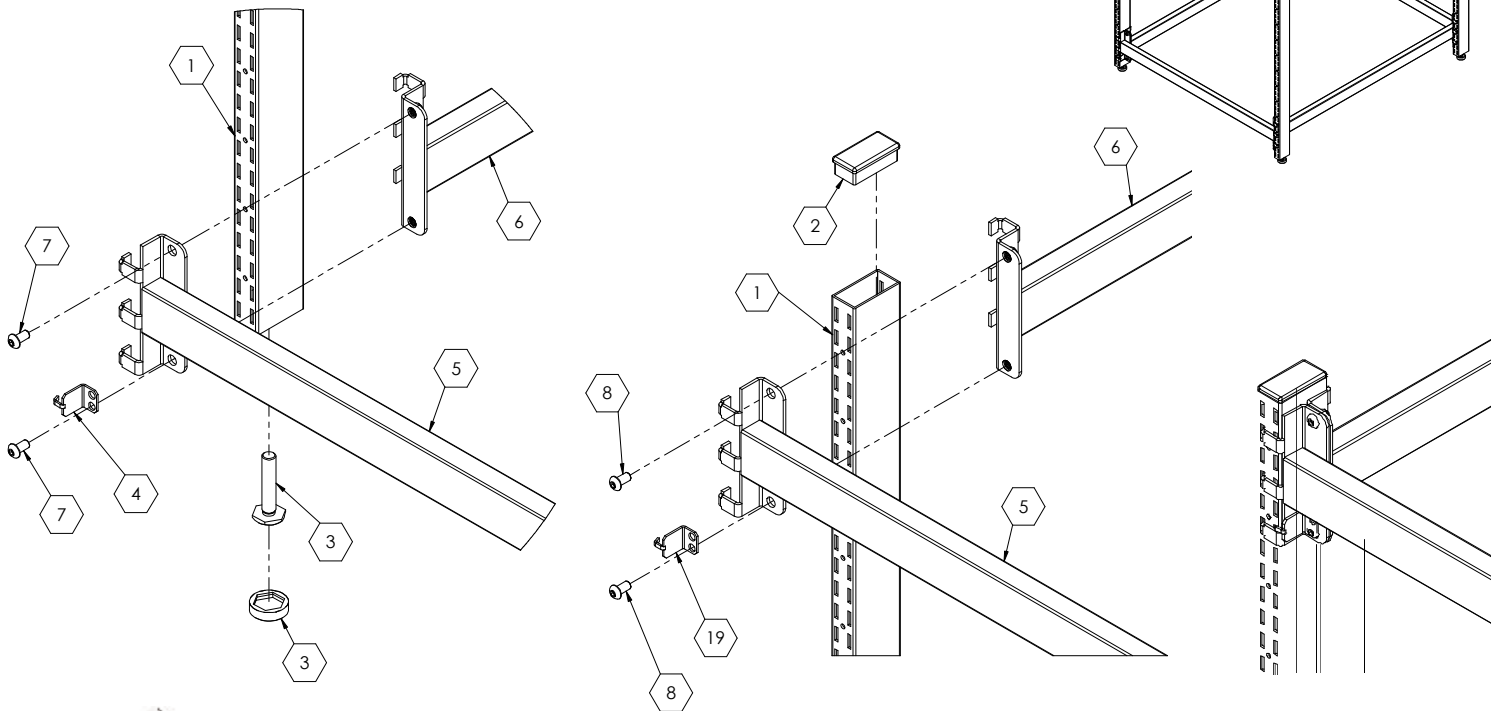
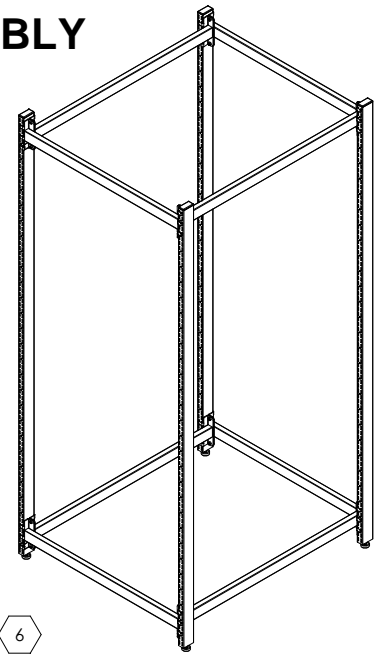

Casters to be used on starter/single flow racks units only.

Step:

1. Screw (4) stem glides or casters (item 3) into the threaded insert end on each post (item 1)
2. Insert (4) black plastic plugs (item 2) into the opposite end of each post
3. Place (2) front stability braces (item 5) on the floor, 1 post length apart (approx. 84 1/2")
 - 3.1. Brace tabs should be facing upwards
4. Set (2) posts on the braces so the tabs hook into the slots on the post
 - 4.1. Braces should be positioned at the ends of the posts
 - 4.2. When a worksurface is used see next page for brace placement
5. Insert the side stability braces with the tabs going into the slots of the posts
 - 5.1. Threaded inserts in the side braces should line up with the holes in the front brace
6. Fasten (1) screw into each bracket using button head cap screws (item 7) – do not completely tighten
7. Place (1) retainer clip (item 4) in each corner between brace bracket and screw head
 - 7.1. Fasten the components together
8. Place the (2) remaining posts into position repeating the above steps
9. Tighten all screws to ensure frame is secure
10. Lift the frame up-right into its upright position. Adjust glides to level if needed.

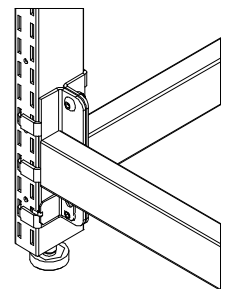

Make sure flow rack frame is properly assembled before adding accessories or weight. Maximum capacity of frame is 1,800 lbs evenly distributed.

FLOW RACK FRAME WITH FEET & WORKSURFACE ASSEMBLY

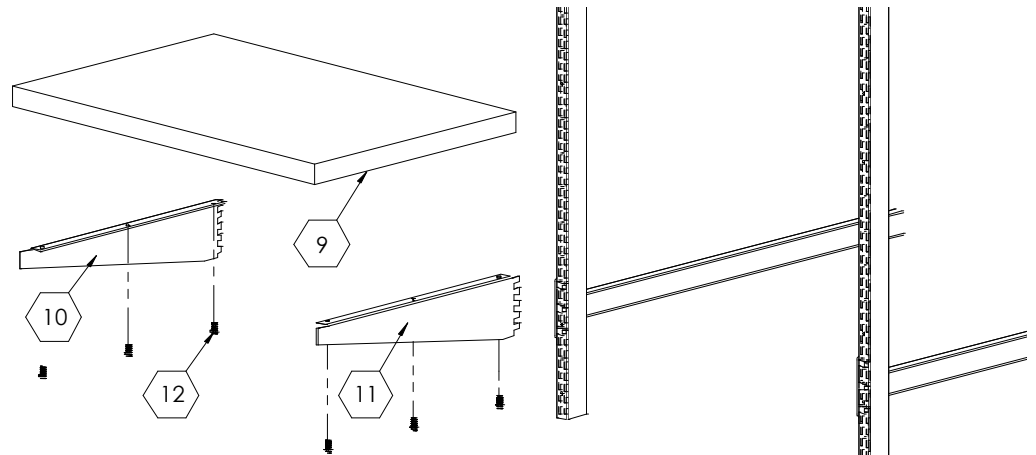

Tools Required:

- 3/16" Hex Key
- 1/2" Wrench
- Drill and 13/64" drill bit

Item	Description	Qty.
1	Foot	2
2	Black Plastic Plug	4
3	Stem Glide	4
4	Outer Support	2
5	Inner Support	2
6	Stretcher	1
7	Button Head Cap Screw	12
8	Hex Nut	12
9	Worksurface	1
10	Worksurface Mounting Bracket - Left	1
11	Worksurface Mounting Bracket - Right	1
12	Slotted Hex Head Lag Screw	6

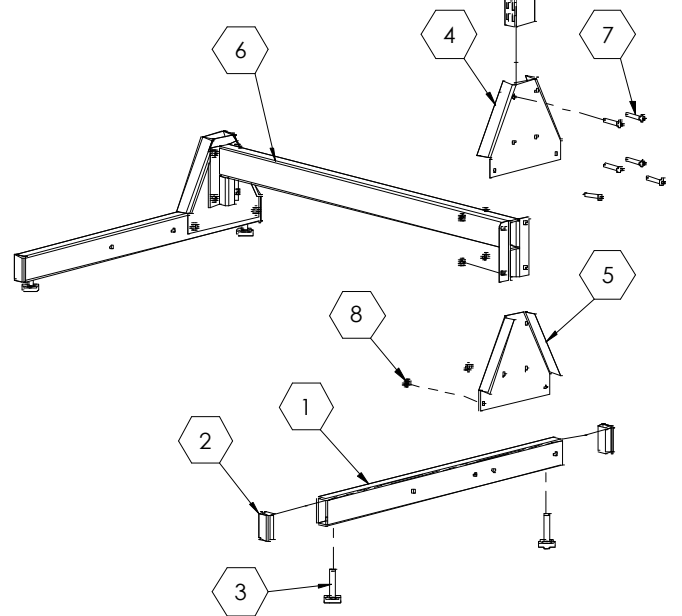

Step:

- Using the instructions on the preceding page for the Flow Rack Frame Assembly; assemble the Flow Rack Frame
 - Assemble the frame without the lower front (left to right) stability brace
 - Install the lower left and right (front to rear) stability braces so the bottom tab is in the slot up from the bottom
- Install (4) black plastic plugs (item 2) into each end of feet (item 1)
- Screw (4) stem glides (item 3) into threaded insert on the bottom feet (item 1)
- Bolt (2) outer (item 4) and (2) inner supports (item 5) to feet w/ (4) button head cap screws (item 7) & (4) hex nuts (item 8)
 - Do not fully tighten bolts
- Slide foot assemblies onto the ends of the posts
- Position the stretcher (item 6) between the leg assemblies.
 - Fasten together using (8) button head cap screws and (8) hex nuts
- Fully tighten all bolts
- Hook the tabs of the worksurface brackets (items 10 & 11) into the slots of the posts at the desired height
 - Press or tap the brackets down to secure in place
- Center work surface onto the mounting brackets and place flush against the front face of the posts
- Mark the bracket hole positions on the bottom of worksurface
- Remove the worksurface. Drill a 13/64 x 1/2" deep hole at the marked positions
- Fasten the worksurface to the brackets using (6) slotted hex head lag bolts (item 12)



Make sure flow rack feet are properly assembled before adding accessories or weight.

FLOW RACK TRAY ASSEMBLY

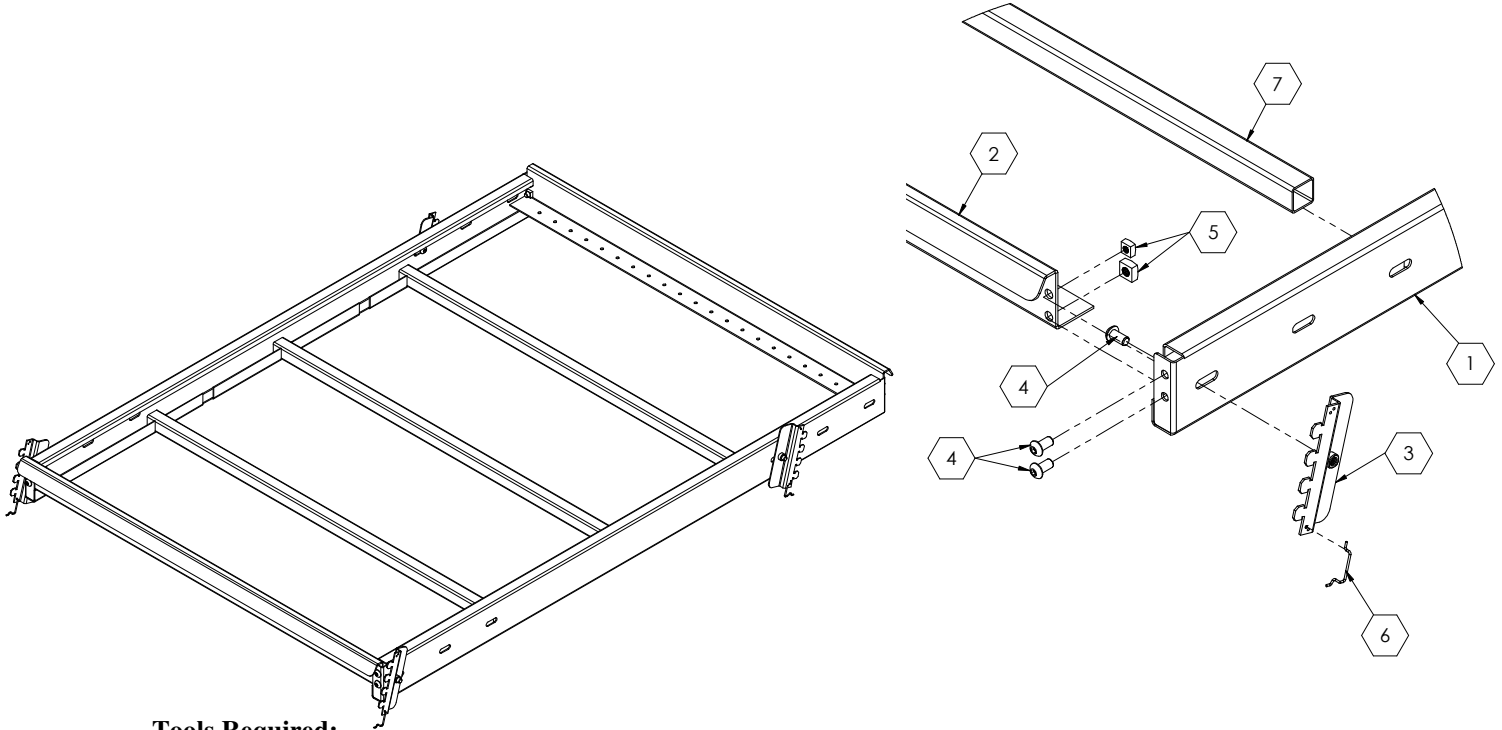

Tools Required:

- 3/16" Hex Key
- 9/16" Wrench

Item	Description	Qty.
1	Side Rail	2
2	Front and Rear Rail	2
3	Mounting Bracket	4
4	Button Head Cap Screw 5/16-18 x 5/8"	12
5	Square Nut 5/16-18	8
6	Security Clip	4
7	Track Support Brace – 30" through 48"	2
7	Track Support Brace – 60"	3

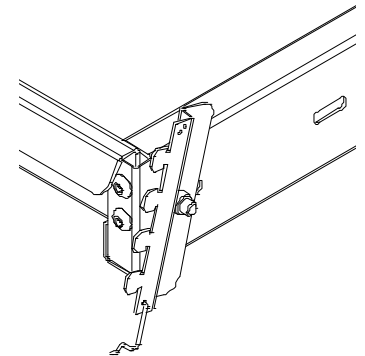

Step:

1. Place front rail (item 2) so it rests against the inside front flange of side rail (item 1)
2. Place rear rail (item 2) so it rests against the inside rear flange of side rail
3. Place the second side rail on opposite side of the front and rear rail
4. Place button head cap screws (item 4) through the holes on located on each front and rear flange (8 total)
5. Secure all screws in place with square nuts (item 5)
6. Place mounting bracket (item 3) against side rail at desired position (front, middle or rear obround)
 - 6.1. Mounting bracket tabs should be facing outward (both front and rear)
7. Place button head cap screw through side rail into threaded insert on mounting bracket, secure in place
 - 7.1. Do not tighten completely, adjustment will be needed when attaching to frame
8. Repeat steps 6 and 7 for remaining mounting brackets
9. Security clip (item 7) is to be placed in the hole located in each mounting bracket (4 total)
10. Insert track support brace (item 7) into shelf frame at designated spots
 - 10.1. For 30" through 48" shelves – 1 brace each in the 2nd and 4th slot from the front
 - 10.2. For 60" shelves – 1 brace each in the 1st, 3rd and 5th slot from the front
11. Mount shelf assembly onto frame at desired position



- Tray should not have too steep an angle or items placed on tray could fall over front lip.
- Ensure flow rack tray is properly installed before adding weight.
- Make sure a sufficient number of roller tracks are installed to support added weight.
- Maximum capacity of tray = 600 lbs. (evenly distributed)

NEXUS ACCESSORIES

DOCUMENT POCKET

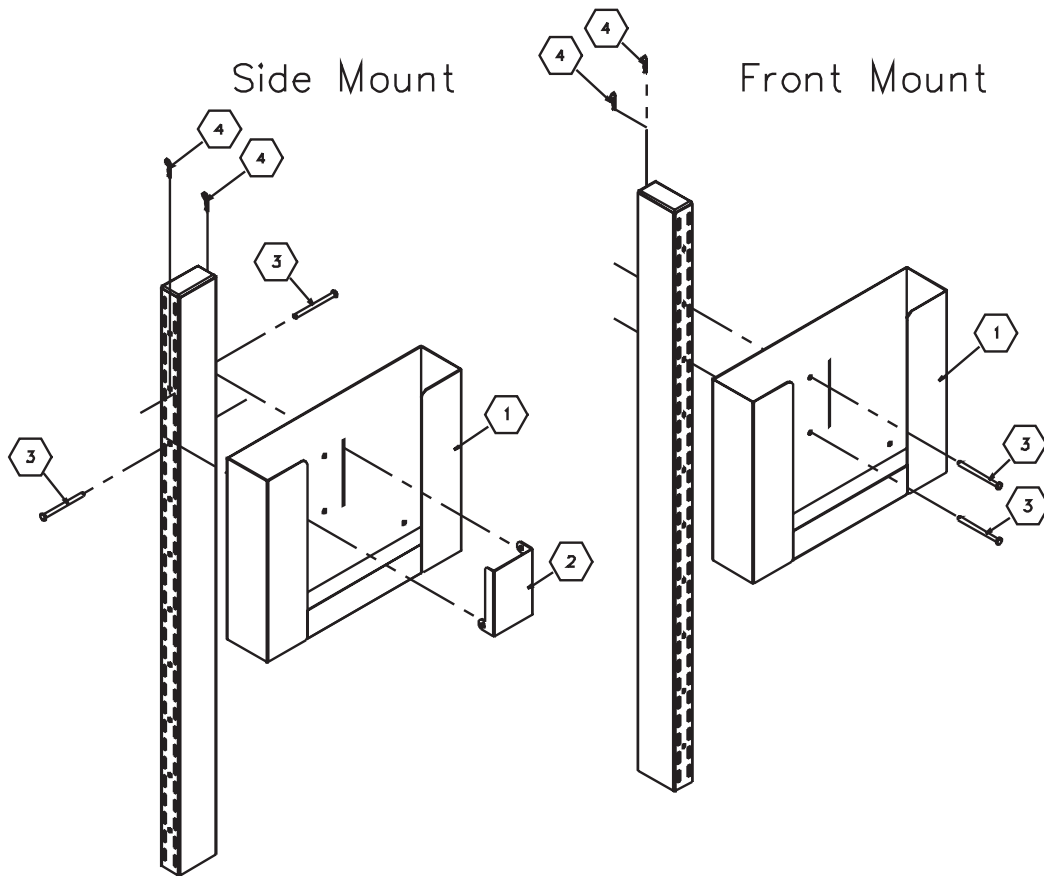

Tools Required:

- No tools necessary

Item	Description	Qty.
1	Document Pocket	1
2	Document Pocket Mtg. Bracket	1
3	Clevis Pin $\frac{3}{16} \times 2\frac{1}{2}$	2
4	Cotter Hairpin	2

Side Mount:

1. Insert mounting bracket (item 2) through slots in document pocket (item 1) and place on side of post.
2. Align holes in mounting bracket with holes in post at height desired.
3. Insert (1) clevis pin (item 3) through the hole in mounting bracket then through post.
4. Insert (1) cotter hairpin (item 4) through hole in clevis pin.
5. Repeat steps 3 and 4 on other side of mounting bracket.

Front Mount (mounting bracket not used):

1. Locate document pocket (item 1) on front of post.
2. Align holes in document pocket with holes in post at height desired.
3. Insert (2) clevis pins (item 3) through holes in document pocket and post.
4. Insert (2) cotter hairpins (item 4) into holes in clevis pins.

FIXED FOOTREST FOR ALIGN™

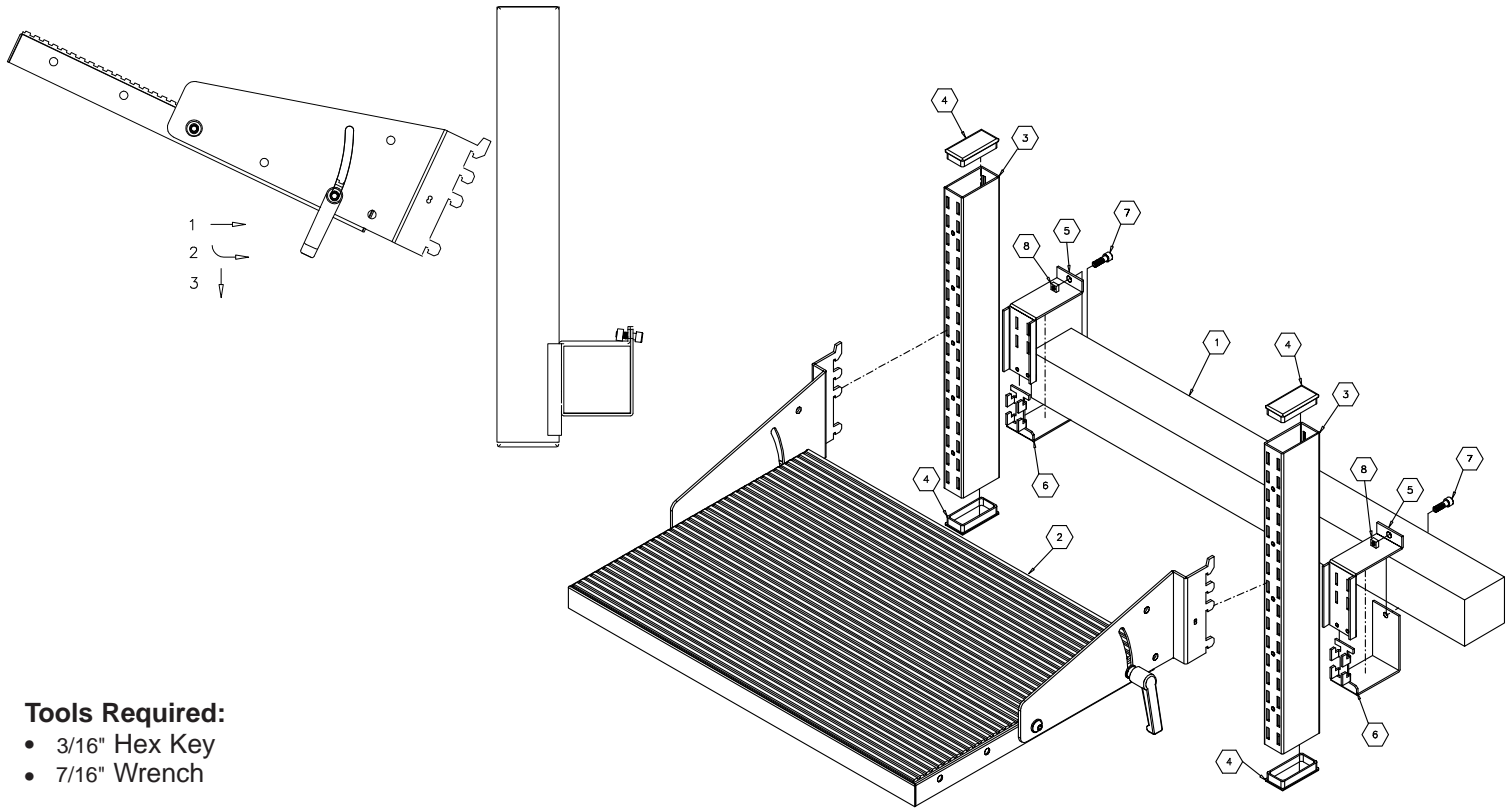

Tools Required:

- 3/16" Hex Key
- 7/16" Wrench

Item	Description	Qty.
1	Align Workbench Horizontal Rail	1
2	Variable Angle Shelf	1
3	Post	2
4	Black Plastic Plug 30 mm x 60 mm	4
5	Top Bracket	2
6	Bottom Bracket	2
7	Socket Head Cap Screw 1/4-20 x 3/4"	2
8	Square Nut 1/4-20	2

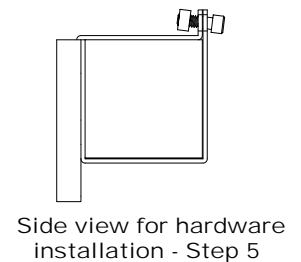

Step:

1. Assemble Variable Angle Shelf (item 2) per instructions located on page 30
Mat is to be installed such that the "ribs" face upwards
2. Insert (4) Plastic Plugs (item 4) into the ends of each Post (item 3)
3. Install (1) Bottom Bracket (item 6) around the bottom of the Workbench Horizontal Rail (item 1) as shown
4. Install (1) Top Bracket (item 5) around the top of the Workbench Horizontal Rail as shown
The tabs of Bottom Bracket should be inserted through the slots in Top Bracket.
5. Loosely secure the Top and Bottom Brackets together using (1) 1/4-20 Socket Head Cap Screw (item 7) and (1) 1/4-20 Square nut (item 8) - the screw/nut combination will tilt at a slight angle when installed
6. Repeat steps 3 through 5 with the other Top and Bottom Bracket set
7. Space brackets 24" apart on center
8. Hook the slots of (2) Posts onto the tabs of the Bottom Brackets at the desired height
A mallet and block of wood may be required to tap & secure the Post onto the Bracket tabs
9. Insert top tabs of the Variable Angle Shelf mounting brackets into the inside slots on Posts at the desired height
10. Rotate shelf down while inserting the bottom tabs fully into slots on Posts, press down to secure in place
11. After all components are installed properly, fully tighten the Bracket screw/nut combination from step 5 above

FREE STANDING FOOTREST INSTALLATION

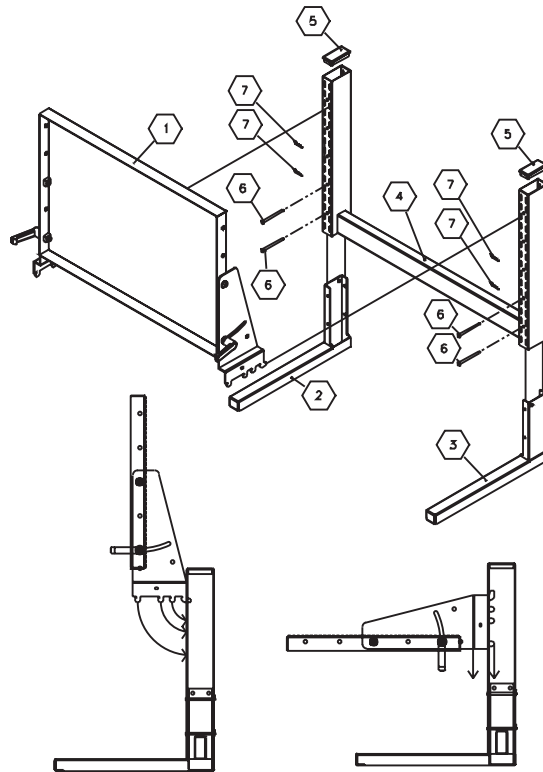

Tools Required:

- No tools necessary

Item	Description	Qty.
1	Variable Angle Shelf	1
2	Foot Weldment (Left)	1
3	Foot Weldment (Right)	1
4	Frame Weldment	1
5	Black Plastic Plug 30 mm x 60 mm	2
6	Clevis Pin $\frac{3}{16}$ x 2 $\frac{1}{2}$	4
7	Cotter Hairpin	4

Step:

1. Assemble variable angle shelf (item 1) following Variable Angle Shelf Assembly Instructions, page 30, with ribbed mat facing upwards.
2. Insert (2) plastic plugs (item 5) into the top ends of each post on frame weldment (item 4).
3. Insert left and right foot weldments (items 2 & 3) into bottom of posts on frame weldment.
4. Insert (4) clevis pins (item 6) through holes in post and leg weldment.
5. Insert (4) cotter hairpins (item 7) into holes in clevis pins.
6. Insert tabs of mounting brackets on variable angle shelf into inside slots on posts at height desired.
7. Rotate down inserting bottom tabs fully into slots on posts.
8. Press down to secure in place.

NEXUS™ is a trademark of Lista International Corporation.
Making Workspace Work™ is a trademark of Lista International Corporation.

Document Number: MD034A3 Rev. 2

Print Date: May 2009

This manual is proprietary information of Lista International Corporation. Unauthorized reproduction of any portion of this manual is prohibited without the written consent of Lista International Corporation. The material in this manual is for informational purposes only. It is subject to change without notice.

© 2005 by Lista International Corporation
106 Lowland Street
Holliston, MA 01746-2094

All rights reserved

