



# Arlink 8000 Accessories

## Instructions for Assembly

Variable Angle Shelves  
Powerbeams & Lights  
Panels  
Keyboard Holders  
Swing Arm Accessories  
Parts Bin Rails  
Mobile Carts

Making Workspace Work® is a trademark of Lista International Corporation.

Creation Date	Document Number	Rev	Description
May/25/07	AS80039	A	Arlink 8000 Accessories

This manual is proprietary information of Lista International Corporation. Unauthorized reproduction of any portion of the manual is prohibited without consent of Lista International Corporation. The material in this manual is for informational purposes only. It is subject to change without notice. Lista International Corporation assumes no responsibility for any typographical errors contained in the manual.

© 2007 by Lista International Corporation, all rights reserved.  
106 Lowland Street  
Holliston, MA 01746-2094  
E-mail: sales@listaintl.com

All rights reserved.

For questions or technical support, call 1-800-722-3020  
ISO 9001 Certified

# Table of Contents

Variable Angle Shelf .....	3	Universal Brackets .....	11
Free Standing Footrest .....	4	Monitor Shelf with Keyboard Holder and Mouse Tray .....	12
Vertical Powerbeam.....	5	Accessory Shelf.....	13
Light Fixture: 4 Bulb.....	6	Document Holders.....	14
Peg Board & Louvered Panel .....	7	Parts Bin Rack for Swing Arm .....	15
Marker/Tack Panel.....	8	Heavy Duty Parts Bin Rail .....	16
Pullout Keyboard Holder.....	9	Mobile Carts .....	17
Swivel Keyboard Holder .....	10	Parts Bin Cart .....	18

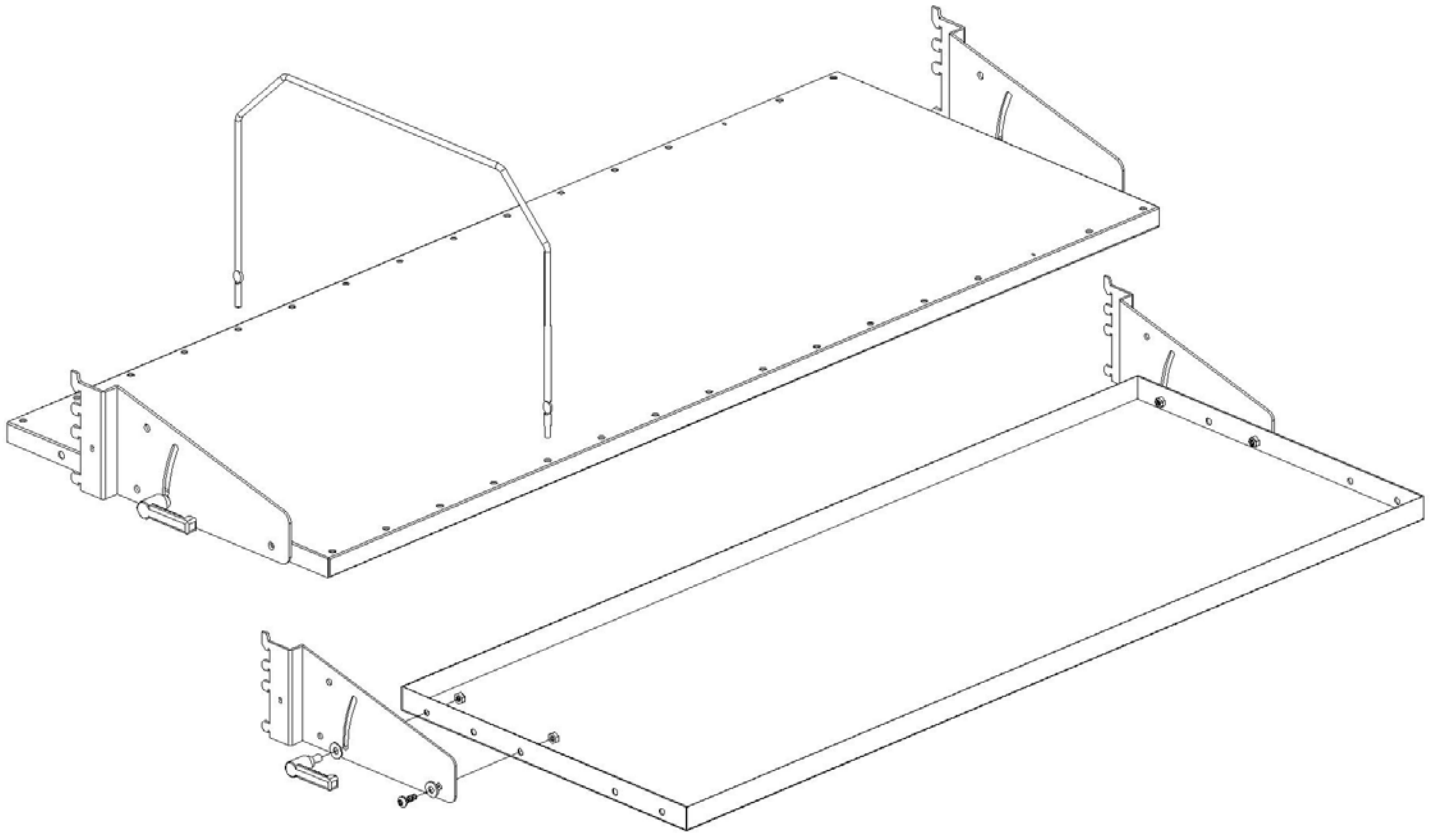

### **Variable Angle Shelf Assembly — AS80032**

These shelves can mount in three different orientations relative to the columns.

- 1) Front Mount. To mount the shelf in front of the columns you must mount the brackets to the shelf in their rear most position.
- 2) Center Mount. To Mount the shelf in the center of the columns you must mount the brackets in their central position.
- 3) Rear Mount. To mount the shelf in its rear most position you must mount the brackets in their front most position.

To mount the brackets use the 5/16"-18 x 5/8" button head cap screws, flat washers and lock nuts provided. The adjustable levers provided are used to adjust the angle of the shelf. They are also installed with washers and lock nuts.

The Variable Angle Shelves without Lips have mounting positions for the wire divider as shown above. The dividers are installed by pushing them into both sets of mounting holes at the desired location.

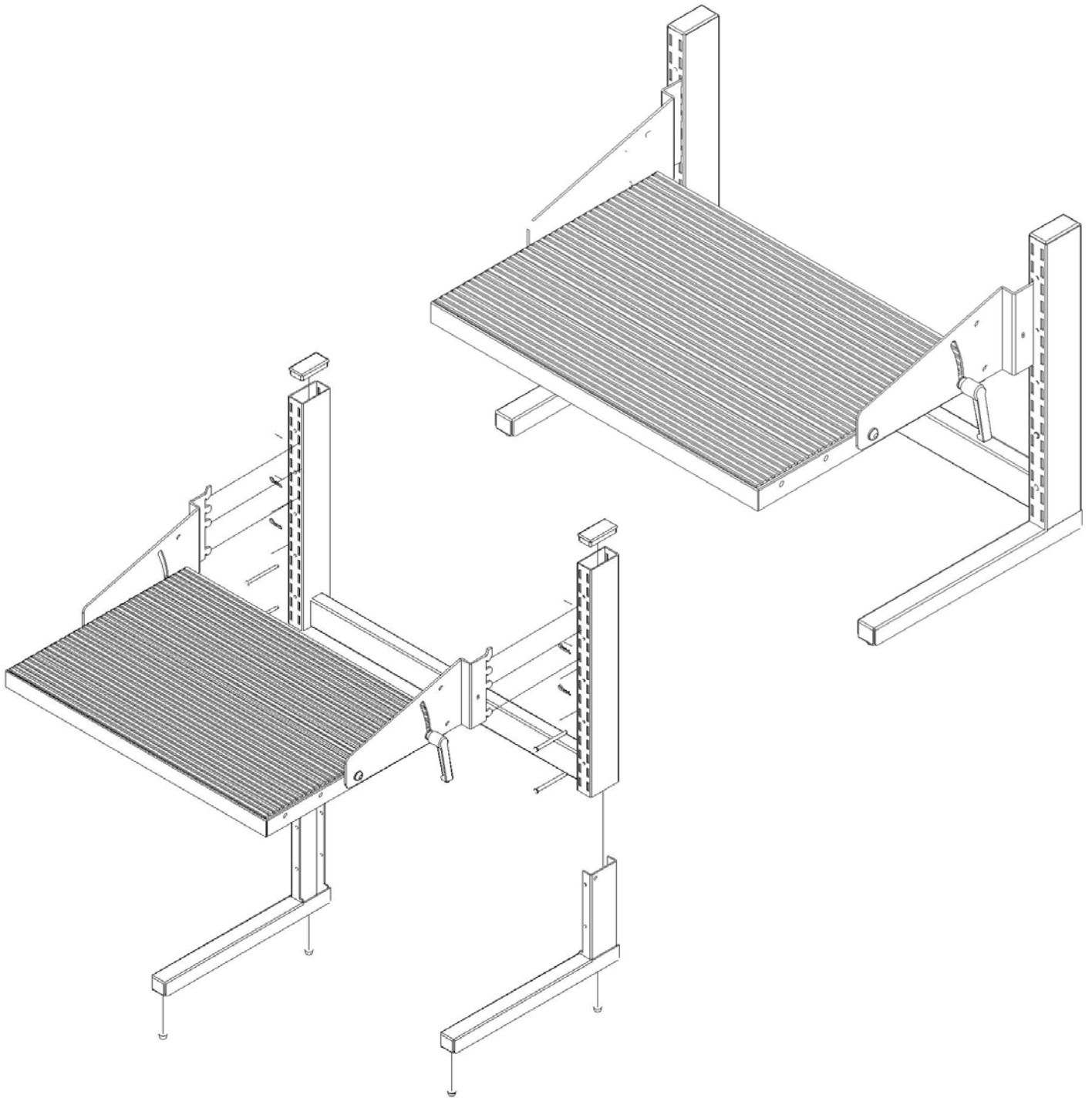

### **Freestanding Footrest Assembly — AS80033**

- 1) See Variable Angle Shelf Assembly for footrest platform assembly, page 3.
- 2) Insert the two plastic plugs into the top of the frame posts.
- 3) Insert left and right feet into the bottom of the frame assembly. Install the clevis pins and retainers provided.
- 4) Mount the Variable Angle Shelf Assembly to the Frame Assembly at the desired height and angle.
- 5) Press down to engage slots.

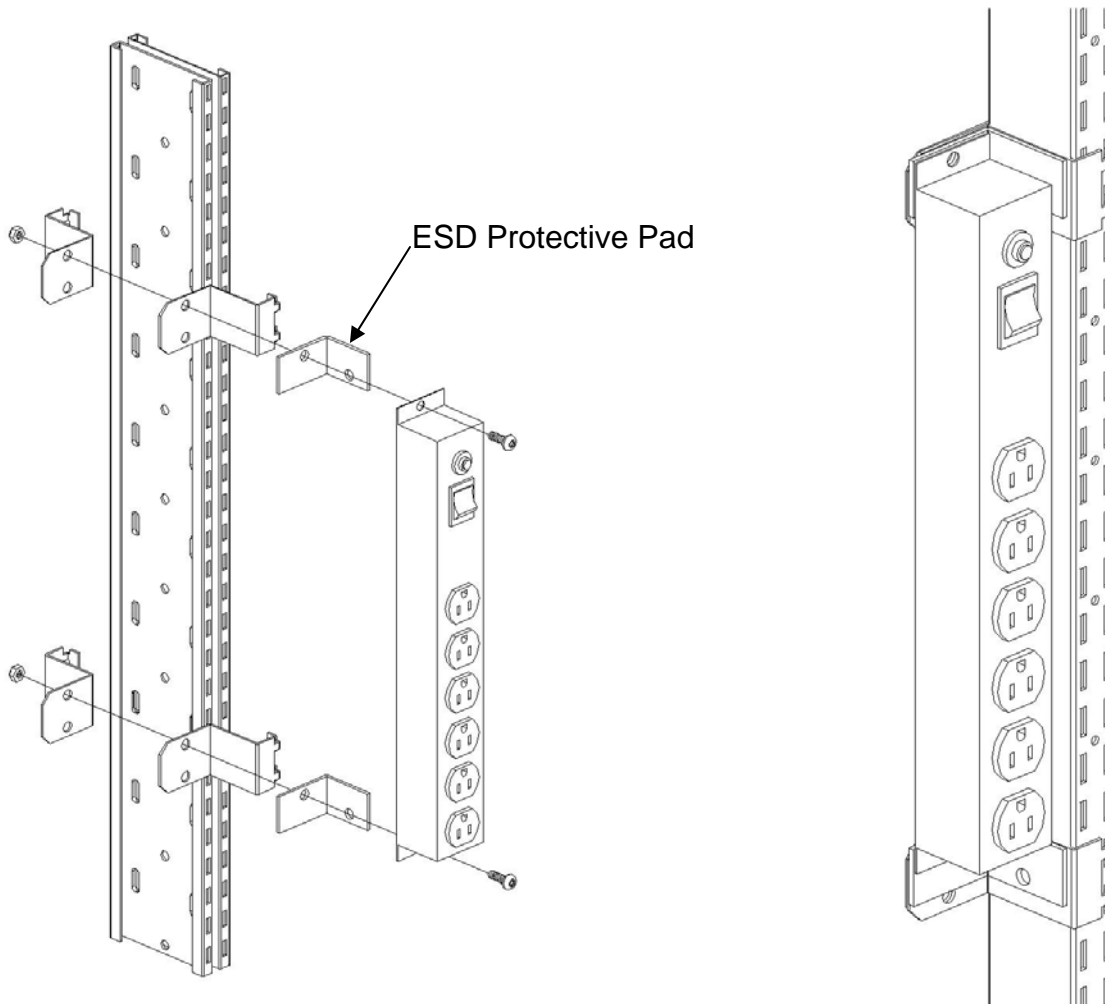

### Vertical Powerbeam Assembly — AS80031

- 1) Mount the top front and top rear bracket into the micro slots at the desired height. Press down on the brackets to ensure they engage the slots.
- 2) Loosely bolt the powerbeam through the top hole of the brackets using the 5/16"-18 x 5/8" button head cap screw and hex nut provided. **Please note:** Where ESD safety is a concern, sandwich the ESD protective pad between the front bracket and the powerbeam. **See warning on the back cover.**
- 3) Mount the bottom front bracket and the bottom rear bracket into the micro slots at the appropriate height. Push up on the brackets to engage the slots.
- 4) Bolt through the bottom hole of the brackets using the 5/16"-18 x 5/8" button head cap screw and hex nut provided.
- 5) Ensure all hardware is secured.

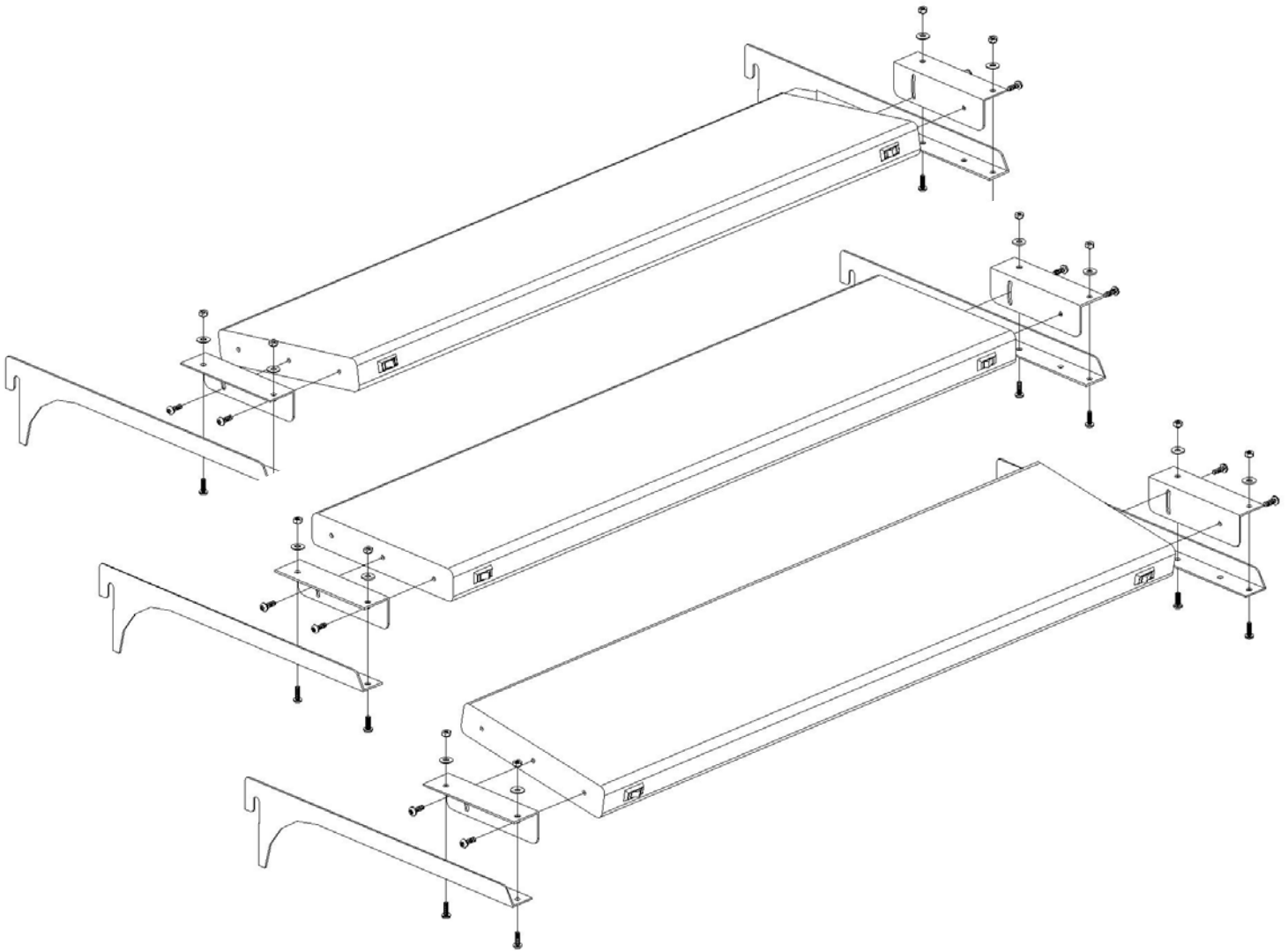

### **Light Fixture: 4 Bulb Assembly — AS80038**

- 1) Using the four #10-24 x 3/4" machine screws provided mount the retro fit brackets to the light fixture.
- 2) These brackets can be mounted either in the front or rear most position of the light fixture and the slot which allows the light to be tilted can be mounted towards either the front or the back of the light.
- 3) Now mount the sub assembly to the light brackets. These brackets will have an overall dimension of either 15 5/8", 20 5/8" or 26 5/8" depending on what you purchased.
- 4) Using the four 1/4"-20 x 3/4" machine screws, washers and lock nuts provided mount the sub assembly as shown above.
- 5) Ensure all hardware is secure and mount the assembly to your workstation using the macro slots of the columns.

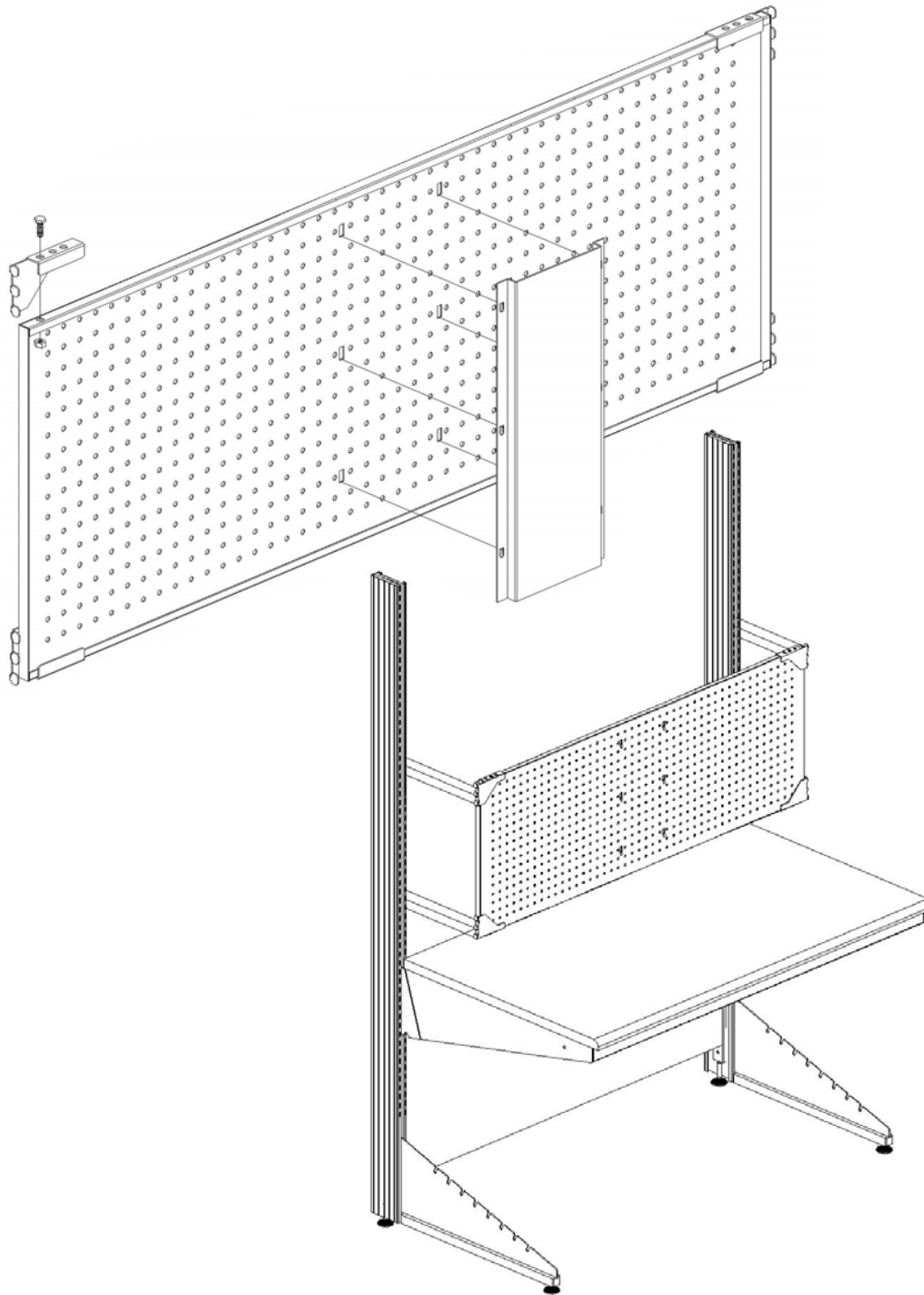

### **Pegboard and Louvered Panel Assembly — AS80027**

- 1) Fasten the four support brackets to the corners of the panel using the four 5/16"-18 x 5/8 cap screws and hex nuts provided. Do not tighten the screws.
- 2) Inset tabs of the stiffener into the rear slots of the panel. Press down to secure in place.
- 3) Insert hooks of the support brackets into the inner micro slots of the column at the desired height.
- 4) Secure all hardware.

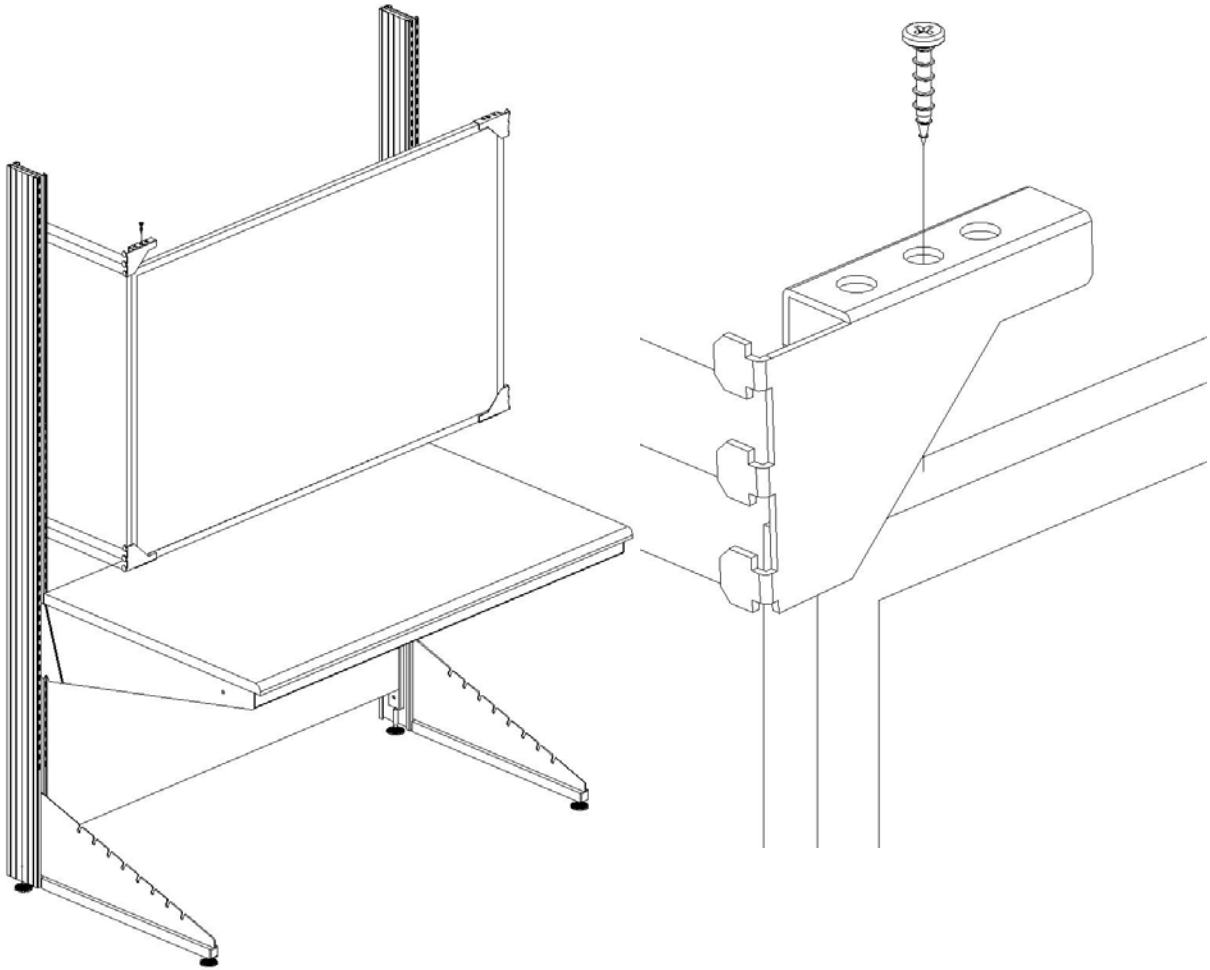

### **Marker/Tack Panel Assembly — AS80037**

- 1) Mount the bottom two support brackets into the inner micro slots of the columns.
- 2) Center the panel between these two bracket and mark the mounting locations.
- 3) Using the self drilling screws provided mount the brackets to the panel.
- 4) Repeat steps 1-3 for the top brackets.

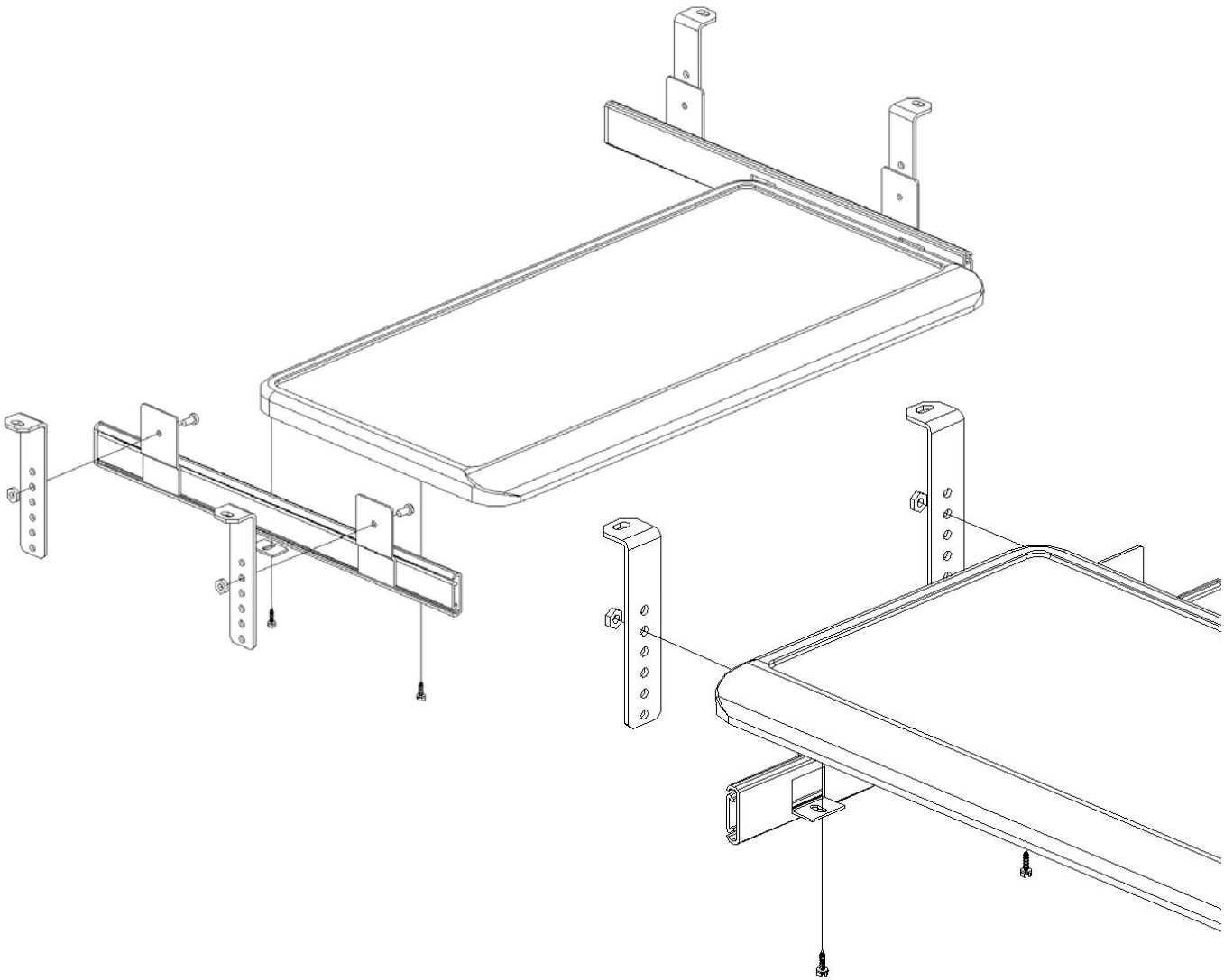

### **Pullout Keyboard Holder Assembly — AS80004**

- 1) Position keyboard slides so that the mounting tabs are towards the front of the keyboard tray.
- 2) Mount the keyboard tray to the slides using the #6-3/8" self tapping screws.
- 3) Mount the four height adjustable brackets to the slides at the desired height using the M4 x 6 machine screws provided.
- 4) Position the keyboard holder assembly under the worksurface, between the load beams, and as close to the front of the worksurface as possible.
- 5) Using the #10 x 3/4" wood screws mount the assembly to the worksurface.

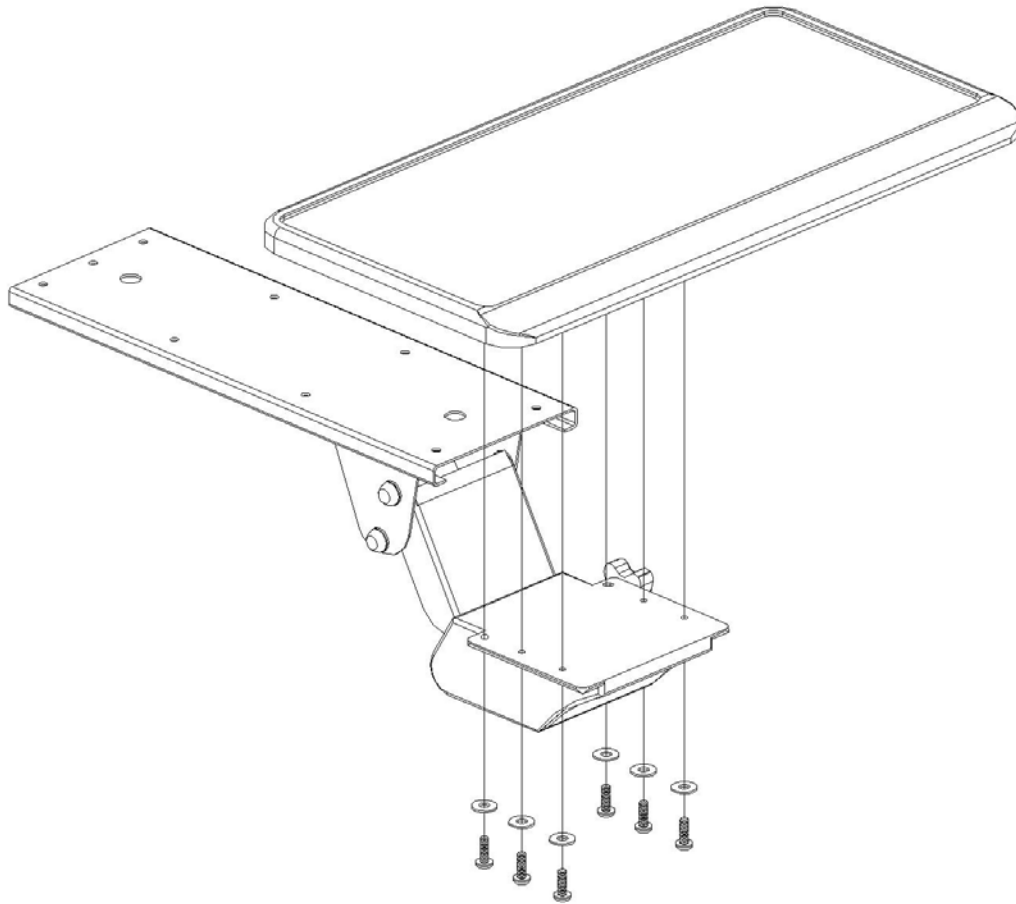

### **Swivel Keyboard Holder Assembly — AS80007**

- 1) Mount the keyboard tray to the swivel mechanism using the six #10-24 x 1/2" machine screws and washers.
- 2) Mount the mechanism and tray assembly to the worksurface using the #10 x 1" wood screws. In order to access some of the mounting positions you will need to move the mechanism back and forth on the slide.

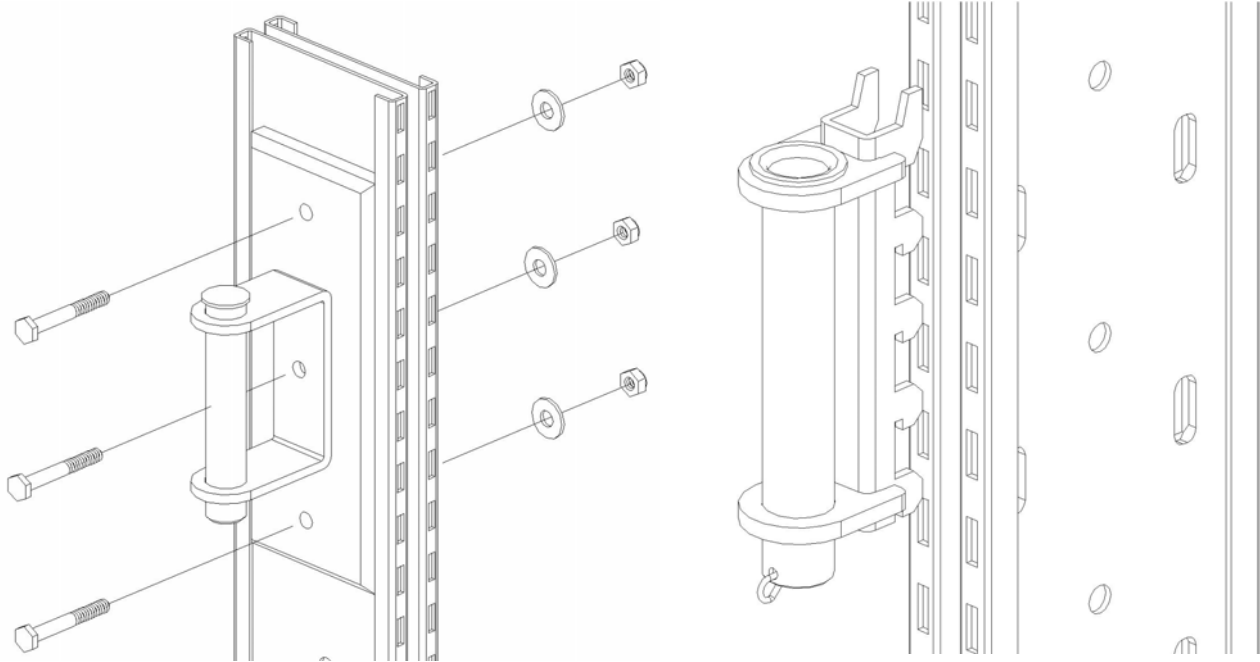

### **Universal Bracket Assembly — AS80003**

#### **8423 Heavy Duty Universal Bracket**

- 1) Position the bracket at the desired height on either the inside or outside of the column.
- 2) Mount the bracket using the three 1/4"-20 x 1 3/8" hex bolts, washers and lock nuts provided.

#### **8406 Double Hook Micro Slot Bracket**

- 1) At the desired height mount the double hooked bracket into the inner and outer micro slots.

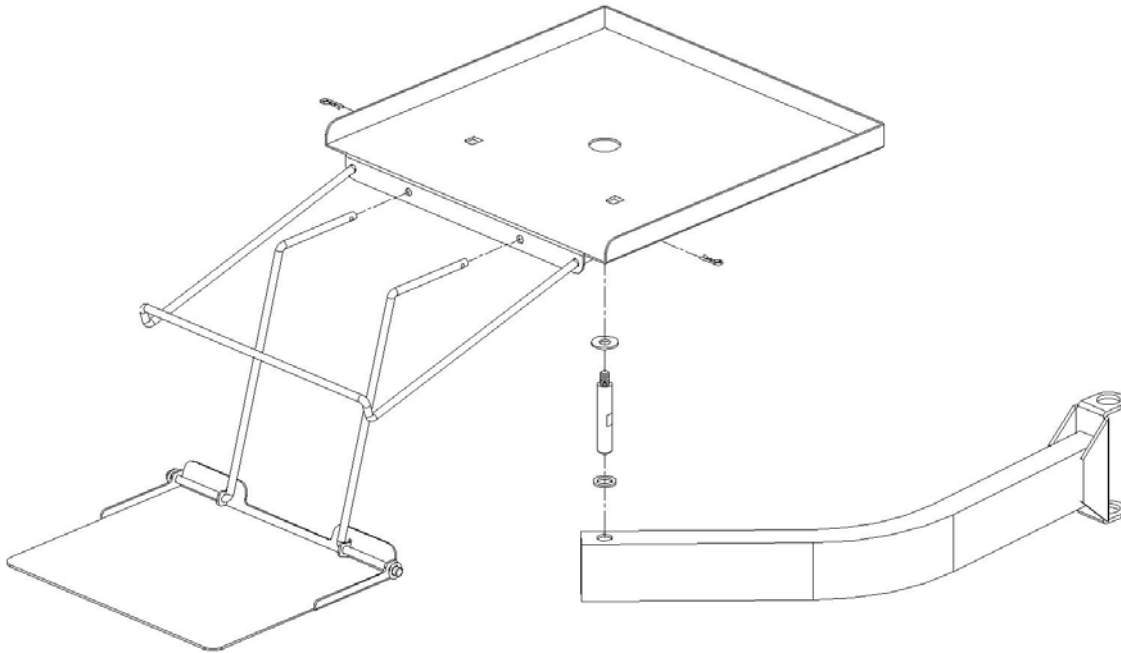

### **Monitor Shelf with Keyboard Holder & Mouse Tray Assembly — AS80018**

- 1) Mount the accessory pin and steel washer to the monitor shelf.
- 2) Mount the assembly and the plastic washer to the swing arm.
- 3) The swing arm then mounts to either the 8406 or 8423 universal brackets using the pin supplied.
- 4) Insert the ends of the mouse tray through both sets of holes in the monitor shelf.
- 5) Insert the two retainer pins.

Please note: 8895 Mouse tray is ordered separately.

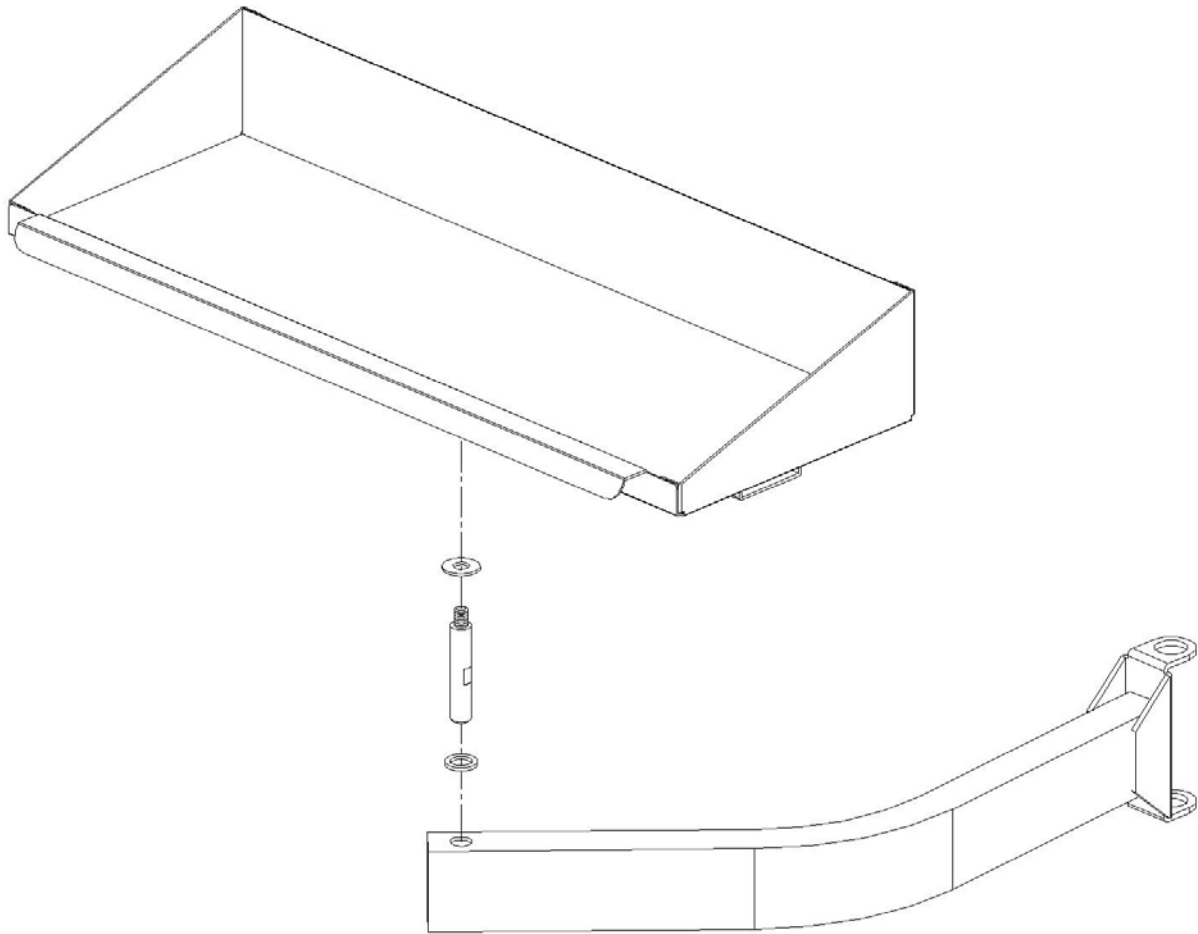

### **Accessory Shelf Assembly — AS80029**

- 1) Mount the accessory pin and steel washer to the accessory shelf.
- 2) Mount the assembly and the plastic washer to the swing arm.
- 3) The swing arm then mounts to either the 8406 or 8423 universal brackets using the pin provided.

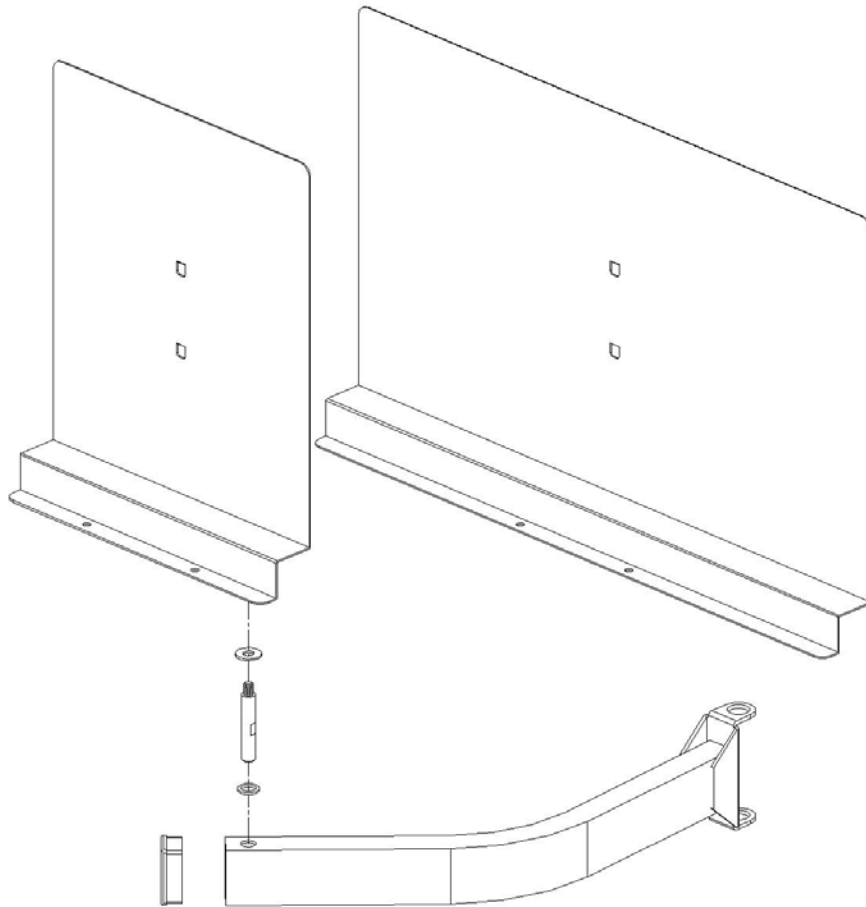

### **Document Holder Assembly — AS80035**

- 1) Mount the accessory pin and steel washer to either the 11 7/8" or 23 5/8" document holders.
- 2) Mount the assembly and the plastic washer to the swing arm.
- 3) The swing arm then mounts to either the 8406 or 8423 universal brackets using the pin provided.
- 4) The angle of the document holders can be adjusted from 0° to 90° in 15° increments.

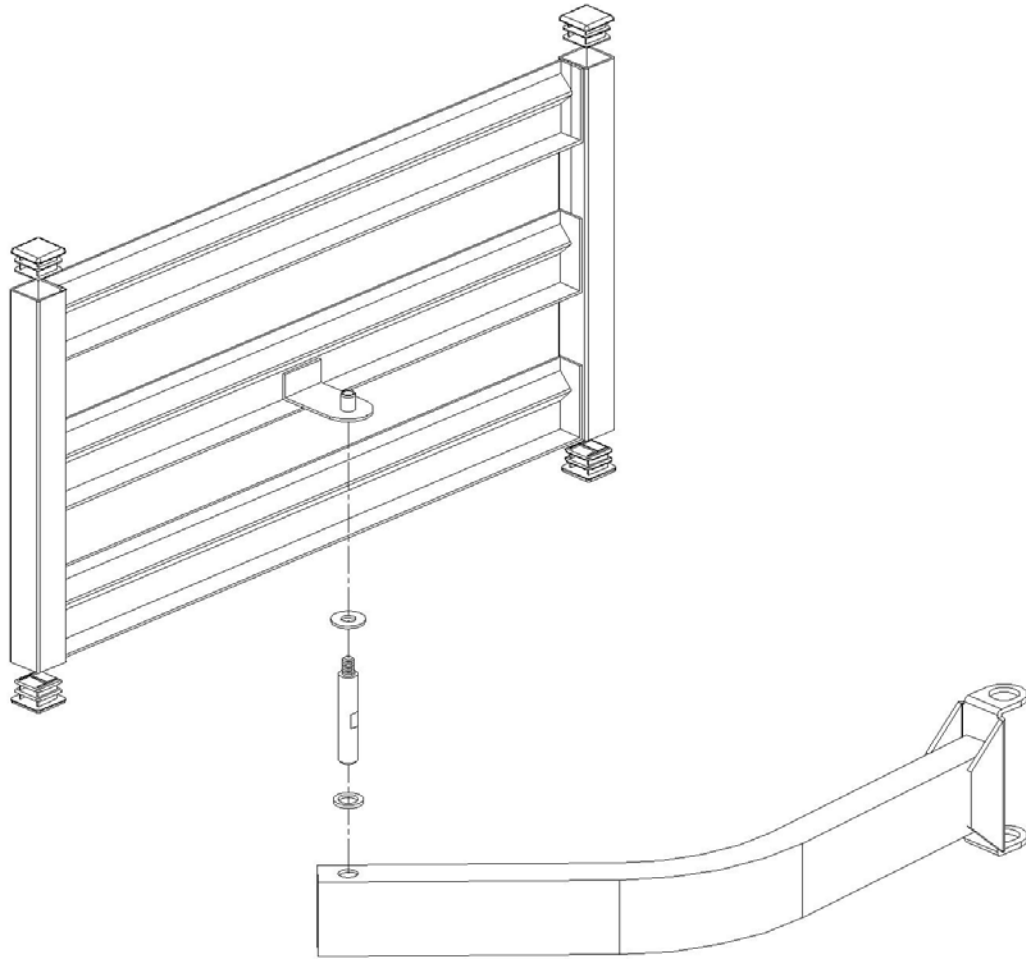

### **Parts Bin Rack for Swing Arm Assembly — AS80039**

- 1) Insert the four plastic caps into the parts bin rack tubes.
- 2) Mount the accessory pin and steel washer to the parts bin rack.
- 3) Mount the assembly and the plastic washer to the swing arm.
- 4) The swing arm then mounts to either the 8406 or 8423 universal brackets using the pin supplied.

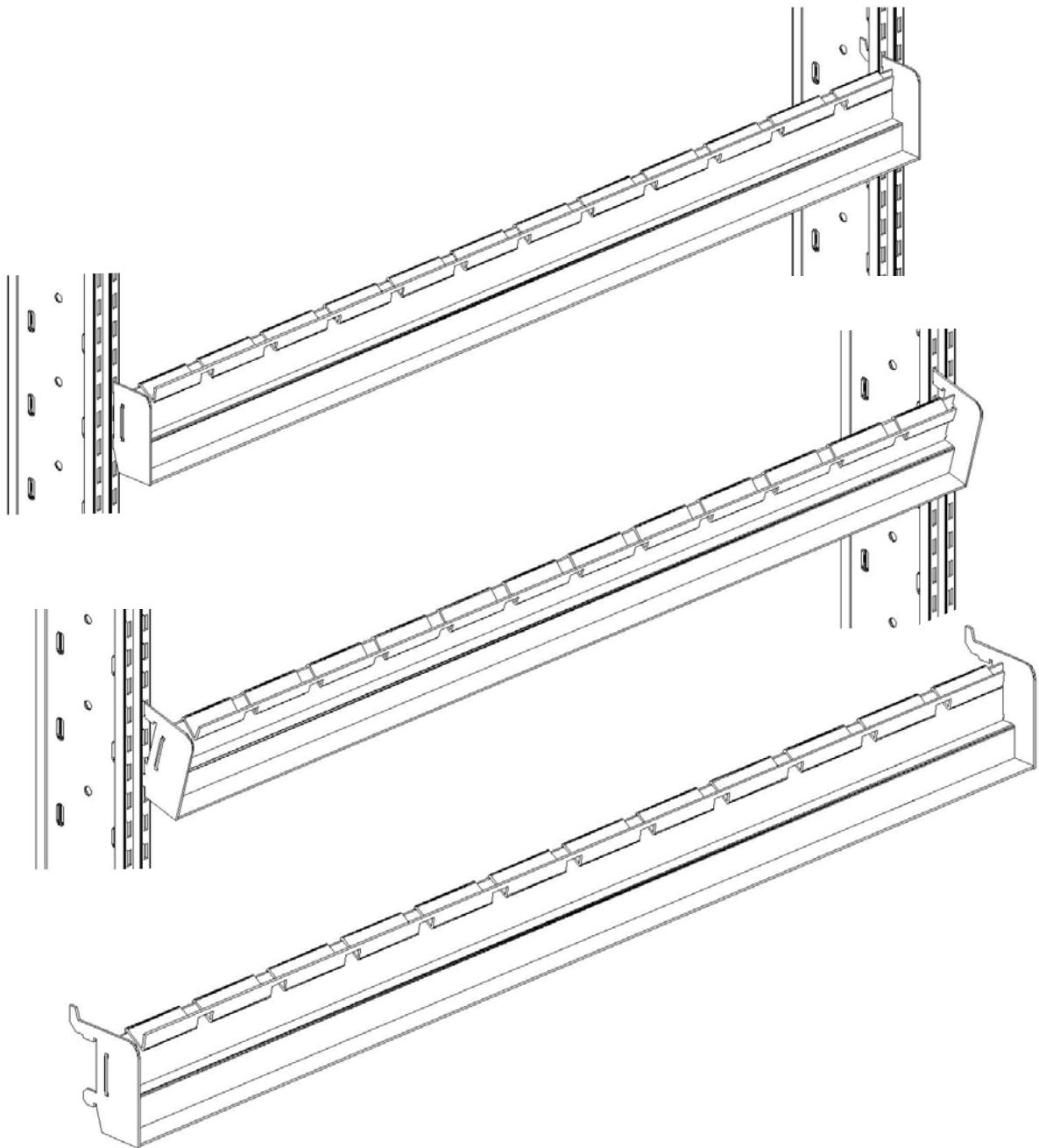

### **Heavy Duty Parts Bin Rail Assembly — AS80040**

#### Installation at 90°

- 1) Insert the top hooks into the inner micro slots of the columns.
- 2) Rotate the parts bin rail down until you engage the bottom hooks.
- 3) Press down firmly to fully engage the hooks.

#### Installation at 15°

- 1) Push up on the rail to disengage the hooks and pull the top of the rail forward until the up hook catches in the column and you can not pull any farther forward.
- 2) Press down on the rail to fully engage the hooks.

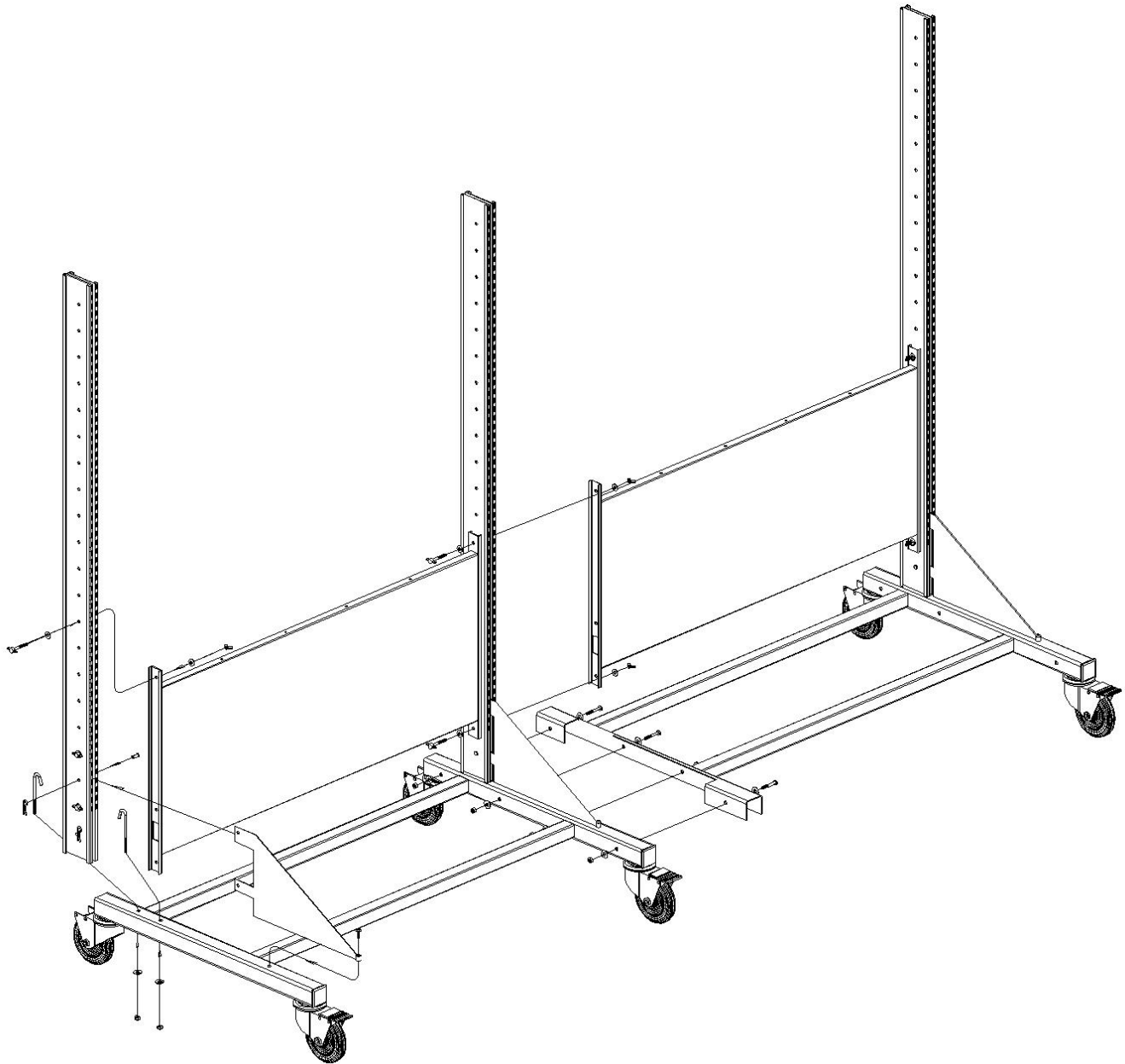

### **Mobile Cart Starter & Adder Assembly — AS75001**

Note: Leave all fasteners loose until after stabilizer panel is installed.

- 1) Mount the starter and adder bases together using the four 5/16"-18 x 3" hex head screws, washers and lock nuts provided.
- 2) Place the "J" bolts into the columns. Then guide the "J" bolts through the holes in the base and install the 5/16" washers, and lock nuts.
- 3) Mount the outriggers to the columns using the clevis pins and retainers provided.
- 4) Secure the front of the outrigger to the base using a 1/4"-20 x 1" screw.
- 5) Mount the stabilizer panel between the columns using the six 1/4"-20 x 2" "T" bolts, washers and wing nuts.

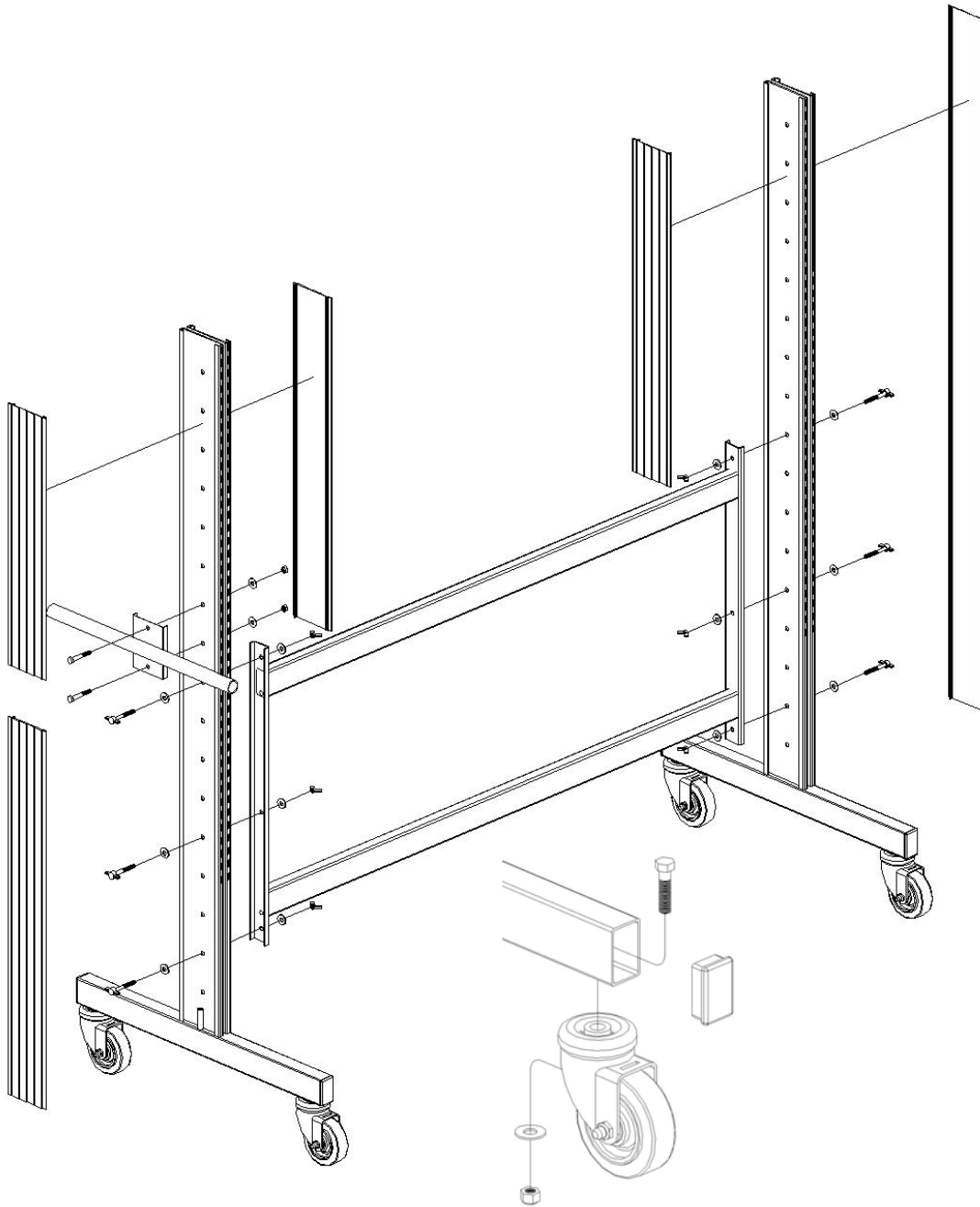

### Parts Bin Cart Assembly — AS75002

- 1) Mount the stabilizer panel between the columns using the six 1/4"-20 x 2" "T" bolts, washers and wing nuts.
- 2) Mount the parts bin cart handle to either side of the cart using the two 1/4"-20 x 3/4" screws, washer and lock nuts provided.
- 3) Mount the casters to the feet using the 3/8"-16 x 1 1/2" hex bolts, washers and lock nuts provided.
- 4) Insert the plastic plugs into the foot tubes.

Double sided cart shown. Single sided cart is assembled in the same manner. The single sided handle is different but is installed in the same manner as above.

Document Number: AS80039

Print Date: May, 2007

This manual is proprietary information of Lista International Corporation. Unauthorized reproduction of any portion of this manual is prohibited without written consent of Lista International Corporation. The material in this manual is for informational purposes only. It is subject to change without notice. Lista International Corporation assumes no responsibility for any typographical errors contained in this manual.

©2007 by Lista International Corporation  
106 Lowland Street  
Holliston, MA 01746-2095

All rights reserved.

**\*\*\*Warning!**

***Failure to comply with the proper installation of insulating grommets or gaskets may result in hazardous electrical conditions for personnel. The ultimate responsibility for personnel safety lies with the end user.***



**Lista International Corporation**  
106 Lowland Street  
Holliston, MA 01746 USA  
Telephone: (800) 722-3020  
Fax: (508) 626-0353  
sales@listaintl.com  
www.listaintl.com