

The packing benches shown on the following two pages are pre-configured to include the most popular and versatile styles of packing benches we offer. To design a custom bench to suit your exact needs, see pages 88-89.

Easy-Order packing benches include technical panel legs, and are 33 1/2" high. Optional Nexus System packing bench combinations are 48" high.

How to order an Easy-Order Packing Bench

1. **Select Easy-Order packing bench configuration.**
2. **Select worksurface style.**
LTS = Lista Top
GLS = Galvanized steel
BTS = Butcher block
 All worksurfaces have a standard square edge and are 30" deep.
3. **Select worksurface size.**
4830 = 48" long x 30" deep
6030 = 60" long x 30" deep
7230 = 72" long x 30" deep
4. **Select paint color.** For color chart, see back cover.

How to order an optional Easy-Order Nexus System Packing Bench Combination

1. **Select Easy-Order Nexus System configuration.**
2. **Select system length** (length must correspond to worksurface length as shown below).
42 = for 48" long worksurface
48 = for 60" long worksurface
60 = for 72" long worksurface
4. **Select paint color.** For color chart, see back cover.

EXAMPLE: to order a PS6200 packing bench with a 72" long butcher block worksurface and a matching Nexus System combination with Bright Blue paint, the bench part number would be **PS6200-BTS7230BB**, and the Nexus System part number would be **NXC/SM48-PB01-60BB**.

Single Bay Packing Benches

FRONT VIEW

SIDE VIEW

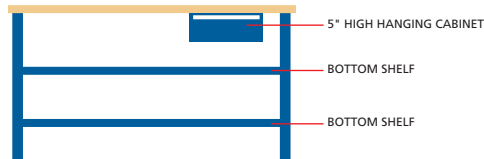

PART NO.	INCLUDES
PS6000- <input type="checkbox"/> <input type="checkbox"/> <input type="checkbox"/>	WBHC150-1 hanging cabinet

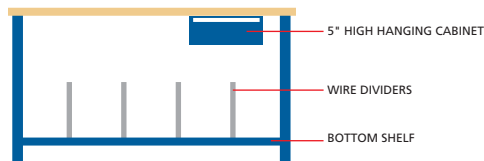

PART NO.	INCLUDES
PS6100- <input type="checkbox"/> <input type="checkbox"/> <input type="checkbox"/>	WBHC150-1 hanging cabinet

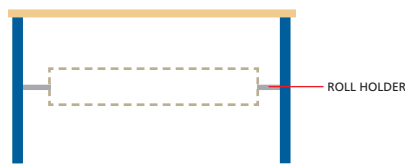

PART NO.	INCLUDES
PS6200- <input type="checkbox"/> <input type="checkbox"/> <input type="checkbox"/>	

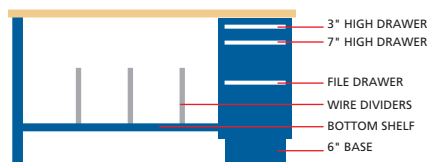

PART NO.	INCLUDES
PS6300- <input type="checkbox"/> <input type="checkbox"/> <input type="checkbox"/>	NW0600-0303N-F6RG cabinet

Optional Nexus System Packing Bench Combination

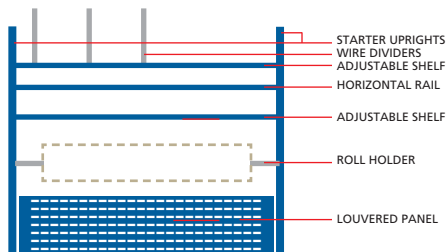

PART NO.	HEIGHT
NXC/SM48-PB01- <input type="checkbox"/> <input type="checkbox"/>	48"

Long Packing Benches

FRONT VIEW

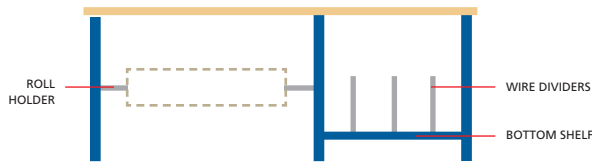

SIDE VIEW

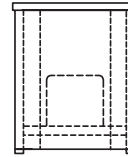

PART NO.	ROLL HOLDER LENGTH	BOTTOM SHELF LENGTH
PS6400- <input type="checkbox"/> <input type="checkbox"/>	72" top: 36" long; 84" & 96" top: 48" long	72" & 84" top: 24 1/4" long; 96" top: 36 1/4" long

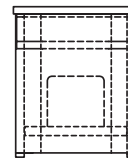

PART NO.	INCLUDES	BOTTOM SHELF LENGTH
PS6500- <input type="checkbox"/> <input type="checkbox"/>	WBHC150-1 hanging cabinet	all shelves are equal length

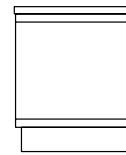

PART NO.	INCLUDES
PS6600- <input type="checkbox"/> <input type="checkbox"/>	NW0600-0303N-F6RG cabinet

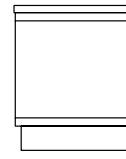
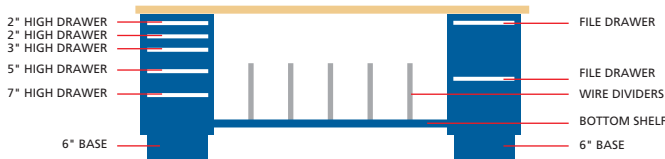

PART NO.	INCLUDES
PS6700- <input type="checkbox"/> <input type="checkbox"/>	NW0600-0501N-F6RG and NW0600-0201N-F6RG cabinets

Optional Nexus System Packing Bench Combination

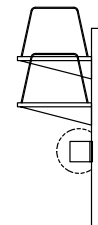
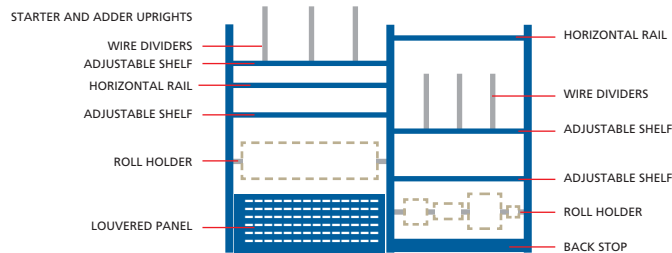

PART NO.	HEIGHT	STARTER SECTION WIDTH	ADDER SECTION WIDTHS
NXC/SM48-PB02- <input type="checkbox"/>	48"	42"	24" for 72" worksurface, 36" for 84" worksurface, 48" for 96" worksurface

How to order a long Easy-Order Packing Bench

1. Select Easy-Order packing bench configuration.

2. Select worksurface style.

LTS = Lista Top
GLS = Galvanized steel
BTS = Butcher block

All worksurfaces have a standard square edge and are 30" deep.

3. Select worksurface size.

7230 = 72" long x 30" deep
8430 = 84" long x 30" deep
9630 = 96" long x 30" deep

4. Select paint color. For color chart, see back cover.

How to order an optional Easy-Order Nexus System Packing Bench Combination

1. Select Easy-Order Nexus System configuration.

2. Select system length (length must correspond to work surface length as shown below).

66 = for 72" long worksurface
78 = for 84" long worksurface
90 = for 96" long worksurface

4. Select paint color. For color chart, see back cover.

EXAMPLE: to order a PS6600 packing bench with an 84" long butcher block worksurface and a matching Nexus System combination with Bright Blue paint, the bench part number would be **PS6600-BTS8430BB**, and the Nexus System part number would be **NXC/SM48-PB02-78BB**.